



Nabiac, 14 Candoormakh Creek Road COUNTRY COTTAGE

An opportunity awaits for a first home buyer or investor to grab a well-price property.

An original, cute cottage on expansive gardens awaits the keen buyer.

3 bedrooms with large outdoor deck area looking out over a large backyard, which is fully-fenced.

A recently renovated bathroom is a feature, as is the proximity to Nabiac Village.

Huge scope to make a difference for a keep couple or handy renovator.

Best pricing for the region.

Contact Steve Atkins on 0488 788 169 for a private inspection.



Disclaimer: All information contained therein is gathered from relevant third parties sources. We cannot guarantee or give any warranty about the information provided. Interested parties must rely solely on their own enquiries.

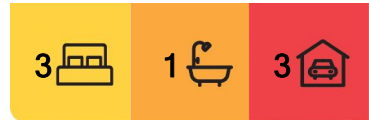

For Sale
\$620,000

View
ljhooker.com.au/1EHCF5Y

Contact
Steve Atkins
0488 788 169
steve.atkins@ljhforster.com.au

LJ Hooker Forster | Tuncurry
(02) 6591 6400

Disclaimer: All information contained herein is gathered from relevant third party sources. We cannot guarantee or give any warranty about the information provided. Interested parties must rely solely on their own enquiries.

More About this Property

Property ID	1EHCF5Y
Property Type	House
Land Area	1012 m2
Including	Toilets (2) Fire Place Courtyard Deck Dishwasher Outdoor Entertaining

Steve Attkins 0488 788 169

Principal | steve.attkins@ljhforster.com.au

LJ Hooker Forster | Tuncurry (02) 6591 6400

3/41 Kularoo Drive, FORSTER NSW 2428

forster.ljhooker.com.au | realestate@ljhforster.com.au



**LJ Hooker Forster | Tuncurry
(02) 6591 6400**

Disclaimer: All information contained therein is gathered from relevant third parties sources. We cannot guarantee or give any warranty about the information provided. Interested parties must rely solely on their own enquiries.

- 
 3
- 
 2
- 
 2

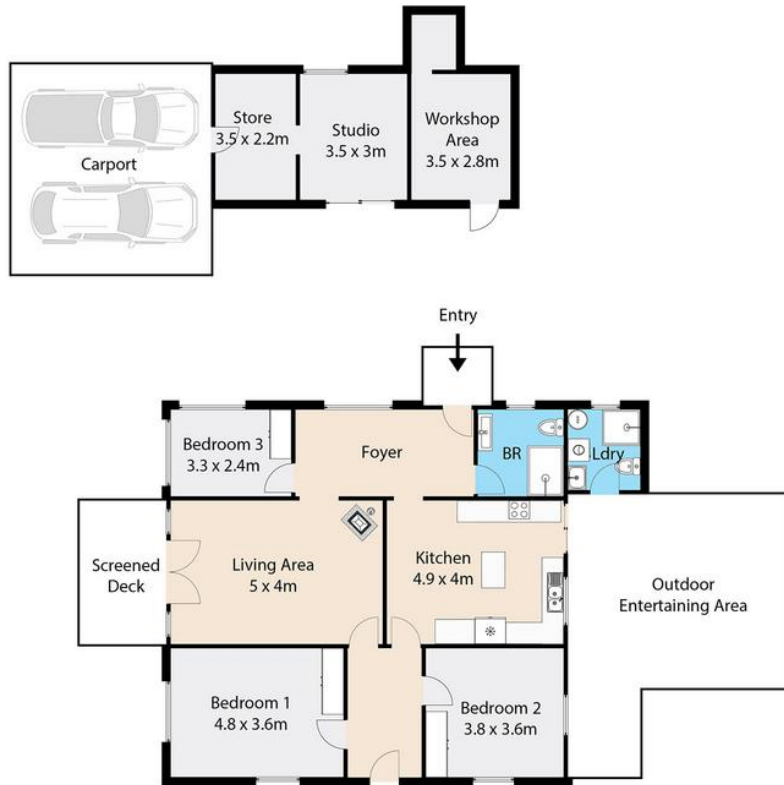

14 Candoormakh Creek Road,
Nabiac, NSW 2312

Internal floor area: 140 m²
Land area: 1012 m²



Plans and dimensions are made as accurately as possible, however these are to be used as a guide and slight variations may be possible.