



## Mount Nathan, 15-17 Kingsmead Court

### SPACIOUS ACREAGE LIVING HOME WITH SHED ON A 5,325m<sup>2</sup> BLOCK

Discover this beautifully refreshed home nestled on over 1.3 acres at the end of a quiet cul-de-sac in charming Nathan Forest. Enjoy breathtaking valley and forest views perfect if you have a horse or animals, offering the perfect blend of country living and convenience.

#### Key Features:

- The master bedroom boasts a walk-in robe and ensuite with rain head shower
- 3 more bedrooms with built-ins & Fans
- Main bathroom with bath and rain head shower, plus separate laundry with storage
- Open-plan design with generous living areas, separate family room and large lounge room
- A large, updated kitchen equipped with a dishwasher, near new oven, with separate grill and cooktop-perfect for family gatherings and entertaining.
- Ducted air conditioning throughout for year-round comfort.
- A large undercover entertainment area, ideal for alfresco dining and relaxation. Perfect



**Disclaimer:** All information contained therein is gathered from relevant third parties sources. We cannot guarantee or give any warranty about the information provided. Interested parties must rely solely on their own enquiries.

4

2

4

**For Sale**  
Contact Agent

**View**  
[ljhooker.com.au/5G5TF41](https://l.jhooker.com.au/5G5TF41)

**Contact**  
**Julie Morgan-Kemp**  
0409 691 416  
[julie@ljhgc.com.au](mailto:julie@ljhgc.com.au)

**LJ Hooker Nerang**  
**(07) 5581 4422**



yard for kids and dogs fully fenced.  
 Solar power with approx. 30 panels  
 Auto double lock-up garage with internal access, and  
 Separate driveway to a powered 2-bay shed approx. (9 x 6m).  
 Additionally, a garden shed (3 x 3m) provides extra storage options.  
 Fully fenced and private yard on a spacious 5,325m<sup>2</sup>, surrounded by lovely established gardens.  
 Plenty of room for secure off-street parking for boats, caravans, and more.  
 This home offers a rare opportunity to enjoy tranquil living with modern amenities in a picturesque setting. Don't miss out on making this your dream home!  
 Call me today

This property is being sold by auction or without a price and therefore a price guide can not be provided. The website may have filtered the property into a price bracket for website functionality .

## More About this Property

Property ID	5G5TF41
Property Type	House
Land Area	5325 m <sup>2</sup>
Including	Ducted Cooling Outdoor Entertaining Built-in-Robes

**Julie Morgan-Kemp 0409 691 416**

Sales Specialist | [julie@ljhgc.com.au](mailto:julie@ljhgc.com.au)

**LJ Hooker Nerang (07) 5581 4422**

2-4 New Street, NERANG QLD 4211

[nerang.ljhooker.com.au](http://nerang.ljhooker.com.au) | [nerang@ljhgc.com.au](mailto:nerang@ljhgc.com.au)



**Disclaimer:** All information contained therein is gathered from relevant third parties sources. We cannot guarantee or give any warranty about the information provided. Interested parties must rely solely on their own enquiries.

**LJ Hooker Nerang**  
**(07) 5581 4422**

Garden Shed  
3.0m x 3.0m  
(Not In Position)



LEGEND  
1 RESIDENCE  
2 GARAGE  
3 PATIO

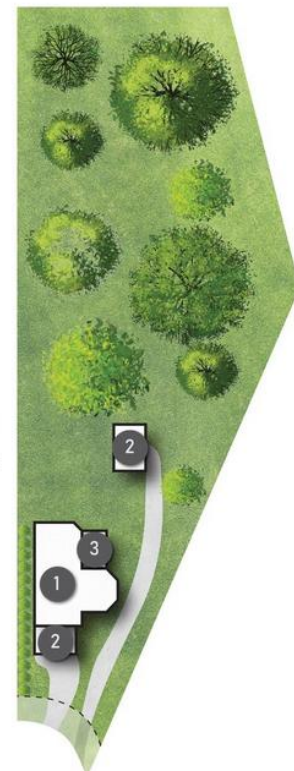

Kingsmead Court



15-17 Kingsmead Court MOUNT NATHAN

4 | 2 | 4 | 237m<sup>2</sup> | 5325m<sup>2</sup>

**LJ Hooker**

All dimensions are approximate; they are subject to errors and inaccuracies and no liability will be accepted. Plans are shown for marketing purposes only.

**LJ Hooker**

**LJ Hooker Nerang**  
(07) 5581 4422

**Disclaimer:** All information contained therein is gathered from relevant third parties sources. We cannot guarantee or give any warranty about the information provided. Interested parties must rely solely on their own enquiries.