



20 Marie Crescent, Mona Vale

It's a Cracker! Easy Living, Endless Potential

A renovators delight! Offered for the first time in over 37 years, this practical and much loved single level home is the perfect opportunity for those seeking effortless living in a peaceful, family-friendly location at an entry level price.

Set on a level 697sqm (approx.) block with an impressive 21-metre frontage, this brick veneer and tile home is designed for comfort and convenience, surrounded by established gardens and enjoys bushland views and open skies.

Practical and easy to maintain, it's ideal for young families, downsizers or renovators ready to update and make it their own.

Features include:

- Four bedrooms - three with built-in robes and main with private ensuite
- Handy three-way bathroom, ideal for busy households
- Neat and functional kitchen with a lovely garden outlook
- Formal lounge and dining with character-filled bay window
- Spacious informal living area adjoining the kitchen, perfect for relaxed family gatherings

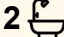
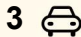
4  2  3 

FOR SALE
SOLD PRIOR TO AUCTION

AGENTS

Josephine Cowling
0419 430 766
jcowling@ljhmv.com.au

Luka Valkovic
0432 609 312
lvalkovic@ljhmv.com.au

AGENCY

LJ Hooker Mona Vale
(02) 9979 8000

All information contained therein is gathered from relevant third parties sources.
We cannot guarantee or give any warranty about the information provided.
Interested parties must rely solely on their own enquiries.

 **LJ Hooker**

- Internal laundry with direct backyard access and an original Hills Hoist
- Oversized automatic double garage and workshop space
- Additional large carport - perfect for your boat, trailer or camper
- Fully fenced, prized north facing backyard with covered entertaining area
- Bonus potting shed and large storage room or teen retreat
- Easy single-level layout - no stairs, easy flow throughout
- A very short stroll to both Marie and Whitney reserves and within walking distance of schools and transport

This is relaxed, low-maintenance living in one of Mona Vale's most tightly held pockets - bring your paint brush and carpet samples to get ready to move in and enjoy now, with scope to update and capitalise over time.

Distances:

Mona Vale Village Shops - 950m

Mona Vale Beach - 1.6km

Pittwater Foreshore - 1.1km

- Line Transport - 900m

Mater Maria Catholic College - 650m

Sacred Heart Catholic Primary - 750m

Mona Vale Public School - 1km

Pittwater High School - 1.5km

Single-level homes in this location are rarely offered, don't miss this incredible chance to secure easy living in the heart of Mona Vale.

Disclaimer:

All information contained herewith, including but not limited to the general property description, price and the address, is provided to LJ Hooker Mona Vale by third parties. We have obtained this information from sources we believe to be reliable; however, we cannot guarantee its accuracy. The information contained herewith should not be relied upon and you should make your own enquiries and seek advice in respect of this property or any property on this website.

MORE DETAILS

Property ID	2WC5F6K
Property Type	House
Land Area	696.9 m2

Josephine Cowling 0419 430 766

Licensed Real Estate Agent & Auctioneer | jcowling@ljhmv.com.au

Luka Valkovic 0432 609 312

Licensed Real Estate Agent | lvalkovic@ljhmv.com.au

LJ Hooker Mona Vale (02) 9979 8000

3/18 Bungan Street, MONA VALE NSW 2103

monavale.ljhooker.com.au | monavale@ljhmv.com.au



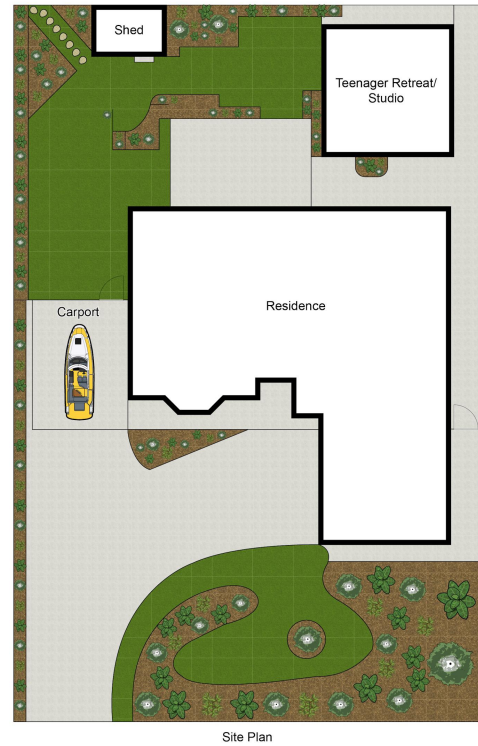
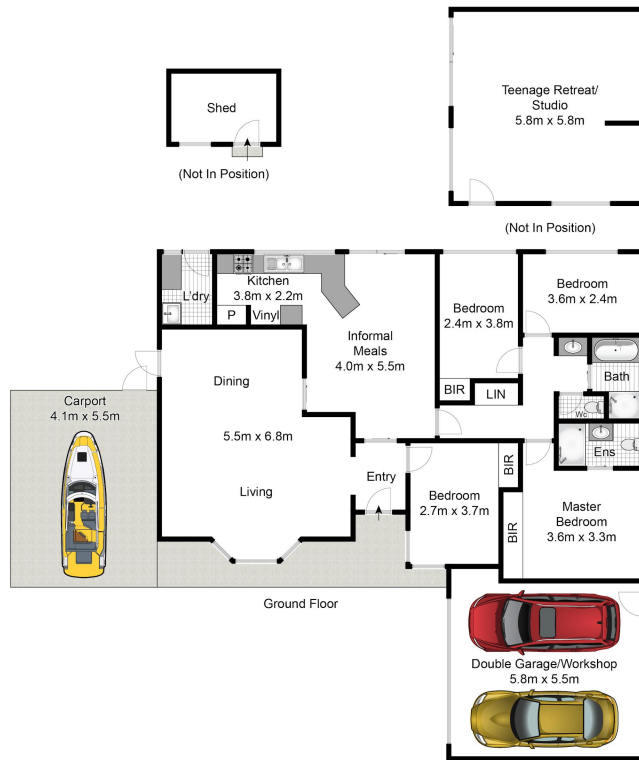

Whilst bwrn.com.au has made every attempt to ensure the accuracy of the floor plan contained here, measurements are approximate and no responsibility is taken for any error, omission, or mis-statement. This plan is for illustrative purposes only.



20 Marie Crescent, Mona Vale

LJ Hooker

All information contained therein is gathered from relevant third parties sources.
 We cannot guarantee or give any warranty about the information provided.
 Interested parties must rely solely on their own enquiries.

LJ Hooker