

Melbourne, 9/287 Exhibition Street

An Unmissable Opportunity in Melbourne's Iconic 'Paris End'

Presenting a truly exceptional opportunity to secure a unit in a heritage-style building at the prestigious 'Paris End' of Melbourne's CBD! This generously sized one-bedroom apartment offers a flexible and thoughtfully designed living and dining area, which can easily be converted into a second bedroom - an attractive feature for both discerning owner-occupiers and savvy investors.

The bedroom is fitted with a mirrored built-in robe, while the full bathroom includes a relaxing bathtub with a shower above it. A fully equipped kitchen and separate laundry facilities complete this functional and stylish apartment.

Architecturally significant, the building was designed by renowned firm Kenneth McDonald & Associates and constructed between 1969-1971. This 11-storey structure is a prime example of Post-War Modernist style, showcasing a solid external appearance with brick



Disclaimer: All information contained therein is gathered from relevant third parties sources. We cannot guarantee or give any warranty about the information provided. Interested parties must rely solely on their own enquiries.



For Sale
\$350,000 - \$380,000

View
Sat 29th Mar @ 1:00PM - 1:20PM

Contact
Ally Song
0403 221 620
Allys.cityresmelbourne@ljhooker.com.au

LJ Hooker City Residential
(03) 9600 2166

curtain walls, horizontal strips of aluminum-framed windows, and a prominent podium base.

Situated just steps from Chinatown, Melbourne's acclaimed restaurants, and the vibrant theatre district, this apartment delivers the ultimate urban lifestyle. Additionally, the property is within walking distance of the world heritage-listed Royal Exhibition Building and Carlton Gardens, offering a perfect balance between city living and tranquil green spaces.

Whether you are looking for an unparalleled city lifestyle or a sound investment in one of the city's most sought-after locations, this apartment promises a unique and high-potential opportunity.

Don't miss your chance - call Ally today to schedule your inspection and secure this premium property!

More About this Property

Property ID	N8BHC2
Property Type	Apartment
Land Area	56 m ²

Ally Song 0403 221 620

Manager | Allys.cityresmelbourne@ljhooker.com.au

LJ Hooker City Residential (03) 9600 2166

Upper Ground Floor, 439-445 Lonsdale St, MELBOURNE VIC 3000
cityresmelbourne.ljhooker.com.au | cityresmelbourne@ljhooker.com.au

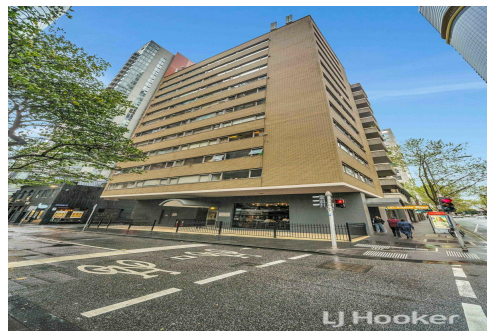
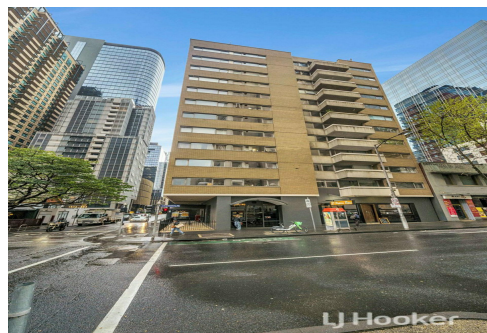

Disclaimer: All information contained therein is gathered from relevant third parties sources. We cannot guarantee or give any warranty about the information provided. Interested parties must rely solely on their own enquiries.

**LJ Hooker City Residential
(03) 9600 2166**

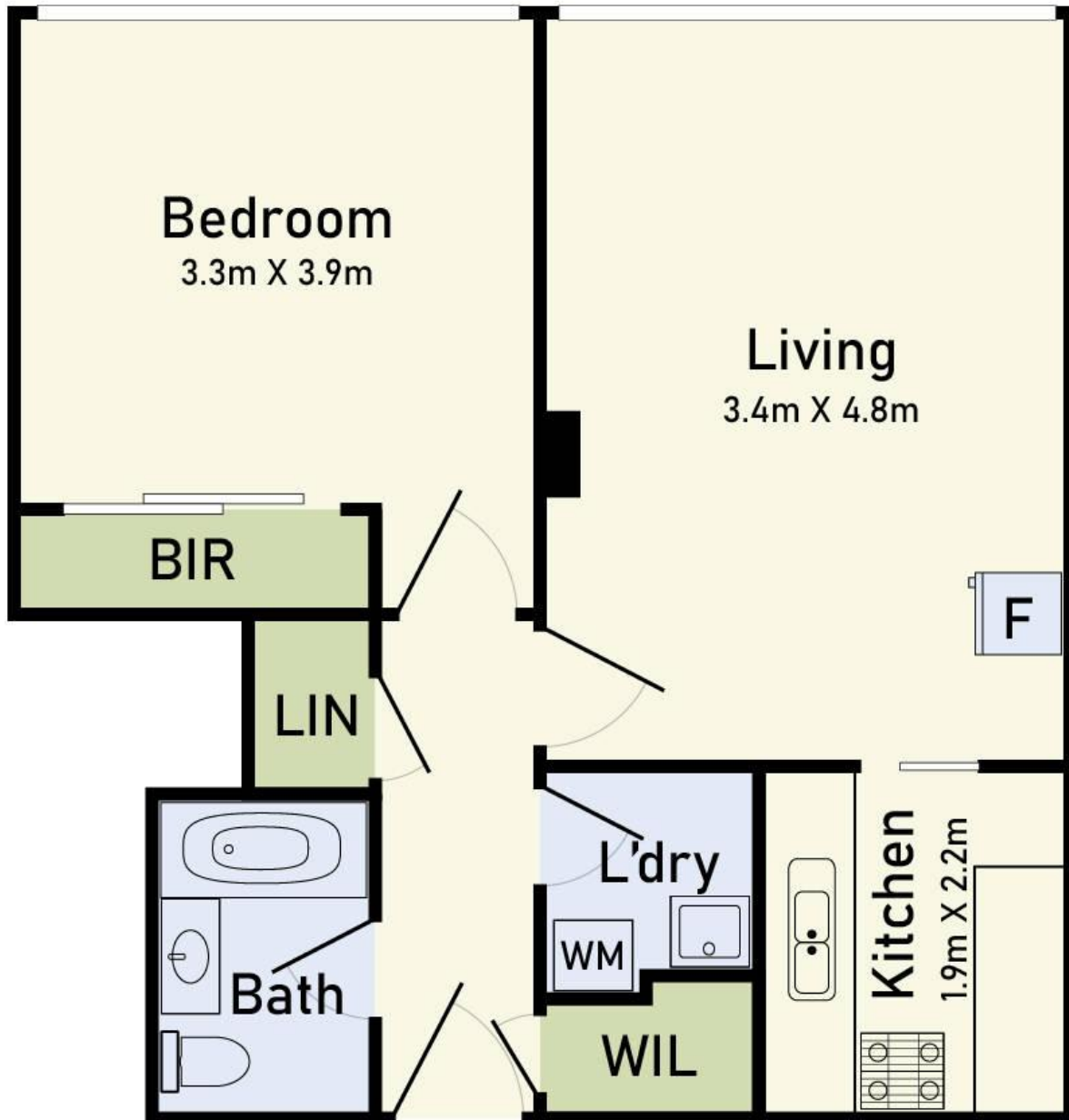

9/287 Exhibition Street, Melbourne

* Dimensions are approximate and for illustrative purposes only

