



17 Kallista Road, Maydena



Escape to the Country

Tucked away in the peaceful township of Maydena, this delightful two-bedroom home combines modern updates with a warm, welcoming feel. The open-plan kitchen and dining area flows effortlessly into the living space, where a cosy wood heater creates the perfect place to unwind after a day exploring the outdoors.

The home features a newly updated bathroom and a spacious rumpus room at the rear — ideal for a second living area, games room or creative studio. Outside, the large deck offers a great spot for BBQs and entertaining, while the nearby firepit area invites relaxed evenings under the stars.

A good-sized shed provides plenty of storage or workshop space, adding to the home's practicality. Whether you're looking for a comfortable permanent residence, a weekender, or an investment in this growing adventure hub, 17 Kallista Road is ready to impress.

The information contained herein has been supplied to us and we have no reason to doubt its accuracy, however, cannot guarantee it. Accordingly, all interested parties should make their own enquiries to verify this information.

2  1  1 

FOR SALE

Please Call

AGENTS

Nitin Joshi

0452 106 293

njoshi@ljhpinnacle.com.au

AGENCY

LJ Hooker Pinnacle Property

(03) 6272 8177

All information contained therein is gathered from relevant third parties sources. We cannot guarantee or give any warranty about the information provided. Interested parties must rely solely on their own enquiries.



MORE DETAILS

Property ID	BSJ1F
Property Type	House
House Size	91 m2
Land Area	725 m2
Including	Air Conditioning
	Balcony
	Dishwasher
	Fully Fenced
	Wood Heater

Nitin Joshi 0452 106 293

Property Representative | njoshi@ljhpinnacle.com.au

LJ Hooker Pinnacle Property (03) 6272 8177

402 Main Road, GLENORCHY TAS 7010
pinnacleproperty.ljhooker.com.au | hello@ljhpinnacle.com.au



All information contained therein is gathered from relevant third parties sources.
We cannot guarantee or give any warranty about the information provided.
Interested parties must rely solely on their own enquiries.

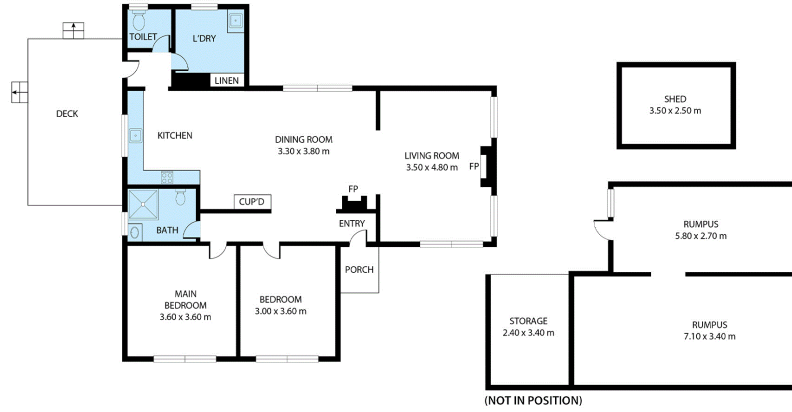
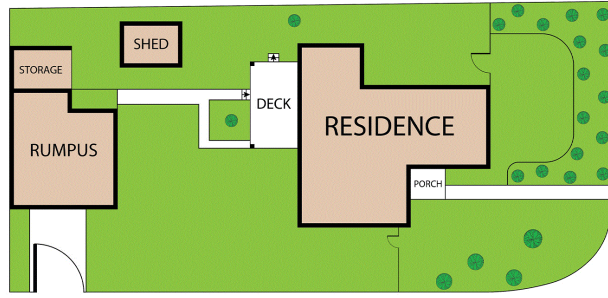

17 Kallista Road, Maydena

House area: 91 sqm

Areas and dimensions are approximate and therefore this floor plan should only be used for illustrative purposes.

Real Estate Marketing by nextcreative.com.au

House Area: 91 sqm
 Rumpus/Storage: 48 sqm
 Shed: 9 sqm
 Total Usable Area: 148 sqm

