



5/50a Bonar Street, Maitland

"The Enclave on Bonar"

The Enclave on Bonar - Boutique Luxury in the Heart of Maitland

Tucked quietly into one of Maitland's most convenient and connected pockets, The Enclave on Bonar sets a new benchmark for boutique living. A collection of just six masterbuilt freestanding units, each home has been designed with size, style, and substance in mind - delivering an address that feels both exclusive and unmistakably Maitland.

From the moment you step inside, the craftsmanship speaks for itself. Light-filled interiors pair generous proportions with a seamless, contemporary palette. The spacious open-plan living zone flows effortlessly to private outdoor alfrescos & private landscaped lawns & gardens, giving you a perfect setting for relaxed entertaining or quiet evenings at home.

Each of the 6 residences boast a custom designer kitchen with stone benchtops, premium appliances, and custom cabinetry - blending form and function in equal measure. The sleeping arrangements are spacious and serene, anchored by a beautifully appointed master suite complete with walk-in robe and ensuite. The bathrooms feature sleek fixtures, with frameless glass screens, floor to ceiling tiling, floating vanities and timeless finishes that elevate everyday living. All

2 🏠 2 🚿 1 🚗

FOR SALE

Selling from \$680,000 to \$720,000

AGENTS

Todd Fisher
0438 592 920
tfisher.maitland@ljhooker.com.au

Ben Cotton
0434 638 822
bcotton.maitland@ljhooker.com.au

AGENCY

LJ Hooker Maitland
(02) 4933 5511

All information contained therein is gathered from relevant third parties sources. We cannot guarantee or give any warranty about the information provided. Interested parties must rely solely on their own enquiries.

 **LJ Hooker**

residences come equipped with including ducted air conditioning & window furnishings for those finishing touches.

Beyond the doors of The Enclave, you'll find yourself moments from everything that makes Maitland so loved - from vibrant High Street & Levee cafes and boutique shopping to scenic river walks, professional & lifestyle options & only a short drive to East Maitland Greenhills Shopping Centre & Hospital district.

Whether you're an owner-occupier seeking modern ease or an investor looking for a premium low-maintenance opportunity, this is Maitland living, masterbuilt and redefined.

Note: Unit 4 reflected for marketing purposes

Proudly marketed by LJ Hooker Maitland, please call exclusive agents Todd Fisher 0438 592 920 or Ben Cotton 0434 638 822 - 7 days for all inspections & further information.

All information contained herein is gathered from sources we deem to be reliable. However, we cannot guarantee its accuracy and interested persons should rely on their own enquiries.

MORE DETAILS

Property ID	1ESJF6H
Property Type	Unit
Including	Ensuite
	Air Conditioning
	Toilets (2)
	Built-in-Robes
	Close to Schools
	Close to Shops
	Close to Transport
	Liveability

Todd Fisher 0438 592 920

Principal/Licensee in Charge | tfisher.maitland@ljhooker.com.au

Ben Cotton 0434 638 822

Licensed Real Estate Agent & Auctioneer | bcotton.maitland@ljhooker.com.au

LJ Hooker Maitland (02) 4933 5511

24 Ken Tubman Drive, MAITLAND NSW 2320
maitland.ljhooker.com.au | maitland@ljhooker.com.au



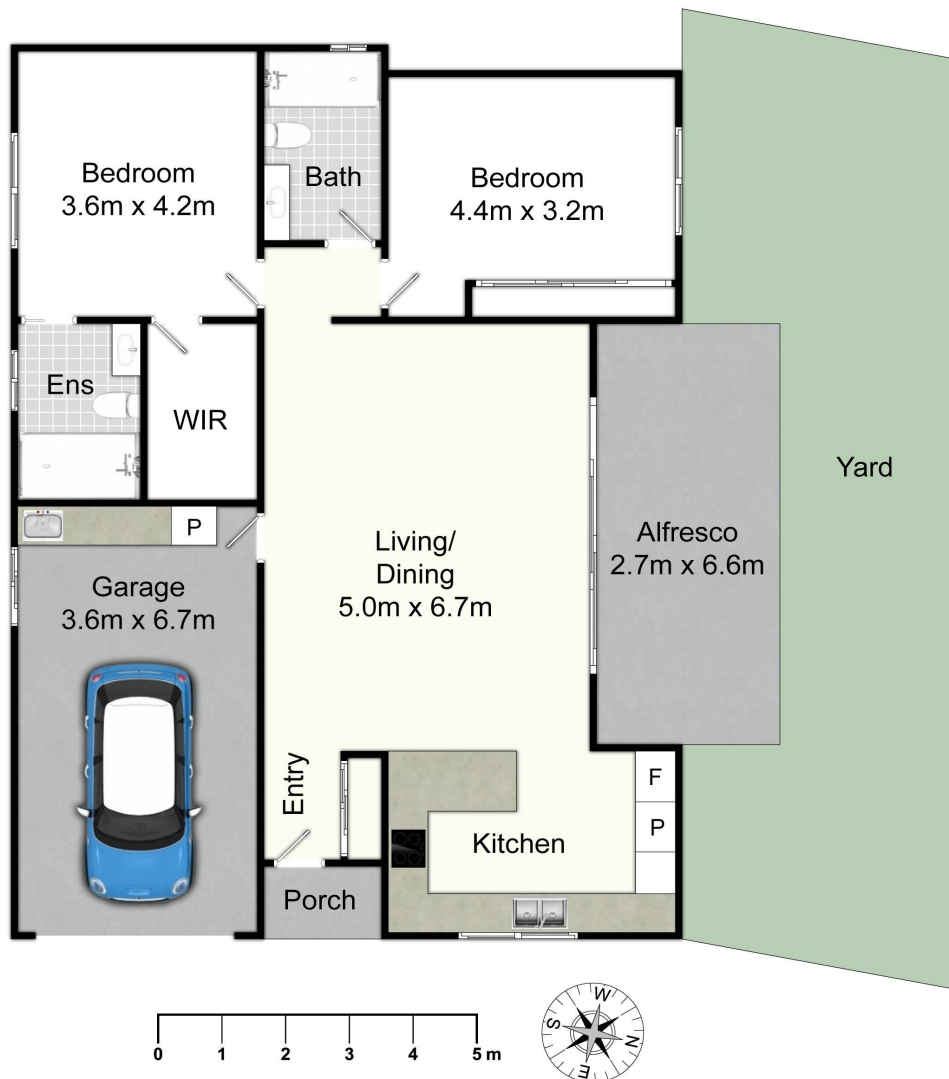

4/50A Bonar St, Maitland

All information contained herein is gathered from sources we deem reliable. However, we cannot guarantee its accuracy and act as a messenger only in passing on the details. Interested parties should rely on their own inquiries and the contract for sale. The floor plans are artist's impressions only. The site plan is not to scale.

 **LJ Hooker**
Maitland

All information contained therein is gathered from relevant third parties sources. We cannot guarantee or give any warranty about the information provided. Interested parties must rely solely on their own enquiries.

 **LJ Hooker**