



19 Beagle Terrace, Lynton

It's All About Location!

This beautifully presented home is sure to impress and will appeal to a variety of purchasers. Perfectly positioned on an easy care 774 sqm allotment (approx.) in a highly sought after location, this property offers space, comfort and flexibility for modern living.

Step inside to discover a spacious lounge room with a lovely outlook over the front garden & relaxing majestic views, creating a warm and welcoming first impression. The open plan kitchen and dining area provides the ideal setting for everyday living and entertaining.

The home features three good sized bedrooms (2 with built in robes) and an updated main bathroom, ensuring comfort and practicality for the whole family.

Adding even more versatility, an extensive enclosed undercover entertaining area extends your living space - perfect for year round gatherings with family and friends. And it doesn't stop there - a detached rumpus room with 4th bedroom, ensuite bathroom and walk-in robe offers endless possibilities as a teenager's retreat, home office, guest suite or hobby space.

Outside, enjoy an elevated garden area and entertaining patio that captures lovely views and provides a private outdoor retreat - ideal for

4  2  2 

FOR SALE
UNDER CONTRACT

AGENTS

Jarad Henry
0418 842 701
jarad@ljhglenelgbrighton.com.au

Debbie Mundy
0401 597 482
debbie@ljhglenelgbrighton.com.au

AGENCY

LJ Hooker Glenelg | Brighton
(08) 8294 6000

All information contained therein is gathered from relevant third parties sources.
We cannot guarantee or give any warranty about the information provided.
Interested parties must rely solely on their own enquiries.



garden beds or simply relaxing in the sunshine.
All this, just 20 minutes from the CBD, makes this property a rare find combining lifestyle, location and value.

Additional features include - dishwasher, ducted reverse cycle air conditioning throughout (new unit installed January 2025) and solar panels.

This home will surprise and delight - inspect to truly appreciate all it has to offer!

To submit an offer on this property visit this link:
<https://prop.ps/frL6XksqOXmH>

Property Details:
Council: Mitcham
Council Rates: \$1874.25 pa
SA Water: \$203.20 pq
House Size: 206 sqm (approx)
Land Size: 774 sqm (approx)
Year Built: 1963

For further information please contact Jarad Henry or Debbie Mundy.

Visit glenelgbrighton.ljhooker.com.au to view other LJ Hooker Glenelg | Brighton Listings.

Disclaimer: Neither the Agent nor the Vendor accept any liability for any error or omission in this advertisement.

Any prospective purchaser should not rely solely on 3rd party information providers to confirm the details of this property or land and are advised to enquire directly with the agent in order to review the certificate of title and local government details provided with the completed Form 1 vendor statement.

RLA 182909

MORE DETAILS

Property ID	N9MGW0
Property Type	House
House Size	206 m2
Land Area	774 m2
Including	Ensuite

Jarad Henry 0418 842 701
Principal | Auctioneer | Sales Consultant |
jarad@ljhglenelgbrighton.com.au
Debbie Mundy 0401 597 482
Co-Agent to Jarad Henry | debbie@ljhglenelgbrighton.com.au

LJ Hooker Glenelg | Brighton (08) 8294 6000
76 Oaklands Road, SOMERTON PARK SA 5044
glenelgbrighton.ljhooker.com.au | rebecca@ljhglenelgbrighton.com.au



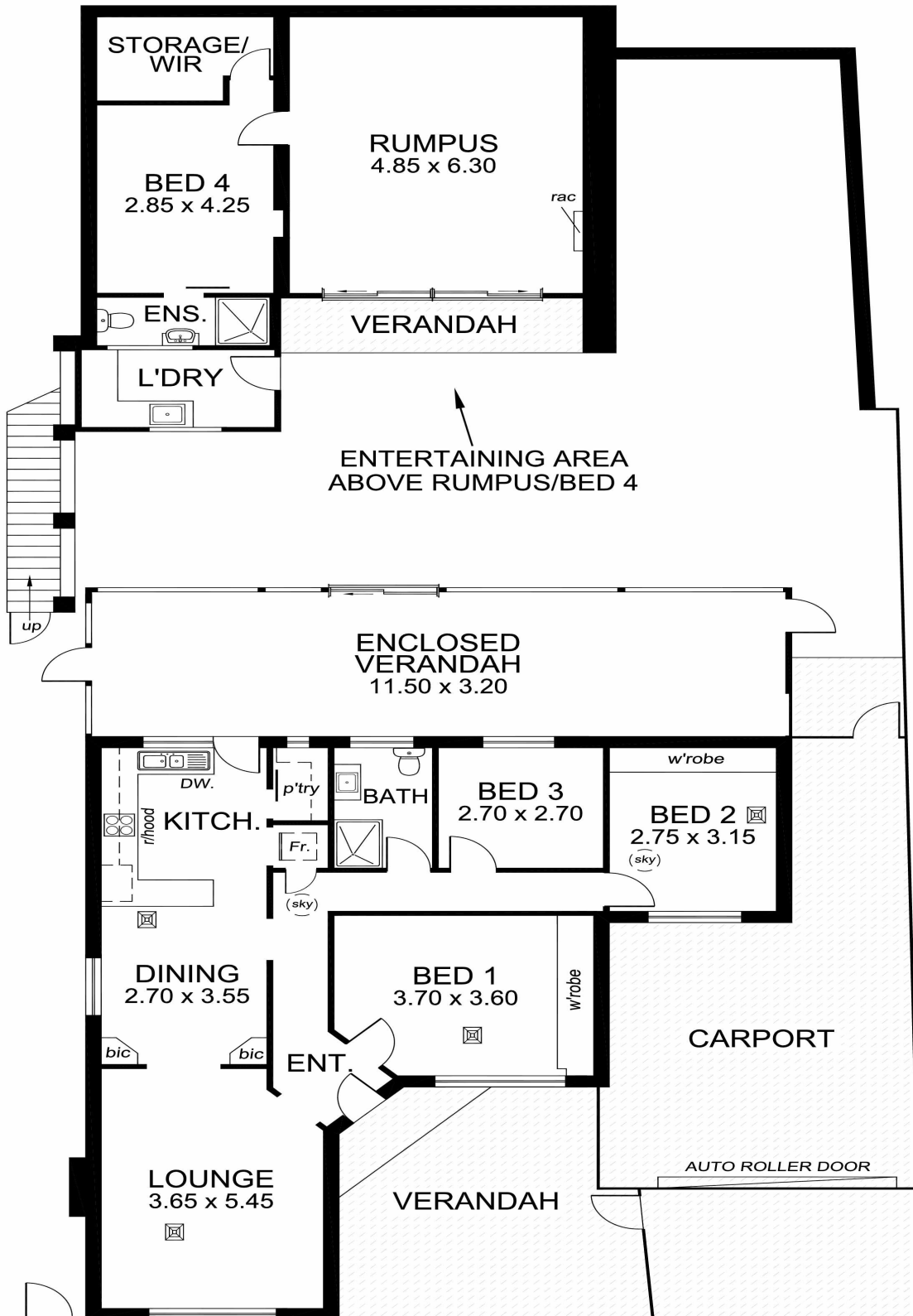

TOTAL AREA:	206.26m ² /22.17sqs
(Estimate only)	(incl. enclosed verandah)

This drawing is for illustration purposes only.
 All measurements are approximate only and information
 intended to be relied upon should be independently verified.