

26 Wynnlea Place, Lilydale

Stylish, Spacious Family Sanctuary with Distinctive Design

Perched on the high side of a peaceful court, this striking, sophisticated brand-new residence delivers a seamless blend of style, space and supreme comfort. Set on approximately 600sqm among other quality homes the property enjoys green gently rising hillside views to the front and peaceful privacy to the rear.

Thoughtfully tailored for modern family living, the home showcases four generously sized bedrooms and three beautifully finished bathrooms, including two magnificent master suites - perfect for multi-generational living or welcoming guests. An open plan living and dining zone, along with a separate, spacious rumpus room, creates flexibility for both relaxed living and refined entertaining.

At the heart of the home, a superb, statement kitchen is complemented by a butler's pantry, quality craftsmanship and abundant storage, while a large laundry adds further functionality.

Step outside to a covered alfresco area, perfect for year-round entertaining, flowing through to a securely fenced and beautifully landscaped garden - an inviting haven for families to relax, play and prosper.

Comfort is ensured year-round with ducted heating and cooling, while

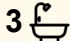
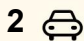
4  3  2 

FOR SALE

\$1,340,000 - \$1,380,000

VIEW

Sat 20th Jun @ 1:00PM - 1:30PM

AGENTS

Richard Goldsmith
0407 348 172
richardgoldsmith@ljhookermooroolbark.com.au

Ben Hudson
0424 288 954
benhudson@ljhookermooroolbark.com.au

AGENCY

LJ Hooker Mooroolbark
(03) 9726 7711

All information contained therein is gathered from relevant third parties sources.
We cannot guarantee or give any warranty about the information provided.
Interested parties must rely solely on their own enquiries.

 **LJ Hooker**

a double garage with automatic access and internal entry enhances everyday ease.

Ideally positioned close to the lively heart of Lilydale alongside the wonderful Warburton Trail, and on the doorstep of the Yarra Valley, this exceptional home delivers lifestyle, location and lasting luxury.

MORE DETAILS

Property ID	S18FMS
Property Type	House
Land Area	600 m2
Including	Air Conditioning
	Toilets (4)
	Dishwasher
	Outdoor Entertaining
	Built-in-Robes
	Remote Garage

Richard Goldsmith 0407 348 172

Senior Sales Consultant |
richardgoldsmith@ljhookermooroolbark.com.au

Ben Hudson 0424 288 954

Sales Consultant | benhudson@ljhookermooroolbark.com.au

LJ Hooker Mooroolbark (03) 9726 7711

64 Brice Avenue, MOOROOLBARK VIC 3138
mooroolbark.ljhooker.com.au | admin@ljhookermooroolbark.com.au





0 1 2 3 4
 approx. scale (m)
 This plan is a sketch, and all data shown is general only.
 NB: All stated dimensions are approximate only & should not be taken as definite.

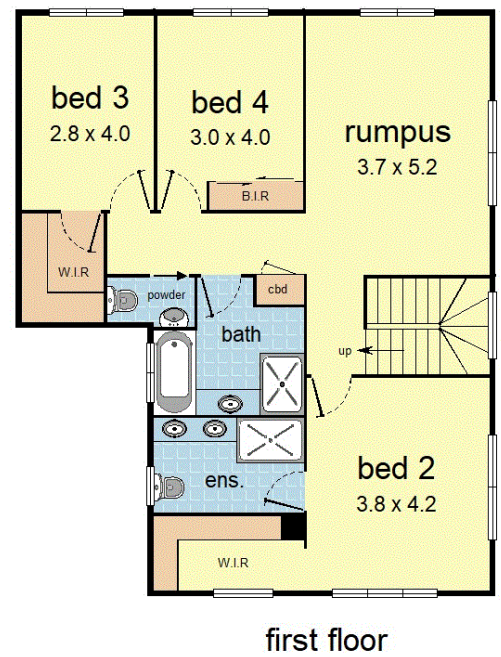

Lot 20 Wynnlea Place, Lilydale

All information contained therein is gathered from relevant third parties sources. We cannot guarantee or give any warranty about the information provided. Interested parties must rely solely on their own enquiries.

