



10 Dudley Street, Kurri Kurri

DUAL INCOME OPPORTUNITY!!

Positioned in the ever-popular and well-established suburb of Kurri Kurri, this outstanding dual-income property presents an exceptional opportunity for the savvy investor seeking strong returns and long-term growth.

Conveniently located just moments from Kurri Kurri CBD, local transport options, and the Hunter Expressway providing seamless access to Newcastle and Sydney, the location is as practical as it is desirable.

Set on a generous 897sqm parcel with rear lane access to the second dwelling, the property is currently generating a combined rental return of \$1,000 per week, with both quality tenants secured on leases through to later 2026 and early 2027, making this an ideal addition to any growing investment portfolio.

The front residence offers a well-maintained two-bedroom home featuring a spacious living area, two modern bathrooms for added convenience, along with a modern laminate kitchen adjoining a dedicated meals space. Vehicle accommodation is catered for with rear hardstand parking and convenient access through the laundry.

Privately positioned at the rear, the second dwelling is a comfortable

5 🏠 3 🚗 4 🚗

FOR SALE
DUAL INCOME PROPERTY!!

VIEW
By Appointment

AGENTS
Kane Bradley
0423 525 335
kbradley.maitland@ljhooker.com.au

AGENCY
LJ Hooker Maitland
(02) 4933 5511

All information contained therein is gathered from relevant third parties sources.
We cannot guarantee or give any warranty about the information provided.
Interested parties must rely solely on their own enquiries.

 **LJ Hooker**

three-bedroom home, all bedrooms complete with built-in wardrobes. Showcasing a generous lounge room with vaulted ceilings and split system air conditioning, the home provides a bright and spacious feel throughout. Additional features include a single carport, storage shed, and a fully fenced backyard for privacy and practicality.

Offering immediate income with no work required, this is a rare chance to secure a quality dual income investment in a thriving location.

Proudly marketed by LJ Hooker Maitland, please call exclusive agent Kane Bradley 0423 525 335 7 days for all inspections & further information.

All information contained herein is gathered from sources we deem to be reliable. However, we cannot guarantee its accuracy and interested persons should rely on their own enquiries.

MORE DETAILS

Property ID	1F2AF6H
Property Type	DuplexSemi-detached
Land Area	897 m2
Including	Air Conditioning Built-in-Robes Close to Schools Close to Shops Close to Transport Liveability

Kane Bradley 0423 525 335

Director/Licensee in Charge | kbradley.maitland@ljhooker.com.au

LJ Hooker Maitland (02) 4933 5511

24 Ken Tubman Drive, MAITLAND NSW 2320
maitland.ljhooker.com.au | maitland@ljhooker.com.au



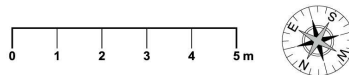
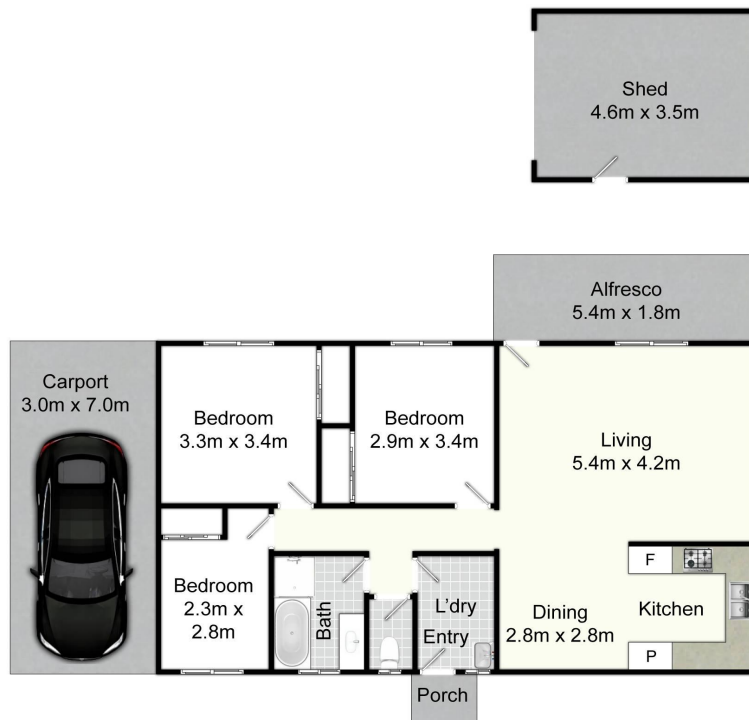

10 Dudley St, Kurri Kurri

All information contained herein is gathered from sources we deem reliable. However, we cannot guarantee its accuracy and act as a messenger only in passing on the details. Interested parties should rely on their own inquiries and the contract for sale. The floor plans are artist's impressions only. The site plan is not to scale.



All information contained therein is gathered from relevant third parties sources. We cannot guarantee or give any warranty about the information provided. Interested parties must rely solely on their own enquiries.

