

1 Avery Close, Kilalaba Bay

OWNER NEEDS IT SOLD! - BRICK AND TILE BEAUTY WITH THE SHED!

Welcome to 1 Avery Close, Kilalaba Bay. This single level three bedroom home boasts one of the best sheds you could ask for. Set in the quiet pocket of Kilalaba Bay and on a corner block this property is just a short stroll to lake reserves and parks. A single garage off Avery Close and off Kilalaba Road the 6mx12m approx shed with nearly 3.5m of height clearance allows you to store large boats, caravans and cars in a secure lock up shed. Set in the blue ribbon suburb of Kilalaba Bay, this home will not last long!

Features Include:

- Single level three bedroom home set on an approx. 696sqm corner block
- 11.9m x 6.5m shed with 3.47m approx door height clearance
- Kitchen and dining room flows out to sunny timber deck
- Zoned for the popular Coal Point Public School
- Fully fenced yard with established privacy hedges
- Less than 100m to Lake reserves
- 2.8km to Toronto CBD, Cafes and Restaurants

The information contained herein has been provided by people we believe to be reliable, however all interested parties must rely on their

3 1 5

FOR SALE

Buyers Guide \$849,000

VIEW

Tue 2nd Jun @ 4:00PM - 4:30PM

AGENTS

Callan O'Reilly

0412 168 303

callan.oreilly@ljhooker.com.au

AGENCY

LJ Hooker Lake Macquarie

(02) 4915 3800

All information contained therein is gathered from relevant third parties sources. We cannot guarantee or give any warranty about the information provided. Interested parties must rely solely on their own enquiries.

LJ Hooker

own enquiries.

MORE DETAILS

Property ID	ZH9F7Q
Property Type	House
Land Area	695.6 m2
Including	Toilets (1)

Callan O'Reilly 0412 168 303

Sales Executive | callan.oreilly@ljhooker.com.au

LJ Hooker Lake Macquarie (02) 4915 3800

Shop 12, 240-260 Hillsborough Road, WARNERS BAY NSW 2282
lakemacquarie.ljhooker.com.au | warnersbay@ljhooker.com.au



All information contained therein is gathered from relevant third parties sources.
We cannot guarantee or give any warranty about the information provided.
Interested parties must rely solely on their own enquiries.

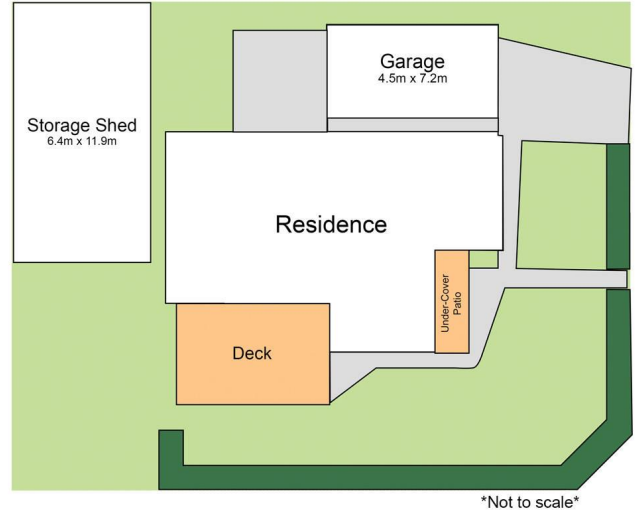

1 Avery Cl,
Kilaben Bay



Total Internal Floor Area: 104m²

Scale in metres. Indicative only. Dimensions are approximate. All information contained herein is gathered from sources we believe to be reliable. However we cannot guarantee its accuracy and interested persons should rely on their own enquiries



All information contained therein is gathered from relevant third parties sources. We cannot guarantee or give any warranty about the information provided. Interested parties must rely solely on their own enquiries.

