



101 Guildford Road, Guildford

SOLD AT AUCTION BY PAULETTE GHALEB 0408 888 810

Offered for the first time in over 60 years, this neat brick home presents an exciting opportunity for home buyers, investors and developers alike.

Set on an elevated 695.6 sqm block with a wide 15.24m frontage (approx.), the property combines classic charm with exceptional potential for future growth.

Positioned within easy reach to most amenities, the location offers convenience and accessibility.

The existing home is neat and comfortable featuring:

- 3 bedrooms
- Separate lounge and dining room
- Neat kitchen and bathroom
- Sunroom
- Garage plus carport
- Large block - 695.6 sqm approx.
- 15.24 metre frontage approx.

All information contained therein is gathered from relevant third parties sources. We cannot guarantee or give any warranty about the information provided. Interested parties must rely solely on their own enquiries.

3 1 2

FOR SALE
\$1,397,000

AGENTS

Paulette Ghaleb
0408 888 810
paulette.ghaleb@ljhooker.com.au

AGENCY

LJ Hooker Parramatta | Granville |
Guildford | Merrylands
(02) 9637 8555



- Duplex potential (STCA)
- Knock down and rebuild with room for extras such as pool (STCA)
- Renovate/extend the existing home and explore the potential to add a granny flat (STCA).

Whether you are looking to move in, renovate and extend, or rebuild entirely, this property offers incredible flexibility.

Properties with this much potential are becoming increasingly scarce - secure your slice of Guildford today!

MORE DETAILS

Property ID	2GGGF9E
Property Type	House
Land Area	695.6 m2
Including	Toilets (2)
	Car Parking - Surface
	Close to Schools
	Close to Shops
	Close to Transport

Paulette Ghaleb 0408 888 810

Area Specialist | paulette.ghaleb@ljhooker.com.au

LJ Hooker Parramatta | Granville | Guildford | Merrylands (02) 9637 8555

42 South Street, GRANVILLE NSW 2142

granville.ljhooker.com.au | granville@ljhooker.com.au



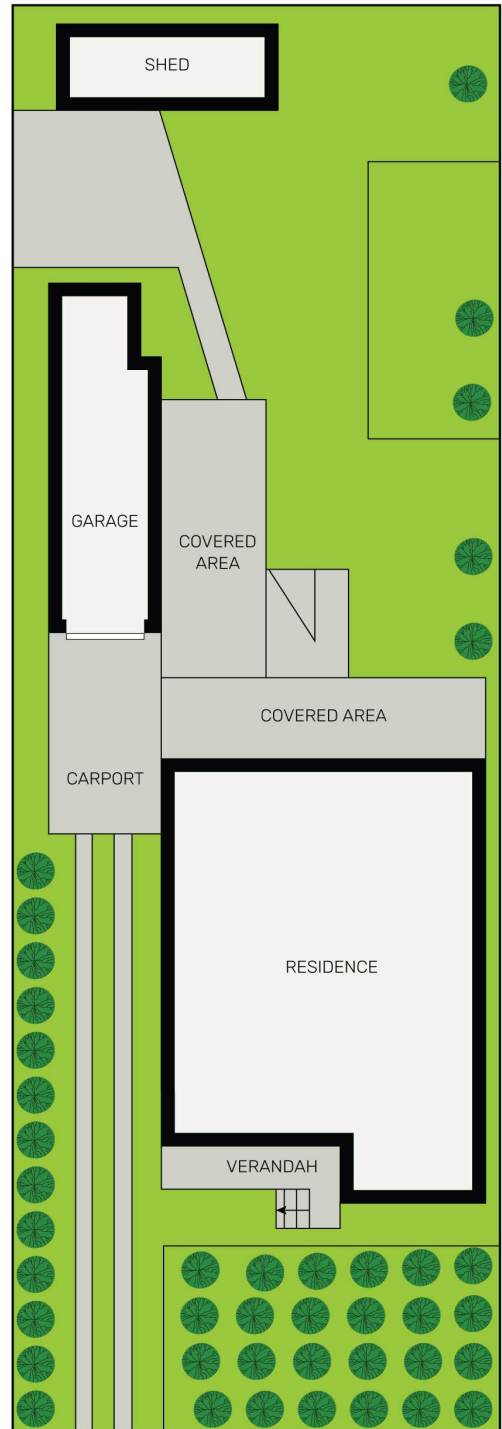
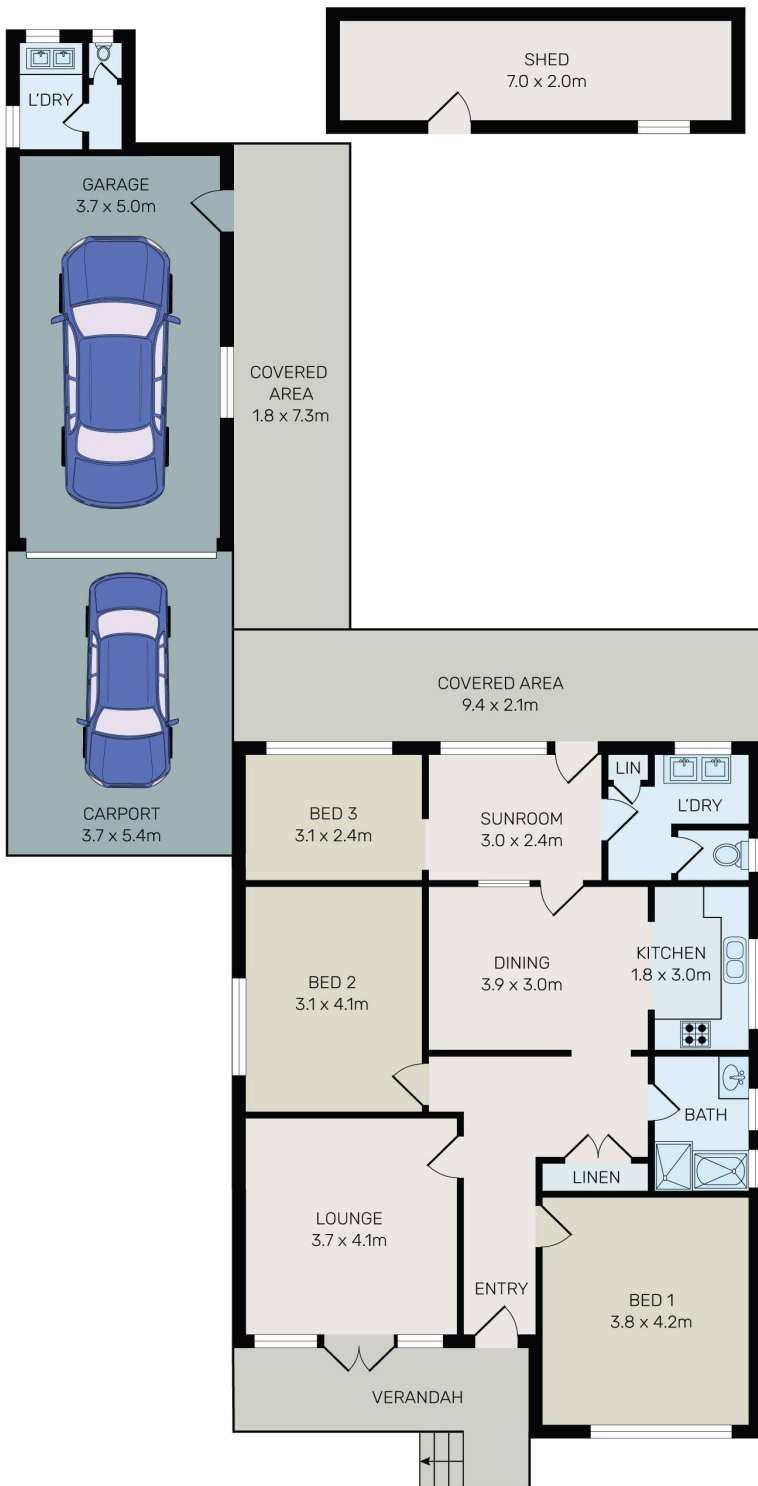

All information contained herein is gathered from all sources we believe to be reliable. However we cannot guarantee its accuracy and interested parties should rely on their own enquiries.

101 Guildford Road, Guildford

All information contained therein is gathered from relevant third parties sources. We cannot guarantee or give any warranty about the information provided. Interested parties must rely solely on their own enquiries.