



21 Marungi Way, Greenfields

Your Family Oasis with Pool, Workshop & Side Access!

Welcome to 21 Marungi Way, Greenfields in the sought after Riverside Gardens Estate- the ultimate family home that ticks every box! With a sparkling saltwater pool, a massive powered workshop, and side access for your boat or caravan, this property offers the perfect blend of lifestyle, comfort, and practicality. Marungi Reserve, a park and basketball court are right across the road, giving you a great outdoor amenity just steps from your front door.

Step inside to find a newly renovated chefs kitchen, near-new carpets, and ducted air-conditioning throughout for efficient year-round comfort. The practical layout includes three minor bedrooms (one currently used as a study), a family bathroom, and a good-sized master bedroom complete with walk-in wardrobe and ensuite.

Key Features

- " Neat & tidy modernised 4-bedroom, 2-bathroom home
- " Saltwater below-ground pool —ideal for summer
- Huge 9m x 6m (approx.) powered workshop
- Side access with drive-through access to workshop
- Gabled patio entertaining area with wifi ceiling fans & weather blinds

All information contained therein is gathered from relevant third parties sources. We cannot guarantee or give any warranty about the information provided. Interested parties must rely solely on their own enquiries.

4 🏠 2 🚗 2 🚚

FOR SALE
Offers Over \$749,000

AGENTS

Gopika Kaku
0493 530 809
gkaku.mandurah@ljhooker.com.au

Jessica Kaku
0422 114 037
jessica.kaku@ljhpxp.com.au

AGENCY

LJ Hooker Mandurah
(08) 9586 5555

 **LJ Hooker**

- newly renovated open plan kitchen and butlers pantry/laundry with induction cooktop, matching integrated range hood, integrated dishwasher and clever storage
- near-new carpets to lounge and bedrooms
- LED smart lighting throughout
- King-size master bedroom with motorised blind, walk-in robe & ensuite
- Great-sized minor bedrooms, all with built-in robes
- MyAir Ducted air-conditioning throughout with zones and individual room sensors
- Double carport plus extra parking for boat or caravan
- Walking distance to Riverside Primary School and the Serpentine River reserve

Other property features

Land area : 784m²

Year Built : 1990

Council rates: \$1300 approx

Water Rates : \$1416 approx (2024-2025 financial year)

Rental appraisal : \$650 to \$700 pw

All that's left to do is move in and enjoy! With everything already done for you, this home is ready to welcome its new owners to an easy, relaxed lifestyle. Be quick, call today to discuss further or to make an offer!

Disclaimer: Some pictures are for illustrative purposes only. This description has been prepared for advertising and marketing purposes only. It is believed to be reliable and accurate; however buyers must make their own independent inquiries and must rely on their own personal judgment about the information included in this advertisement. Gopika Kaku and LJ Hooker Mandurah provides this information without any express or implied warranty as to its accuracy or currency.

MORE DETAILS

| | |
|---------------|--------------------|
| Property ID | 4S83FF2 |
| Property Type | House |
| Land Area | 784 m ² |

Gopika Kaku 0493 530 809

Sales Executive | gkaku.mandurah@ljhooker.com.au

Jessica Kaku 0422 114 037

Sales Executive | jessica.kaku@ljhpxp.com.au

LJ Hooker Mandurah (08) 9586 5555

68 Mandurah Terrace, MANDURAH WA 6210

mandurah.ljhooker.com.au | hello.south@ljhpxp.com.au

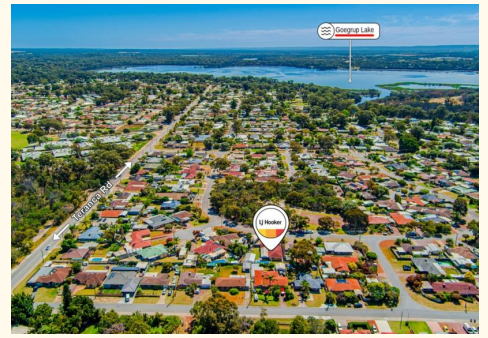

21 Marungi Way, Greenfields

block size 784 m² | building 120m² | 4 x  2 x  2 x 

 **LJ Hooker**

Gopika Kaku | 0493 530 809

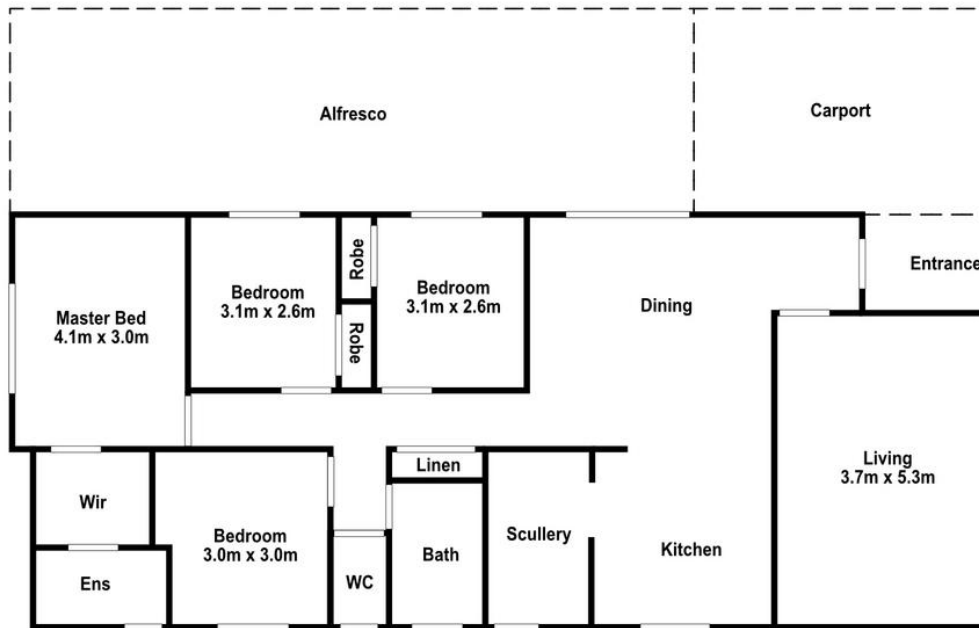

*scale in metres. dimensions are approximate. all information contained herein from sources we believe to be reliable, however we cannot guarantee its accuracy and interested persons should rely on their own enquirers.



© gbph.Lau

All information contained therein is gathered from relevant third parties sources.
We cannot guarantee or give any warranty about the information provided.
Interested parties must rely solely on their own enquiries.

 **LJ Hooker**