



1/30 Wheatsheaf Road, Glenroy

2  1  1 

## Low-Maintenance Living in the Heart of Glenroy 1/30 Wheatsheaf Road, Glenroy

**FOR SALE**  
Private Sale: \$450,000

**AGENTS**  
Yannie Hou  
0416 868 512  
yhou.rowville@ljhooker.com.au

Lisa Field  
rowville@ljhooker.com.au

**AGENCY**  
LJ Hooker Rowville  
(03) 9132 5118

Perfectly Positioned for Lifestyle, Comfort, and Investment Return

Perfectly positioned for lifestyle and convenience, this charming 2-bedroom villa unit presents an exceptional opportunity for first-home buyers, downsizers, and savvy investors alike. Nestled in a boutique block, this light-filled residence blends practicality with potential in a highly sought-after location.

Ideal for both investors and owner-occupiers —currently leased at \$1,825 per month on a flexible month-by-month tenancy, offering the perfect balance of immediate rental return and future move-in flexibility.

Recently updated to reflect a fresh and modern look, the property has been meticulously maintained and is in excellent condition throughout—ready to enjoy from day one.

Step inside to a spacious open-plan living and dining area, complemented by a well-equipped kitchen with ample storage. Two

All information contained therein is gathered from relevant third parties sources. We cannot guarantee or give any warranty about the information provided. Interested parties must rely solely on their own enquiries.

 **LJ Hooker**

generous bedrooms with built-in robes are serviced by a combined bathroom and laundry. The neutral interior provides a versatile canvas ready to suit any style.

#### Key Features:

- Freshly renovated with modern interior finishes
- Two well-proportioned bedrooms with built-in robes
- Bright and spacious open-plan living zone
- Functional kitchen with freestanding cooker
- Combined bathroom and laundry with bathtub
- Single off-street car space
- Front unit with private entry and garden aspect
- Move-in ready with excellent presentation throughout

Located within walking distance to Glenroy train station, local shops, cafes, parks, and quality schools, this villa unit delivers low-maintenance living in an ultra-convenient setting. Whether you're starting out, scaling down, or building your investment portfolio, this is an opportunity not to be missed.

Enquire now to arrange a private inspection —properties like this don't stay available for long!

#### MORE DETAILS

Property ID                    2NNHWN  
Property Type                Unit

**Yannie Hou 0416 868 512**

Senior Property Consultant | [yhou.rowville@ljhooker.com.au](mailto:yhou.rowville@ljhooker.com.au)

**Lisa Field**

| [rowville@ljhooker.com.au](mailto:rowville@ljhooker.com.au)

**LJ Hooker Rowville (03) 9132 5118**

Unit 11-12/ 7 Fulham Road, ROWVILLE VIC 3178

[rowville.ljhooker.com.au](http://rowville.ljhooker.com.au) | [rowville@ljhooker.com.au](mailto:rowville@ljhooker.com.au)



## Floor Plan

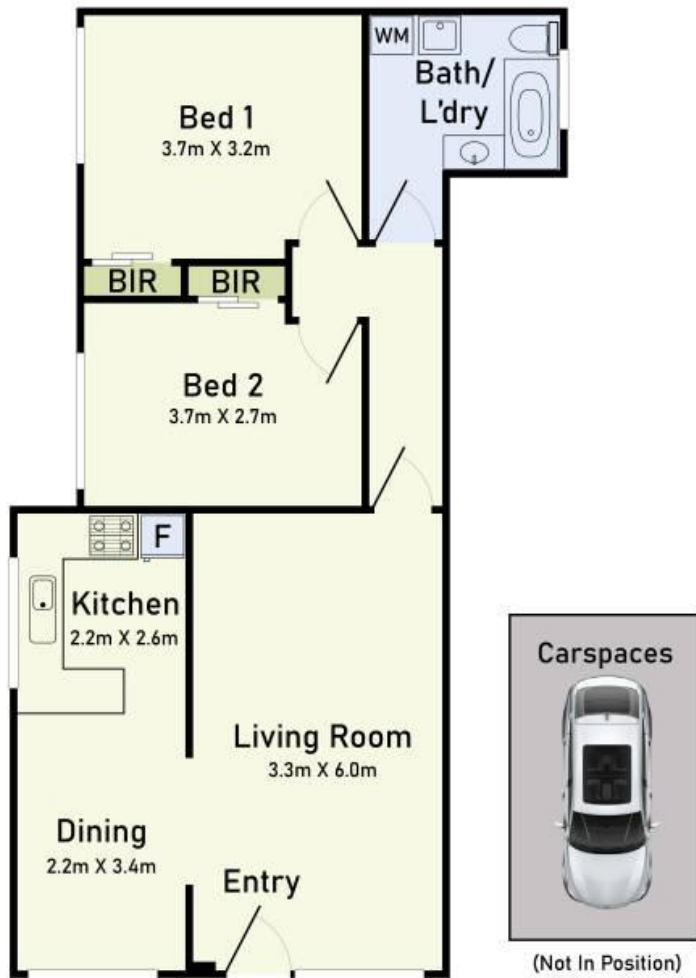

## Site Plan

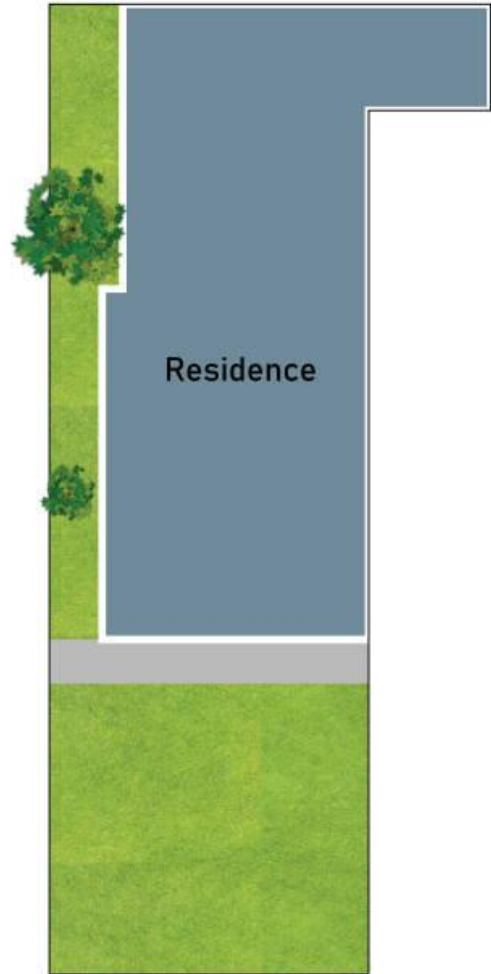

## 1/30 Wheatsheaf Road, Glenroy

\* Dimensions are approximate and for illustrative purposes only

