



# A METICULOUSLY CURATED COLLECTION

HOMES DESIGNED TO CAPTIVATE AND INSPIRE



## A NEW CHAPTER AWAITS

If you're considering your next move, The Enclave offers an exclusive opportunity to purchase a new home, intentionally crafted and truly unique. Set on the northern edge of Feilding, each residence is designed and built by The Housing Lab. Choose a beautifully crafted move-in ready home, or collaborate with our team to help shape a residence tailored to your vision and lifestyle. We invite you to explore what's possible.

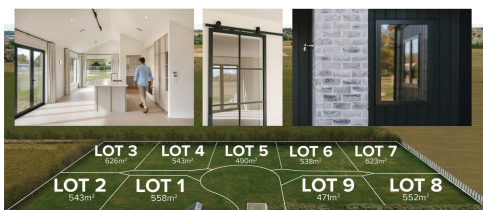

## Feilding, Lot 4 The Enclave

### Welcome to The Enclave

A meticulously curated collection of Manawatu homes designed to captivate and inspire. At the northern fringe of Feilding, we're creating a community of distinctively crafted homes that redefine what it means to live with flair. From thoughtfully composed cladding and windows to lighting, every detail has been carefully considered to ensure that each residence stands out for its ingenuity and artistry. You won't find a cookie-cutter home on this street; every home will be unique with a consistent quality design story woven throughout the details. Join us on this journey as we pave the way for a new standard of living, where quality meets individuality.

Choose your pathway.

#### 1. Homes For Sale

Purchase an Enclave home off the plan, or a completed residence. Secure a new home having the confidence that every detail has been thoughtfully designed and carefully crafted by our experienced team. With a love of what's interesting, and a commitment to

3

2

2

#### For Sale

Asking Price \$925,000

#### View

By Appointment

#### Contact

**Jamie Madigan**

027 446 1149

jamie.madigan@ljhookerpnp.co.nz

**Bronte Madigan**

0278006575

bronte.madigan@ljhookerpnp.co.nz



**Disclaimer:** All information contained therein is gathered from relevant third parties sources.

We cannot guarantee or give any warranty about the information provided. Interested parties must rely solely on their own enquiries.

**LJ Hooker Palmerston North**

**(06) 358 9009**

Manawatu (1994) Ltd

impeccable craftsmanship, our mission is to build homes that shine.

## 2. Bespoke Build

Collaborate with The Housing Lab to design and build that special home you have always dreamed of in The Enclave. Experience the inner workings of 'The Lab', as together we blend sparks of inspiration to craft a captivating new home within this unique community. Our team of architects, interior designers and builders are masters of their trade and you can join us on this pathway knowing you have access to our expertise, connections and experience.

For any information regarding The Enclave subdivision and development plans or to secure a spot in The Enclave, call Team Madigan today!

Jamie Madigan - 027 446 1149

Bronte Madigan - 027 800 6575

## More About this Property

Property ID	WJSGFB
Property Type	House
House Size	194 m2
Land Area	558 m2
Licensed Real Estate Agents (REAA2008)	

### Jamie Madigan 027 446 1149

Associate Manager & Residential Marketing Consultant |  
jamie.madigan@ljhookerpn.co.nz

### Bronte Madigan 0278006575

Marketing and Sales Consultant | bronte.madigan@ljhookerpn.co.nz

### LJ Hooker Palmerston North (06) 358 9009

Manawatu (1994) Ltd  
219 Broadway Avenue, PALMERSTON NORTH 4414  
palmerstonnorth.ljhooker.co.nz | reception@ljhookerpn.co.nz

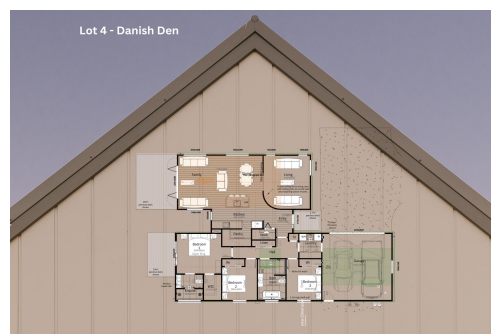

**Disclaimer:** All information contained therein is gathered from relevant third parties sources. We cannot guarantee or give any warranty about the information provided. Interested parties must rely solely on their own enquiries.

**LJ Hooker Palmerston North**  
**(06) 358 9009**  
Manawatu (1994) Ltd