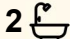
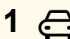

26D Redding Rise, Epping

2  2  1 

## Modern Townhouse with Everyday Convenience at Your Doorstep

**FOR SALE**  
\$485,000 - \$505,000

**VIEW**  
By Appointment

**AGENTS**  
Mac Naidoo  
0452 516 565  
mac.naidoo@ljhooker.com.au

Paul Nuske  
0414 717 458  
paul.nuske@ljhooker.com.au

**AGENCY**  
LJ Hooker Point Cook  
(03) 9975 7080

### The Property

Welcome to 26D Redding Rise, Epping. Beautifully presented with modern finishes throughout, this townhouse is completed to a high standard, delivering a comfortable and inviting living environment. The open-plan living and dining domain is enhanced by natural light, creating a welcoming space for everyday living. Comprising two bedrooms, two bathrooms and a single garage, the home offers a low-maintenance lifestyle, set within a thriving pocket of Epping, surrounded by quality schools, landscaped parklands, Aurora Village shopping precinct, cafés and public transport options, presenting an excellent opportunity for first home buyers or a savvy investor looking to expand their portfolio.

### The Point of Difference

- A spacious open-plan living and dining area, enhanced by tiled flooring and natural light, offering a comfortable setting that extends through sliding doors to the outdoor courtyard
- Boasting two spacious carpeted bedrooms with built-in robes, the main bedroom features a private ensuite and is equipped with a

All information contained therein is gathered from relevant third parties sources. We cannot guarantee or give any warranty about the information provided. Interested parties must rely solely on their own enquiries.



split system heating and cooling unit, and a convenient modern central bathroom.

- A well-designed kitchen showcases quality stainless steel appliances, laminate benchtops, a generous pantry, and ample cabinetry and storage, complemented with a subway tiled splashback, ideal for everyday meals and casual dining.
- The courtyard presents a private outdoor area designed for low-maintenance living.
- Additional highlights include split system heating and cooling to the main living area, a separate laundry, and a single remote garage.

#### The Point of Interest

Enjoying a prime position within the sought-after Aurora Estate, this location delivers outstanding convenience and connectivity. Aurora Village is just moments away, offering supermarkets, cafés and everyday essentials, while Pacific Epping provides an extensive retail, dining and entertainment precinct nearby. Surrounding parklands, playgrounds and walking trails contribute to the area's lifestyle appeal. Families are well catered for with a selection of nearby schools including Harvest Home Primary School, Edgars Creek Secondary College and Al Siraat College, while also being zoned to Epping Secondary College and Epping Views Primary School. Well-serviced by nearby bus routes, with easy access to Epping Railway Station and South Morang Railway Station, as well as Northern Hospital Epping and Epping Private Hospital, this location ensures exceptional everyday convenience.

Note. All stated dimensions are approximate only. Particulars given are for general information only and do not constitute any representation on the part of the vendor or agent. Any school zoning stated based on [www.findmyschool.vic.gov.au](http://www.findmyschool.vic.gov.au) as of 01/04/26.

#### MORE DETAILS

Property ID	2JA6HGH
Property Type	Townhouse
House Size	104 m <sup>2</sup>
Land Area	109 m <sup>2</sup>

#### Mac Naidoo 0452 516 565

Sales Executive | [mac.naidoo@ljhooker.com.au](mailto:mac.naidoo@ljhooker.com.au)

#### Paul Nuske 0414 717 458

Licensed Estate Agent | [paul.nuske@ljhooker.com.au](mailto:paul.nuske@ljhooker.com.au)

#### LJ Hooker Point Cook (03) 9975 7080

Shop 211, 4 Main Street, POINT COOK VIC 3030

[pointcook.ljhooker.com.au](http://pointcook.ljhooker.com.au) | [pointcook@ljhooker.com.au](mailto:pointcook@ljhooker.com.au)



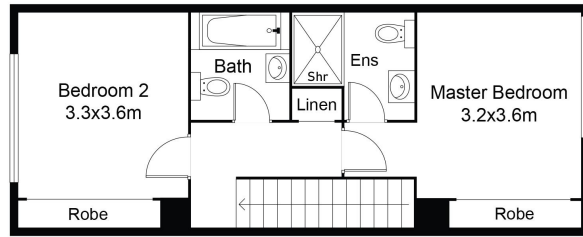

FIRST FLOOR PLAN

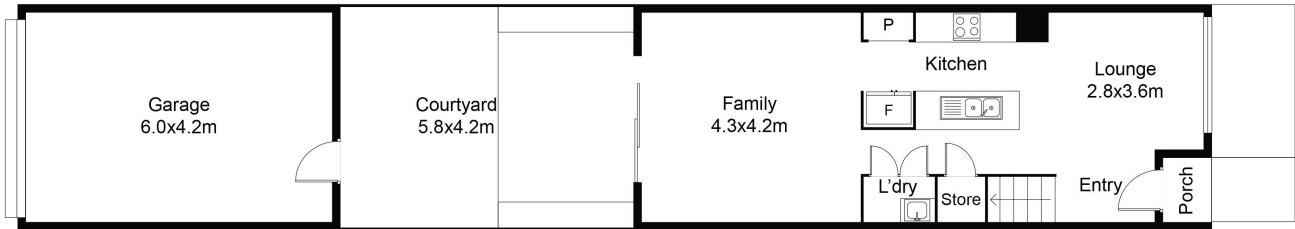

GROUND FLOOR PLAN

This floor plan including furniture, fixture measurements and dimensions are approximate and for illustrative purposes only. Realty Photos Wyndham gives no guarantee, warranty or representation as to the accuracy and layout. All enquiries must be directed to the agent, vendor or party representing this floor plan.

