

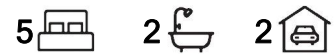

Elizabeth Downs, 56 & 58 Loftis Road

Buy One or Buy Them Both it's Your Choice



An Exceptional Investment Opportunity Awaits You!

Whether you're a seasoned developer or a first-time investor, these properties are a must-see! Total block size for both properties: 1102 square meters (approx)

56 Loftis Road, Elizabeth Downs: 513 square meters (approx)

A 2-bedroom maisonette, currently leased until October 2024 to a long-term tenant eager to stay on.

Price Guide 56 Loftis: \$370,000 to \$390,000

Key Features of 56 Loftis Road:

- Separate lounge
- Two generously sized bedrooms
- Updated kitchen and dining area



Disclaimer: All information contained therein is gathered from relevant third parties sources. We cannot guarantee or give any warranty about the information provided. Interested parties must rely solely on their own enquiries.

For Sale
Please Call

View
ljhooker.com.au/664ZFDC

Contact
Gareth Dickins
0417883329
gareth.dickins@ljhces.com.au

LJ Hooker Craigmore | Elizabeth | Salisbury
(08) 8255 9555

- Renovated bathroom, toilet, and laundry
- Aluminum windows with security screens
- Updated roof
- Carport

58 Loftis Road, Elizabeth Downs: 589 square meters (approx.)

A 3-bedroom maisonette, currently leased until May 2025.

Price guide 58 Loftis: \$390,000 to \$410,000

Property features include:

- Separate lounge
- 3 generously sized bedrooms
- Kitchen/dining area
- Polished timber floorboards
- Split system air conditioning
- Updated bathroom, toilet, and laundry
- Security screens and an updated roof
- Single carport
- Garage with tilt-door access

Prime Location:

Conveniently situated near Munno Para Shopping Centre and Elizabeth Shopping Centre, this property offers easy access to public transport, shops, fast food outlets, and excellent local schools. Nearby educational facilities include Elizabeth Downs Primary School, South Downs Primary School, Elizabeth Park Primary School, Craigmore High School, and Karna Plains School.

These properties are a perfect addition to your investment portfolio, with a strong rental history and long-term potential! Call Gareth today for more information & viewing times.

Disclaimer:

We have in preparing this document used our best endeavours to ensure the information contained is true and accurate, but accept no responsibility and disclaim all liability in respect to any errors, omissions, inaccuracies or misstatements contained. Prospective purchasers should make their own enquiries to verify the information contained in this document.

RLA155355

More About this Property

Property ID	664ZFDC
Property Type	House
Land Area	1102 m ²

Gareth Dickins 0417883329

Sales Representative | gareth.dickins@ljhces.com.au

LJ Hooker Craigmore | Elizabeth | Salisbury (08) 8255 9555

Shop 17, Craigmore Village, Yorktown Road, CRAIGMORE SA 5114
craigmoreelizabeth.ljhooker.com.au | Office@ljhces.com.au



Disclaimer: All information contained therein is gathered from relevant third parties sources.

We cannot guarantee or give any warranty about the information provided. Interested parties must rely solely on their own enquiries.



LJ Hooker Craigmore | Elizabeth | Salisbury (08) 8255 9555

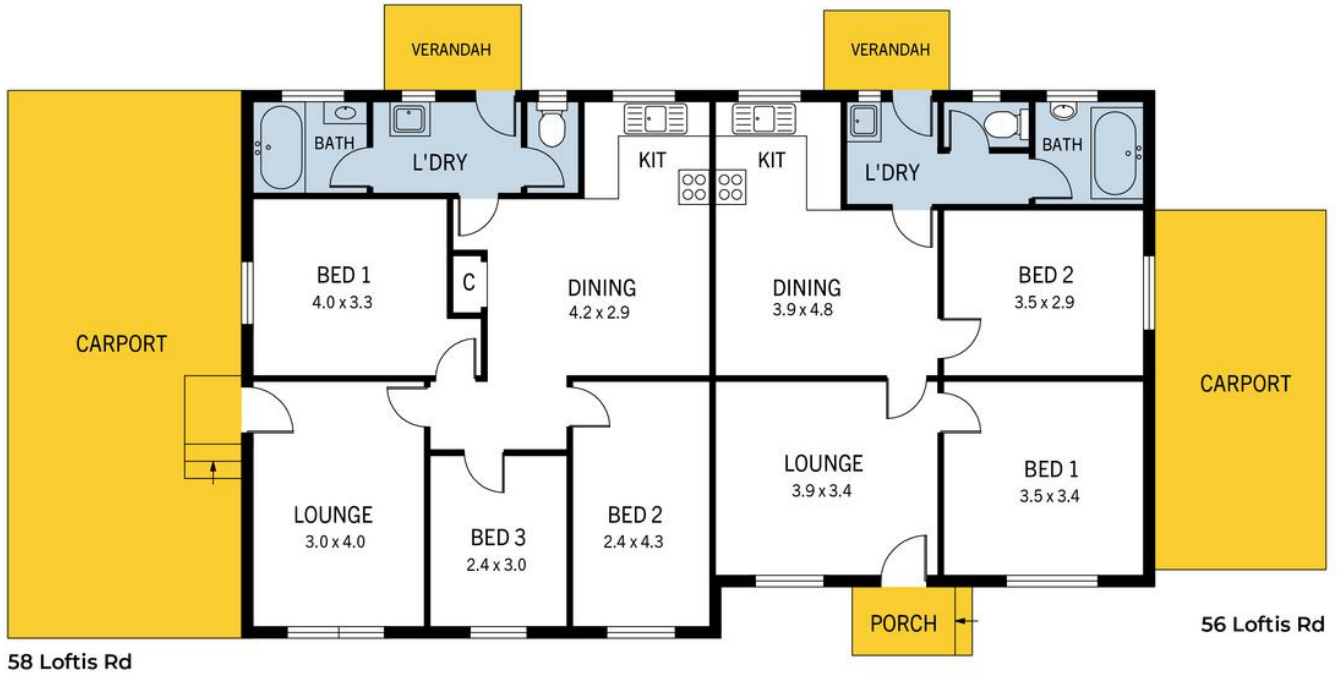

56+58 Loftis Road, Elizabeth Downs

DISCLAIMER: Floorplan and area calculation are approximate and for illustration purposes only.

Produced by **Property Portraits**

58 Loftis Rd	77m ²
Exterior	43m ²
Shed	25m ²
56 Loftis Rd	65m ²
Exterior	25m ²

235m²
TOTAL