



Elizabeth Bay, 4/27-29 Elizabeth Bay Road

Charming Art Deco Retreat in the Heart of Elizabeth Bay

Nestled in one of Elizabeth Bay's most coveted tree-lined streets, this beautifully maintained one-bedroom apartment at 4/29 Elizabeth Bay Road offers a charming blend of timeless Art Deco character and contemporary functionality. From the moment you step inside, the home welcomes you with polished timber floors, soaring ornate ceilings, and a sense of calm that comes from its elevated position.

The generous living and dining area flows effortlessly, with large windows that frame views of the surrounding rooftops and city skyline. The separate kitchen is modern and efficient, featuring crisp white cabinetry, sleek benchtops, and quality appliances, including an electric cooktop and built-in oven. A well-proportioned bedroom enjoys soft natural light and built-in storage, while the modern bathroom continues the home's clean and classic appeal.

This apartment is set within a boutique, well-maintained building that captures the

1 1 0

For Sale
For Sale | \$620,000

View
By Appointment

Contact
Aaron Del Monte
0447 144 434
aaron.delmonte@ljhdoublebay.com

Kevin O'Kane
0449 960 940
kevin@ljhdoublebay.com

LJ Hooker

Disclaimer: All information contained therein is gathered from relevant third parties sources. We cannot guarantee or give any warranty about the information provided. Interested parties must rely solely on their own enquiries.

LJ Hooker Double Bay
(02) 9185 2816

elegance of a bygone era, while sitting just moments from the vibrant dining and café scene of Potts Point. With easy access to harbourside parks, transport links, and the CBD, this is the perfect home or investment in a highly sought-after location.

More About this Property

Property ID	26VHYY
Property Type	Apartment
Including	Study

Aaron Del Monte 0447 144 434
Managing Director | aaron.delmonte@ljhdoulebay.com
Kevin O'Kane 0449 960 940
Property Partner | kevin@ljhdoulebay.com

LJ Hooker Double Bay (02) 9185 2816
38 Ocean Street, WOOLLAHRA NSW 2025
doublebay.ljhooker.com.au | admin@ljhdoulebay.com



Disclaimer: All information contained therein is gathered from relevant third parties sources. We cannot guarantee or give any warranty about the information provided. Interested parties must rely solely on their own enquiries.

LJ Hooker Double Bay
(02) 9185 2816

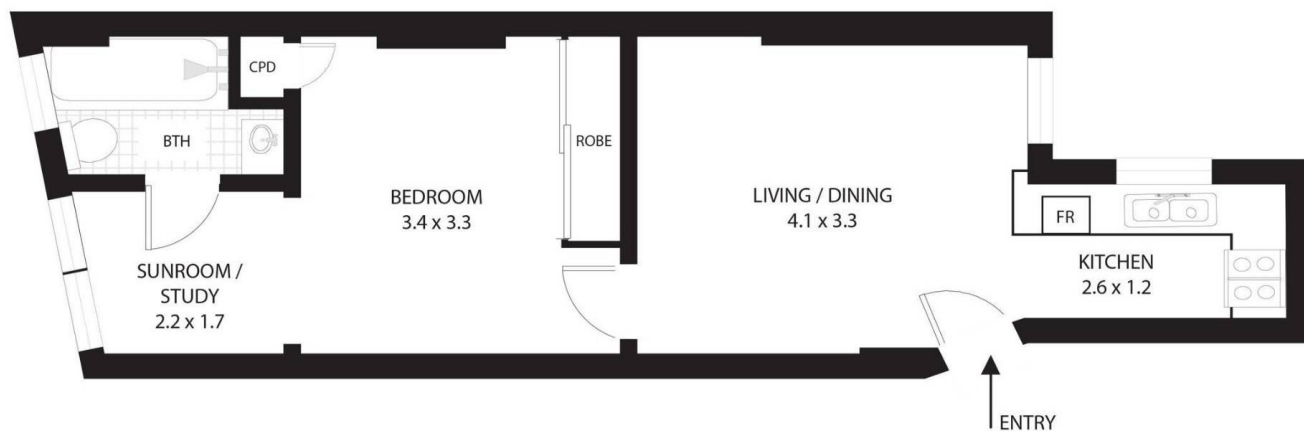

4/29 Elizabeth Bay Road, Elizabeth Bay

This floorplan is provided for illustrative purposes only and is not to scale. All measurements, dimensions, and areas are approximate and subject to change. No responsibility is taken for any errors, omissions, or misstatements. Prospective buyers should make their own inquiries and rely on their own investigations to confirm the accuracy of the information provided.

