

21 Avonmore Street, Edens Landing

Big Block Living with Space, Style & Room to Entertain

Eileen Chen and Benjamin Waite alongside LJ Hooker Beenleigh are proud to present this spacious and exceptionally versatile family home positioned on a generous 1005sqm block in the heart of Edens Landing. Designed with larger families and work-from-home lifestyles in mind, this well-laid-out residence offers five bedrooms, multiple well-separated living zones, and the flexibility to adapt to your changing needs. Whether you're accommodating growing teenagers, running a small home business, or simply craving extra space to spread out, this home delivers the perfect balance of comfort, practicality, and lifestyle appeal. With a modern kitchen, solar power, expansive outdoor entertaining, and plenty of room both inside and out, this is a property that truly caters to busy modern living.

Property Features:

- 5 spacious bedrooms
- Master bedroom complete with a walk-in robe
- 2 well-appointed bathrooms
- Multiple separate living zones offering space and privacy for the whole family
- Well-designed floor plan ideal for larger families or flexible living
- Separate study/home office (5th bedroom) perfect for working from

5 2 2

FOR SALE
\$999,000- \$1,099,000

VIEW
Sat 20th Jun @ 9:00AM - 9:30AM

AGENTS
Eileen Chen
0452 352 547
eileen.chen@ljhbeenleigh.com.au

Benjamin Waite
0431 265 700
benjamin.waite@ljhbeenleigh.com.au

AGENCY
LJ Hooker Property Collective
(07) 3807 7900

All information contained therein is gathered from relevant third parties sources.
We cannot guarantee or give any warranty about the information provided.
Interested parties must rely solely on their own enquiries.

LJ Hooker

home or running a small business

- Expansive 1005sqm block with plenty of outdoor space
- 2 secure carports for convenient parking
- Large undercover patio/alfresco area perfect for entertaining or relaxing year-round
- Spacious modern kitchen with ample storage and bench space
- Separate living and dining areas for flexible family living
- Ceiling fans and split system air conditioning for year-round comfort
- Solar panels for improved energy efficiency
- Outdoor shed providing extra storage space
- Owner occupied and exceptionally well cared for throughout

Investment Snapshot:

- Rental appraisal: \$750 - \$775 per week approx.
- Strong appeal for large families and work-from-home buyers
- Flexible floor plan broadens tenant and buyer appeal
- Large land size offers excellent long-term value and future appeal
- Energy-efficient solar system helps reduce ongoing living costs
- Functional layout designed for comfortable everyday living and entertaining

Why Edens Landing?

Edens Landing continues to grow in popularity thanks to its family-friendly atmosphere, convenient location, and excellent connectivity. Positioned between Brisbane and the Gold Coast, residents enjoy easy access to the M1, nearby train stations, local schools, shopping centres, parks, and walking tracks. With a strong sense of community and plenty of everyday conveniences close by, it's easy to see why so many buyers are choosing to call Edens Landing home.

Big on space, smart in design, and built for modern family living - this is the kind of home that grows with you.

Contact Eileen Chen and Benjamin Waite today for more info.

Important: While every care has been taken in the preparation of the information contained in this marketing, LJ Hooker Beenleigh and its representatives will not be held responsible for any errors or omissions. All details are considered accurate at the time of printing, and interested parties should make and rely on their own enquiries to verify the information.

MORE DETAILS

Property ID 1XQ4GRF
Property Type House
Land Area 1005 m2
Including Study
Air Conditioning
Outdoor Entertaining
Built-in-Robes
Secure Parking
Fully Fenced
Solar Panels

Eileen Chen 0452 352 547

Sales and Marketing Specialist | eileen.chen@ljhbeenleigh.com.au

Benjamin Waite 0431 265 700

Principal & Licenced Real Estate Agent |
benjamin.waite@ljhbeenleigh.com.au

LJ Hooker Property Collective (07) 3807 7900

14-16 James Street, BEENLEIGH QLD 4207
propertycollective.ljhooker.com.au | bs0@ljhbeenleigh.com.au



All information contained therein is gathered from relevant third parties sources.
We cannot guarantee or give any warranty about the information provided.
Interested parties must rely solely on their own enquiries.

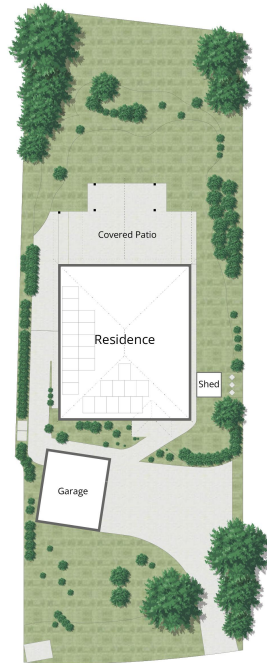

Site Plan



Floor Plan

21 AVONEMORE STREET, EDENS LANDING



138 m²
Internal

64 m²
External

202 m²
Total

EILEEN CHEN - 0452 352 547
BENJAMIN WAITE - 0431 265 700

Whilst every attempt has been made to ensure the accuracy of the floor plan contained here, measurements of doors, windows, rooms and any other item are approximate and no responsibility is taken for any error, omission, or misstatement. This plan is for illustrative purposes only and should only be used as such by any prospective purchaser.