



East Maitland, 7 Vista Parade

SMART PERFECT FOR A START!!

Set in a quiet street within one of East Maitland's most desirable pockets, this well-maintained 3-bedroom home delivers comfort, charm and convenience in equal measure. With impressive street appeal and a generous 640sqm+ block, it presents an ideal opportunity for first home buyers, young families or savvy investors.

The home features a classic Hardiplank and tile construction and is in very good condition throughout. Inside, polished timber floors and a soft neutral colour palette create a warm and welcoming atmosphere. The L-shaped lounge and dining area offers comfortable living with split system air conditioning, flowing into a modern laminate kitchen with ample storage and natural light.

Step outside to discover an enclosed sunroom with tranquil leafy views —a perfect place to relax or entertain year-round. An undercover BBQ area extends the entertaining space and overlooks the private backyard, ideal for kids or pets to enjoy.

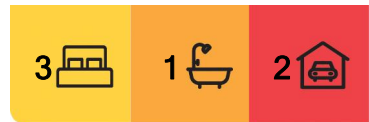

For Sale
\$725,000

View
ljhooker.com.au/1E6FF6H

Contact
Kane Bradley
0423 525 335
kbradley.maitland@ljhooker.com.au



LJ Hooker Maitland
(02) 4933 5511

Disclaimer: All information contained therein is gathered from relevant third parties sources. We cannot guarantee or give any warranty about the information provided. Interested parties must rely solely on their own enquiries.

A concrete driveway leads to a double powered garage, adding functionality and secure parking or storage.

Perfectly positioned, the home is just minutes from Stockland Green Hills, the Hunter Expressway and the new Maitland Hospital, combining lifestyle and location in one compelling package.

Whether you're looking to move straight in or invest in a high-demand suburb, this East Maitland gem is ready to impress.

Proudly marketed by LJ Hooker Maitland, please call exclusive agent Kane Bradley 0423 525 335 7 days for all inspections & further information.

All information contained herein is gathered from sources we deem to be reliable. However, we cannot guarantee its accuracy and interested persons should rely on their own enquiries.

More About this Property

Property ID	1E6FF6H
Property Type	House
Land Area	641 m2
Including	Air Conditioning Close to Shops Close to Transport Liveability

Kane Bradley 0423 525 335
Director | kbradley.maitland@ljhooker.com.au

LJ Hooker Maitland (02) 4933 5511
24 Ken Tubman Drive, MAITLAND NSW 2320
maitland.ljhooker.com.au | maitland@ljhooker.com.au



LJ Hooker Maitland
(02) 4933 5511

Disclaimer: All information contained therein is gathered from relevant third parties sources. We cannot guarantee or give any warranty about the information provided. Interested parties must rely solely on their own enquiries.

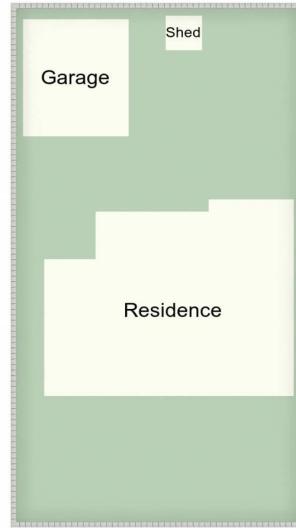
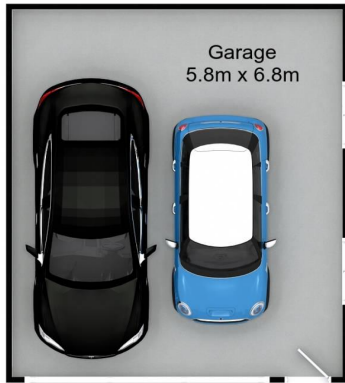

Site Plan
(Not to Scale)



7 Vista Pde, East Maitland

All information contained herein is gathered from sources we deem reliable. However, we cannot guarantee its accuracy and act as a messenger only in passing on the details. Interested parties should rely on their own inquiries and the contract for sale. The floor plans are artist's impressions only. The site plan is not to scale.



LJ Hooker Maitland
(02) 4933 5511

Disclaimer: All information contained therein is gathered from relevant third parties sources. We cannot guarantee or give any warranty about the information provided. Interested parties must rely solely on their own enquiries.