





71 David Street, East Devonport

Great for Families

Located in East Devonport this family home would make an excellent investment property or entry into the market. It features three bedrooms upstairs, the main has its own toilet and vanity. All bedrooms have built-in robes. This is a good size home with two decent sized living areas to allow you to have your own space and a separate downstairs room that would be great for a kids play area or rumpus room. A separate dining room has access out to the large timber deck and the Kitchen has been updated from original. The Bathroom has also been updated from original and includes both shower and separate bath. The property has a Colorbond Garage or workshop and is in a quiet no through street close to schools, shops and transport.

- The information contained herein has been supplied to us by sources which are considered reliable and we have no reason to doubt its accuracy. However, all interested parties should make their own enquiries to verify this information to be correct. All measurements are approximate and are for illustrative purposes only.

3  1  1 

FOR SALE

Offers Over \$520,000

VIEW

Sat 11th Jul @ 10:45AM - 11:15AM

AGENTS

Michael Ziegler
0409 764 219
michael.ziegler@ljhooker.com.au

Tyla Pyke
0439 228 888
tyla.pyke@ljhooker.com.au

AGENCY

LJ Hooker Devonport
0473 104 200

MORE DETAILS

Property ID 8VVHVM
Property Type House
Land Area 721 m2

Michael Ziegler 0409 764 219

Licensee | michael.ziegler@ljhooker.com.au

Tyla Pyke 0439 228 888

Property Representative | tyla.pyke@ljhooker.com.au

LJ Hooker Devonport 0473 104 200

16 Don Road, DEVONPORT TAS 7310

devonport.ljhooker.com.au | devonport@ljhooker.com.au



All information contained therein is gathered from relevant third parties sources.
We cannot guarantee or give any warranty about the information provided.
Interested parties must rely solely on their own enquiries.

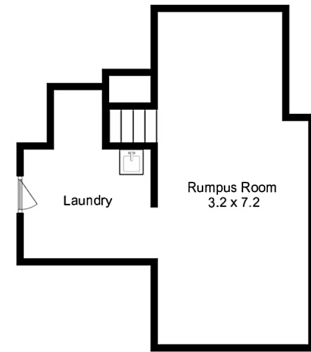

Lower Level



71 David St, East Devonport

This plan is a sketch for illustration only.
 All measurements are internal and approximate (in metres).
 Outbuildings / exterior elements not in actual position.