



Eagleby, 28/147-153 Fryar Road

A Hidden Gem in Eagleby - Effortless Comfort and Convenience!

Nestled in the heart of Eagleby, this delightful townhouse is the ideal blend of comfort, style, and convenience! Welcome to your new haven at 28/147-153 Fryar Road, where sleek design meets effortless functionality. With bright interiors, modern features, and a charming outdoor space, this residence promises low-maintenance living perfect for families, professionals, and investors alike.

Eagleby offers the best of both worlds: a tranquil suburban lifestyle with easy access to urban amenities. This thriving community boasts a variety of schools, parks, and shopping options, all just minutes away. Situated between Brisbane and the Gold Coast, Eagleby provides a central location that allows you to enjoy city excitement, stunning beaches, and everything in between. This townhouse truly capitalizes on Eagleby's welcoming, connected vibe.

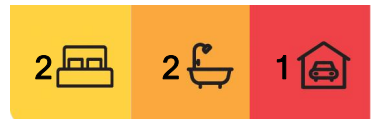

For Sale
Open Home Canceled - Under Contract

View
l.jhooker.com.au/1W5NGRF

Contact
Benjamin Waite
0431 265 700
sales1@ljhbeenleigh.com.au

Jackson Burley
0432 576 220
sales3@ljhbeenleigh.com.au



LJ Hooker Beenleigh
(07) 3807 7900

Disclaimer: All information contained therein is gathered from relevant third parties sources. We cannot guarantee or give any warranty about the information provided. Interested parties must rely solely on their own enquiries.

Your New Property Features:

- **Open-Plan Living Area:** Spacious and inviting, the living and dining area is flooded with natural light, ideal for relaxation or entertaining guests. Tiled flooring and split-system air conditioning ensure comfort all year round.
- **Modern Kitchen:** The kitchen offers ample cabinetry, a double sink, and a sleek breakfast bar perfect for casual meals or morning coffees. Neutral tones and durable countertops create a versatile space that's as functional as it is stylish.
- **Spacious Master Bedroom:** A restful retreat, the master bedroom includes built-in wardrobes, air conditioning, private ensuite, and large windows that welcome plenty of light.
- **Additional Bedrooms and Bathrooms:** With an additional bedroom featuring a ceiling fan and built-in storage, and main bathroom, this home is tailored for comfort and convenience.
- **Outdoor Entertaining Area:** Step outside to a fully fenced private courtyard featuring a low-maintenance garden with lush greenery. This space is perfect for alfresco dining or unwinding in your own piece of paradise.
- **Garage and Parking:** Secure, single-car garage with internal access provides ease and security for busy lifestyles.

Your Investment Figures:

- **Rental Appraisal:** Expected rental income ranges from \$430 to \$470 per week, making this property an excellent investment opportunity.
- **Body Corporate:** Annual contributions are \$2,839.19 for the Administrative Fund.
- **Rates Approx.:** \$1000 per Quarter including Water.

This townhouse in Eagleby is more than just a home; it's an opportunity to invest in a lifestyle filled with convenience, connection, and charm. Don't miss your chance to view this lovely property-reach out today to schedule a visit or discuss how it could be the perfect addition to your portfolio!

More About this Property

Property ID	1W5NGRF
Property Type	Townhouse
House Size	99 m ²
Land Area	148 m ²
Including	Ensuite Toilets (2)

Benjamin Waite 0431 265 700

Licensed Real Estate Agent | sales1@ljhbeenleigh.com.au

Jackson Burley 0432 576 220

Assistant to Benjamin Waite | sales3@ljhbeenleigh.com.au

LJ Hooker Beenleigh (07) 3807 7900

14-16 James Street, BEENLEIGH QLD 4207

beenleigh.ljhooker.com.au | bso@ljhbeenleigh.com.au



LJ Hooker Beenleigh
(07) 3807 7900

Disclaimer: All information contained therein is gathered from relevant third parties sources. We cannot guarantee or give any warranty about the information provided. Interested parties must rely solely on their own enquiries.

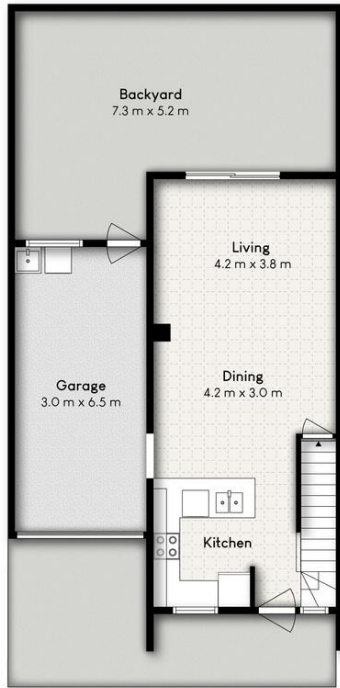

LOWER LEVEL



UPPER LEVEL

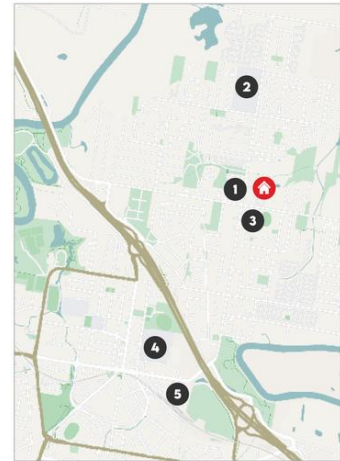

LOCATION

- 1 | EAGLEBY SHOPPING CENTRE
- 2 | EAGLEBY STATE SCHOOL
- 3 | EAGLEBY SOUTH STATE SCHOOL
- 4 | BEENLEIGH STATE HIGH SCHOOL
- 5 | BEENLEIGH MARKETPLACE

28/147-153 FRYAR ROAD, EAGLEBY

🛏️ 2 🚿 2 🚗 1

Internal: 99m² | External: 49m² | Total: 148m²

Whilst every attempt has been made to ensure the accuracy of the floor plan contained here, measurements of doors, windows, rooms and any other item are approximate and no responsibility is taken for any error, omission, or misstatement. This plan is for illustrative purposes only and should only be used as such by any prospective purchaser.

