



## Eagleby, 7 Olympic Court

Spacious Family Home with Solar, Sheds & Big Block Lifestyle!

Welcome to 7 Olympic Court, Eagleby-where space, functionality, and lifestyle come together seamlessly.

Perfect for families, first-home buyers, and investors alike, this well-maintained home offers generous living spaces, outdoor entertaining options, and the added bonus of a fully fenced, flat 607m<sup>2</sup> block. With solar power already installed, multiple sheds for all your hobbies and storage needs, and a huge alfresco area for year-round entertaining, this property is ready for you to move in and enjoy.

### Why You'll Love Eagleby

Eagleby is one of the Logan region's most sought-after suburbs, perfectly positioned between Brisbane and the Gold Coast. With excellent local schools, parks, public transport, and shopping centres close by, it's a suburb that delivers lifestyle convenience and strong long-term growth. Whether you're settling down or expanding your investment



**Disclaimer:** All information contained therein is gathered from relevant third parties sources. We cannot guarantee or give any warranty about the information provided. Interested parties must rely solely on their own enquiries.

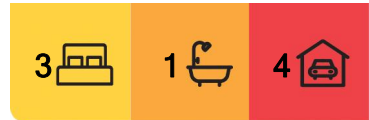

**For Sale**  
Offers over \$689,000

**View**  
[ljhooker.com.au/1WPCGRF](http://ljhooker.com.au/1WPCGRF)

**Contact**  
**Benjamin Waite**  
0431 265 700  
[sales1@ljhbeenleigh.com.au](mailto:sales1@ljhbeenleigh.com.au)

**Jackson Burley**  
0432 576 220  
[sales3@ljhbeenleigh.com.au](mailto:sales3@ljhbeenleigh.com.au)

**LJ Hooker Beenleigh**  
**(07) 3807 7900**

portfolio, Eagleby offers the perfect mix of comfort and opportunity.

#### Property Highlights:

- 3 Bedrooms with Built-ins & Ceiling Fans: Comfortable, light-filled rooms offering a peaceful retreat for the whole family.
- Functional Open-Plan Living: Bright and airy dining and living areas designed for effortless everyday living.
- Well-Equipped Kitchen: Featuring ample bench space and cabinetry, perfectly suited for creating home-cooked meals with ease.
- Neat Bathroom & Separate WC: Clean and functional with modern conveniences.
- Internal Laundry with Outdoor Access: A practical space with easy access to the backyard.
- Expansive Covered Alfresco (13m x 3.5m): An outstanding outdoor zone perfect for family gatherings, weekend barbecues, or simply relaxing in the fresh air.
- Triple Shed Setup: Includes a massive 6m x 6m powered shed plus two additional garden sheds-ideal for storage, hobbies, or a workshop.
- Drive-through Carport with Side Access: Convenient and secure parking with direct access to the backyard.
- Fully Fenced 643m<sup>2</sup> Block: A safe and spacious environment for children and pets, with beautifully maintained lawns and gardens.
- Secure Sliding Gate with Driveway Access: Provides privacy and peace of mind for the whole family.
- Solar System Installed: Enjoy immediate savings on your energy bills with the added potential to expand.

#### Investment Snapshot:

- Rental Appraisal: \$550-\$590 per week
- Council Rates: Approx. \$850 per quarter (subject to confirmation)

This is a home that offers immediate comfort, lifestyle enjoyment, and future potential-all in a quiet, family-friendly court. Don't miss your chance to secure this fantastic property!

## More About this Property

<b>Property ID</b>	1WPCGRF
<b>Property Type</b>	House
<b>House Size</b>	215 m <sup>2</sup>
<b>Land Area</b>	643 m <sup>2</sup>
<b>Including</b>	Toilets (1)

#### **Benjamin Waite 0431 265 700**

Licensed Real Estate Agent | sales1@ljhbeenleigh.com.au

#### **Jackson Burley 0432 576 220**

Assistant to Benjamin Waite | sales3@ljhbeenleigh.com.au

#### **LJ Hooker Beenleigh (07) 3807 7900**

14-16 James Street, BEENLEIGH QLD 4207

beenleigh.ljhooker.com.au | bso@ljhbeenleigh.com.au



**LJ Hooker Beenleigh**  
**(07) 3807 7900**

**Disclaimer:** All information contained therein is gathered from relevant third parties sources. We cannot guarantee or give any warranty about the information provided. Interested parties must rely solely on their own enquiries.



Site: 643m<sup>2</sup>

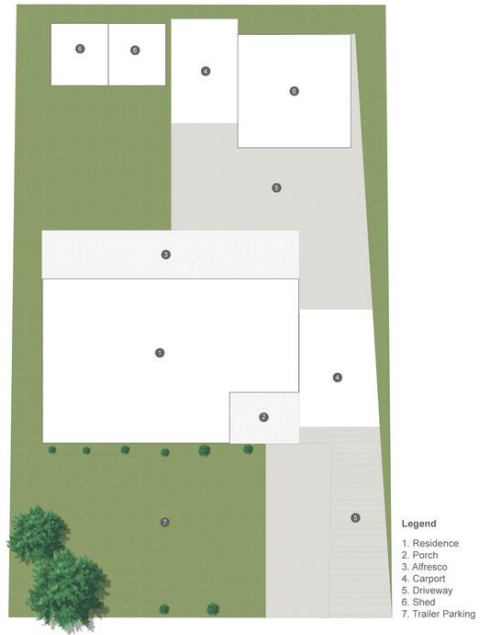

**7 OLYMPIC COURT, EAGLEBY**



Internal: 82m<sup>2</sup> | External: 133m<sup>2</sup> | Total: 215m<sup>2</sup>

Whilst every attempt has been made to ensure the accuracy of the floor plan contained here, measurements of doors, windows, rooms and any other item are approximate and no responsibility is taken for any error, omission, or misstatement. This plan is for illustrative purposes only and should only be used as such by any prospective purchaser.

