

1907/241 Harbour Esplanade, Docklands

Designed to Breathe: Light, Space & Harbour Views at 1907/241 Harbour Esplanade

Step inside this thoughtfully crafted Docklands apartment, where every room feels connected-to the outdoors, to the light, and to the rhythm of waterfront living. Please note, this property is currently tenanted, with the occupant on a month-by-month lease arrangement.

The layout is built around how you actually live. A spacious living zone opens onto a generous balcony-not just an afterthought, but a true extension of your indoor space. Whether it's morning coffee or evening drinks, the harbour becomes part of your everyday.

The separate dining area sits comfortably off the kitchen, creating a natural divide between entertaining and relaxation. Both bedrooms are generously proportioned with built-in robes, offering peaceful retreats away from the living zones.

Practical touches matter here too: a dedicated laundry, powder room, and kitchen with dishwasher are all thoughtfully integrated. And with two secure car spaces, this is a home that works as hard as you do.

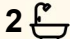
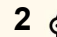
2  2  2 

FOR SALE
\$750,000 - \$800,000

VIEW
By Appointment

AGENTS
John Meng
0430 808 998
jmeng.cityresmelbourne@ljhooker.com.au

AGENCY
LJ Hooker City Residential
(03) 9600 2166

All information contained therein is gathered from relevant third parties sources.
We cannot guarantee or give any warranty about the information provided.
Interested parties must rely solely on their own enquiries.

 **LJ Hooker**

Set on Harbour Esplanade, you're moments from trams, waterfront dining, and the everyday energy of Docklands.

MORE DETAILS

Property ID	PHFHC2
Property Type	Unit
Including	Air Conditioning
	Close to Schools
	Close to Shops
	Close to Transport

John Meng 0430 808 998

Principal, Managing Director, OIEC |
jmeng.cityresmelbourne@ljhooker.com.au

LJ Hooker City Residential (03) 9600 2166

Upper Ground Floor, 439-445 Lonsdale St, MELBOURNE VIC 3000
cityresmelbourne.ljhooker.com.au |
cityresmelbourne@ljhooker.com.au



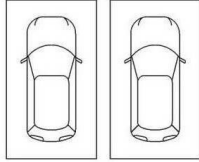
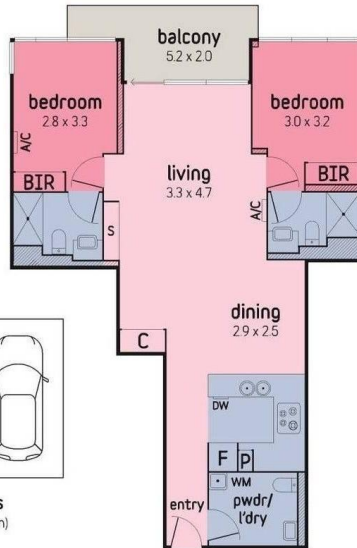

carspaces
(not in position)

241
harbour esplanade,
docklands

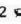
2  2  2 