



28/14-22 Lipscombe Road, Deception Bay

## Convenient, Low-Maintenance Living!

Positioned in a highly convenient location close to local shops, schools, and essential amenities, this neat and tidy townhouse offers a fantastic opportunity for first-home buyers, downsizers, or investors seeking a move-in-ready property.

Inside, the home presents a well-kept interior designed for comfortable, low-maintenance living. The light-filled living area creates a warm and inviting space to relax or entertain, flowing seamlessly through to a practical kitchen equipped with ample storage and workspace to meet your everyday needs.

The townhouse features two well-proportioned bedrooms, each offering a comfortable retreat, serviced by a centrally located bathroom that is both functional and easy to maintain.

Adding to the appeal is the single car accommodation, providing convenience and peace of mind, along with the overall low-upkeep nature of the property-perfect for those with a busy lifestyle or anyone looking to simplify their day-to-day living.

With everything you need just moments away, including shops,

2 1 1

**FOR SALE**  
Under Contract

### AGENTS

Danny Mailer  
0439 710 862  
[danny@ljhookerredcliffe.com.au](mailto:danny@ljhookerredcliffe.com.au)

Leah Whetton  
0436 817 658  
[Leah@ljhookerredcliffe.com.au](mailto:Leah@ljhookerredcliffe.com.au)

### AGENCY

LJ Hooker Redcliffe  
(07) 3897 5000

All information contained therein is gathered from relevant third parties sources.  
We cannot guarantee or give any warranty about the information provided.  
Interested parties must rely solely on their own enquiries.

**LJ Hooker**

schools, and transport options, this property combines lifestyle and location with ease. Whether you're looking to move straight in or add a solid asset to your portfolio, this townhouse presents an excellent opportunity not to be missed.

## MORE DETAILS

Property ID	20FWGWZ
Property Type	Townhouse
Land Area	132 m2

### Danny Mailer 0439 710 862

Principal | [danny@ljhookerredcliffe.com.au](mailto:danny@ljhookerredcliffe.com.au)

### Leah Whetton 0436 817 658

| [Leah@ljhookerredcliffe.com.au](mailto:Leah@ljhookerredcliffe.com.au)

### LJ Hooker Redcliffe (07) 3897 5000

45 Redcliffe Parade, REDCLIFFE QLD 4020

[redcliffe.ljhooker.com.au](http://redcliffe.ljhooker.com.au) | [reception@ljhookerredcliffe.com.au](mailto:reception@ljhookerredcliffe.com.au)



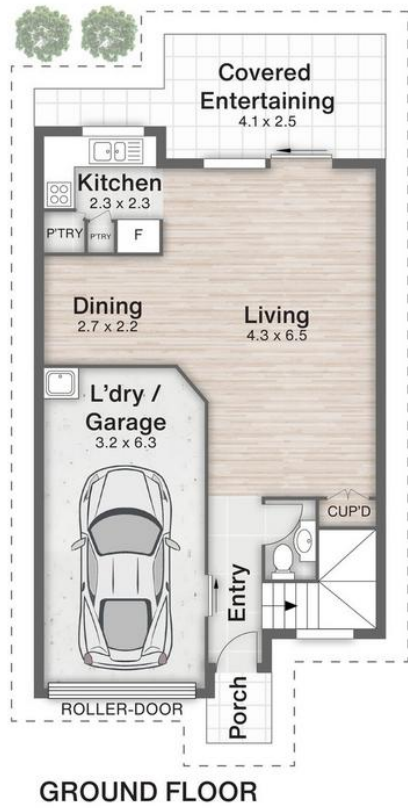

28/22 Lipscombe Road **DECEPTION BAY**

2 | 1 | 1 | 127m<sup>2</sup>



All dimensions are approximate; they are subject to errors and inaccuracies and no liability will be accepted. Plans are shown for marketing purposes only.