



Darlinghurst, 26 Thomson Street

A Timeless Victorian Masterpiece in Darlinghurst's Heart

26 Thomson St, a stunning Victorian terrace completed in 1867, nestled in a private cul-de-sac on one of Darlinghurst's most sought-after streets. Behind its flawless heritage facade lies a home that marries classic charm with reimagined modern living, offering breathtaking, unobstructed views of the Sydney city skyline-including the iconic Centrepont Tower-and a vibrant city-fringe lifestyle that's simply unmatched. Through the front door, you're greeted by an open-plan living and dining space that exudes classical elegance, warmed by a cosy fireplace and bathed in superb natural light thanks to its architecturally designed layout. This flows effortlessly into a high-spec kitchen, where heated flooring, stainless steel Miele refrigeration, and premium cabinetry elevate every culinary experience. Beyond, a tranquil courtyard with a built-in electric BBQ beckons for al fresco gatherings, leading to the hidden Thomson St community laneway-a rare and charming touch.

Ascend the stairs, where high-end oak floors with a hard-wax finish set a tone of understated luxury. The master bedroom is a true retreat, featuring a walk-in robe and



For Sale
Auction | Contact Agent

View
Thu 20th Mar @ 5:00PM - 5:45PM

Contact
Mark Matthews
0403 731 248
mark.matthews@ljhdoublbay.com

Fraser Clarkson
0400 435 439
fraser.clarkson@ljhdoublbay.com

LJ Hooker

LJ Hooker Double Bay
(02) 9185 2816

Disclaimer: All information contained therein is gathered from relevant third parties sources. We cannot guarantee or give any warranty about the information provided. Interested parties must rely solely on their own enquiries.

terrace doors that open to a wide balcony showcasing that dazzling skyline panorama. The second double bedroom offers a peaceful outlook, ideal as a guest room, nursery, or home office. Architectural cabinetry throughout provides surprising storage, while a clever European laundry cupboard and a bathroom with integrated facilities add practicality without compromising style.

Period details like soaring ceilings and original fireplaces nod to its 1860's origins, while radiated heating ensures year-round comfort. The home's potential soars even higher with exciting, unexecuted plans for a third floor-envision a luxurious master suite, a versatile study, and a second bathroom, ready to tailor to your dreams. All this, in a remarkably serene setting just a short stroll from Victoria Street's renowned eateries and minutes from the CBD.

Whether you're a professional craving urban sophistication, a couple seeking a blend of heritage and modernity, or an investor eyeing a property with endless possibilities, 26 Thomson St is your chance to own a piece of Darlinghurst's soul. This isn't just a home-it's a lifestyle statement.

More About this Property

Property ID	257HYY
Property Type	House
Land Area	65 m ²
Including	Toilets (1) Balcony Deck Dishwasher Built-in-Robes Area Views City Views Close to Schools Close to Shops Close to Transport Creative Liveability

Mark Matthews 0403 731 248

Senior Property Partner | mark.matthews@ljhdoublingbay.com

Fraser Clarkson 0400 435 439

Property Partner | fraser.clarkson@ljhdoublingbay.com

LJ Hooker Double Bay (02) 9185 2816

38 Ocean Street, WOOLLAHRA NSW 2025

doublebay.ljhooker.com.au | admin@ljhdoublingbay.com

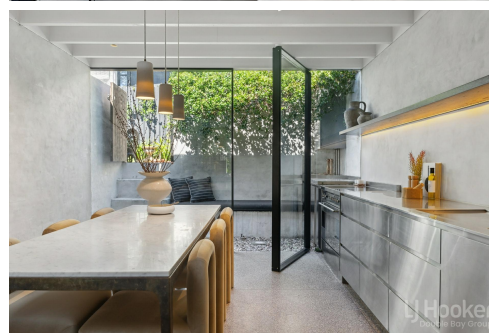

LJ Hooker

Disclaimer: All information contained therein is gathered from relevant third parties sources.

We cannot guarantee or give any warranty about the information provided. Interested parties must rely solely on their own enquiries.

LJ Hooker Double Bay
(02) 9185 2816

26 THOMSON STREET

DARLINGHURST

Private Community Lane access

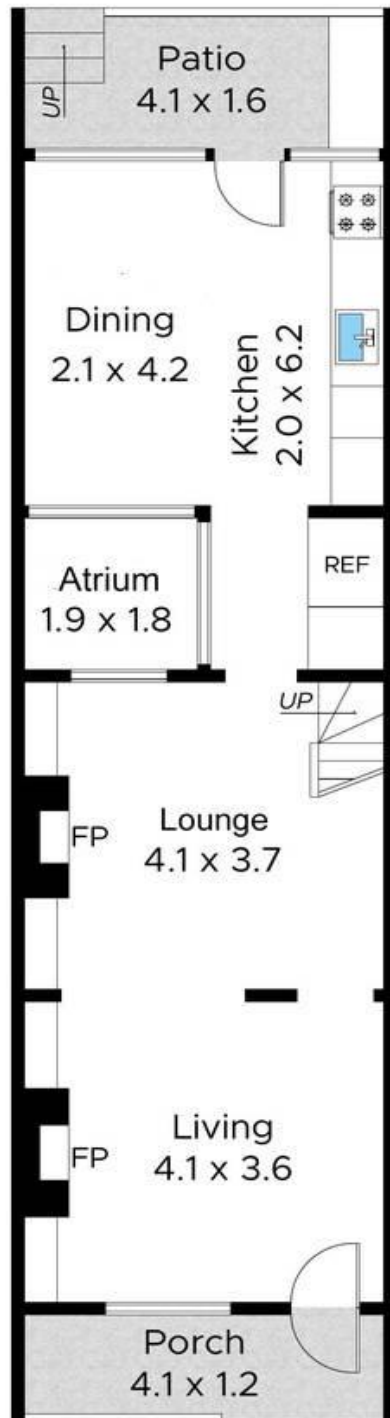

Ground Floor



First Floor

Indicative only. Dimensions are approximate. All information contained herein is gathered from sources we believe to be reliable.

However, we cannot guarantee its accuracy and interested persons should rely on their own enquiries.