

Cumberland Park, 23 Somerset Avenue

Attractive Bungalow In Popular Suburb, Auction
Saturday 25th November 2023 at 2:30pm. Price
guide \$1,300,000.

What a fabulous opportunity is presented here with this timeless character home
"Circa 1925" featuring all the features of a bygone era but with a modern touch.

Located in this leafy inner suburb of Adelaide with the highly desirable north
facing rear aspect and surrounded by other gorgeous character properties, it is
no wonder that it is a popular location with young families. Located within easy
reach of the Adelaide cbd, good transport and a host of educational choices.
Take your pick of Cabra Dominican College, Edwardstown, Black Forest or
Westbourne Park Primaries, Unley High, St Anthony's or Scotch College to name a
few. Plenty of restaurants, cafes and shopping at Hyde Park, Winston Avenue and

4 1 5

For Sale

AUCTION Saturday 25th November at
2:30pm

View

ljhooker.com.au/PMAGW0

Contact

Peter Hurcombe

0402 084 910

peter@ljhglenelgbrighton.com.au



Disclaimer: All information contained therein is gathered from relevant third parties sources.
We cannot guarantee or give any warranty about the information provided. Interested parties must rely solely on their own enquiries.

LJ Hooker Glenelg | Brighton
(08) 8294 6000

the Cumberland Park Shopping Precinct.

A host of open green space and recreational areas are perfect to keep everyone active. All this adds up to a lifestyle the envy of many.

What we love about this gorgeous family home

- 4 huge bedrooms or 3 plus study or second living area
- Generous open plan family and dining area with picture windows offering light and warmth
- Fully functional well-equipped kitchen with island bench and walk in pantry
- Good sized laundry and second toilet and vanity for guests
- Magnificent fireplaces to 3 of the bedrooms
- 3.1 metre ceilings, some with ornate features and cove cornices
- Stunning polished floorboards
- Timber fret to inviting wide hallway and entrance
- Reverse cycle ducted air conditioning and ceiling fans
- Lock up parking for 2 vehicles with auto roller door
- Further off-street vehicle storage for multiple cars or maybe a boat or van
- Workshop with pit; a classic!!
- Beautiful gardens to both rear and front areas or room for pool if you choose into the future
- Undercover alfresco area to enjoy a morning coffee

Property Details:

Council: City of Mitcham

Land Size 660sqm

Year Built: 1925

For further information please contact Peter Hurcombe.

Visit glenelgbrighton.ljhooker.com.au to view other LJ Hooker Glenelg | Brighton Listings.

Disclaimer: Neither the Agent nor the Vendor accept any liability for any error or omission in this advertisement.

Any prospective purchaser should not rely solely on 3rd party information



LJ Hooker Glenelg | Brighton
(08) 8294 6000

Disclaimer: All information contained therein is gathered from relevant third parties sources. We cannot guarantee or give any warranty about the information provided. Interested parties must rely solely on their own enquiries.

providers to confirm the details of this property or land and are advised to enquire directly with the agent in order to review the certificate of title and local government details provided with the completed Form 1 vendor statement.

RLA 279730

More About this Property

Property ID	PMAGW0
Property Type	House
Land Area	660 m²

Peter Hurcombe
Principal & Sales Consultant | peter@ljhglenelgbrighton.com.au

LJ Hooker Glenelg | Brighton (08) 8294 6000
76 Oaklands Road, SOMERTON PARK SA 5044
glenelgbrighton.ljhooker.com.au | rebecca@ljhglenelgbrighton.com.au



Disclaimer: All information contained therein is gathered from relevant third parties sources. We cannot guarantee or give any warranty about the information provided. Interested parties must rely solely on their own enquiries.

LJ Hooker Glenelg | Brighton
(08) 8294 6000

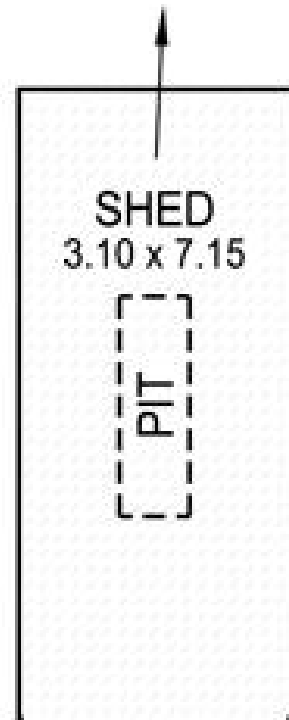
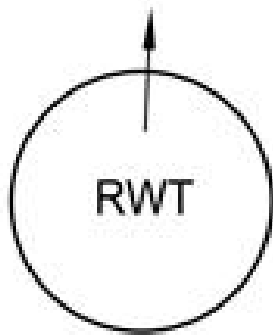

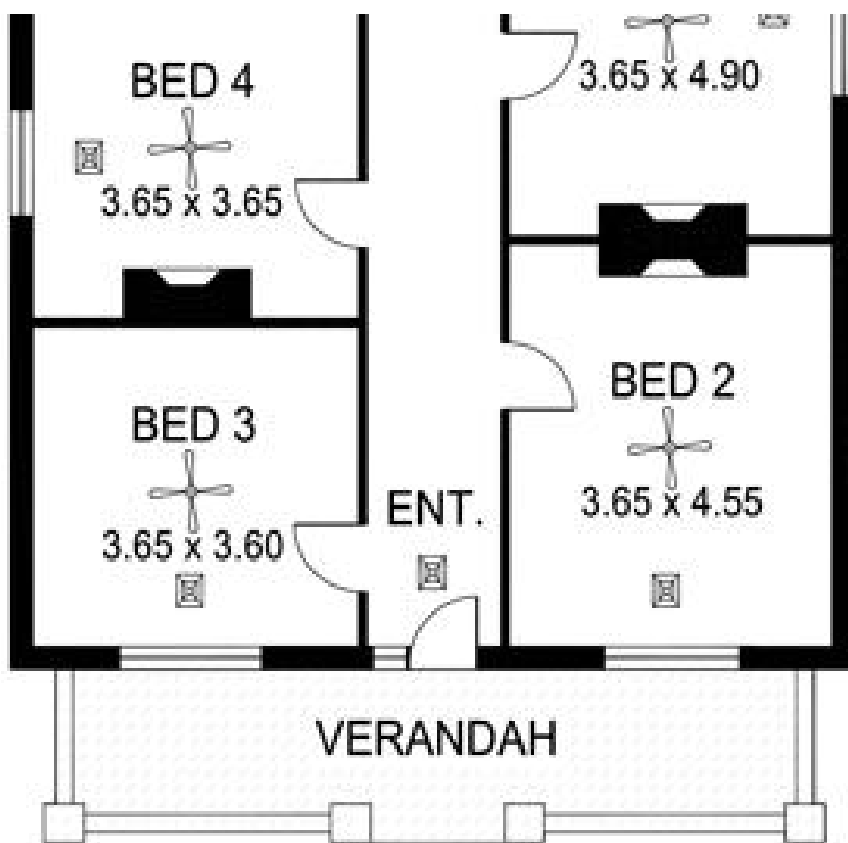

This drawing is for illustration purposes only.
 All measurements are approximate only and information
 intended to be relied upon should be independently verified.