



Croydon Park, 12 Pym Street

Your Blank Canvas Awaits - Solid 1950's Retro Home with Development Potential (STCC)

Set on an impressive 713sqm (approx.) allotment, this charming retro-style home in Croydon Park offers endless possibilities for first-home buyers, growing families, or savvy investors. Whether you're looking to move straight in, renovate, or extend (STCC), this property delivers space, flexibility, and potential.

Set on a generous allotment with a street frontage of 15.3m and 47.2m depth, in the heart of Croydon Park, this residence offers a solid foundation and an adaptable layout, ideal for anyone ready to roll up their sleeves and create something truly special. From first-time buyers eager to make their mark to renovators looking for their next project, this property delivers endless potential.

Key Features to Love:

* Cosy lounge with bay window, feature fireplace, decorative ceiling rose



Disclaimer: All information contained therein is gathered from relevant third parties sources. We cannot guarantee or give any warranty about the information provided. Interested parties must rely solely on their own enquiries.

SOLD

3 1 2

For Sale
Contact Agent

View
ljhooker.com.au/4YVYFE8

Contact
Josie Auricchio
0419 269 503
josiea@ljhookerwestlakes.com.au

Donna Farquhar
0461 363 915
donna@ljhookerwestlakes.com.au

LJ Hooker West Lakes | Henley Beach
(08) 8347 3666

- * Functional eat in kitchen with ample storage, intriguing secret delivery nook
- * Three spacious bedrooms, main with wardrobes, bedroom 1 & 2 with ceiling fans
- * Classic pink and black bathroom, separate shower and soaking tub
- * Reverse cycle split system air conditioning
- * Alarm system for added security
- * Single carport plus off-street parking for multiple vehicles
- * Expansive 713sqm (approx.) block

Perfectly located just 7.5km (approx.) from Adelaide CBD, this home provides easy access to public transport and a variety of amenities. Enjoy close proximity to Armada Arndale Shopping Centre for all your retail needs and dining options. Zoned for quality schools, including Woodville High School and Kilkenny Primary School, this location caters to families looking for convenience and opportunity.

For more information about the property, please contact Josie Aurrichio on 0419 269 503. Or Donna Farquhar 0461 363 915

Disclaimer:

Any prospective purchaser should not rely solely on 3rd party information providers to confirm the details of this property or land and are advised to enquire directly with the agent in order to review the certificate of title and local government details provided with the completed Form 1 vendor statement. All land sizes quoted are an approximation only and at the purchasers discretion to confirm. All information contained herein is gathered from sources we consider to be reliable. However, we cannot guarantee or give any warranty about the information provided. Interested parties must solely rely on their own enquiries. RLA 175322

More About this Property

Property ID	4YVYFE8
Property Type	House
Land Area	713 m2
Including	Air Conditioning Alarm Secure Parking

Josie Auricchio 0419 269 503

Sales & Property Management Specialist | josiea@ljhookerwestlakes.com.au

Donna Farquhar 0461 363 915

Property Specialist | donna@ljhookerwestlakes.com.au

LJ Hooker West Lakes | Henley Beach (08) 8347 3666

139 Tapleys Hill Road, SEATON SA 5023

westlakes.ljhooker.com.au | hello@ljhookerwestlakes.com.au



Disclaimer: All information contained therein is gathered from relevant third parties sources. We cannot guarantee or give any warranty about the information provided. Interested parties must rely solely on their own enquiries.

**LJ Hooker West Lakes | Henley Beach
(08) 8347 3666**

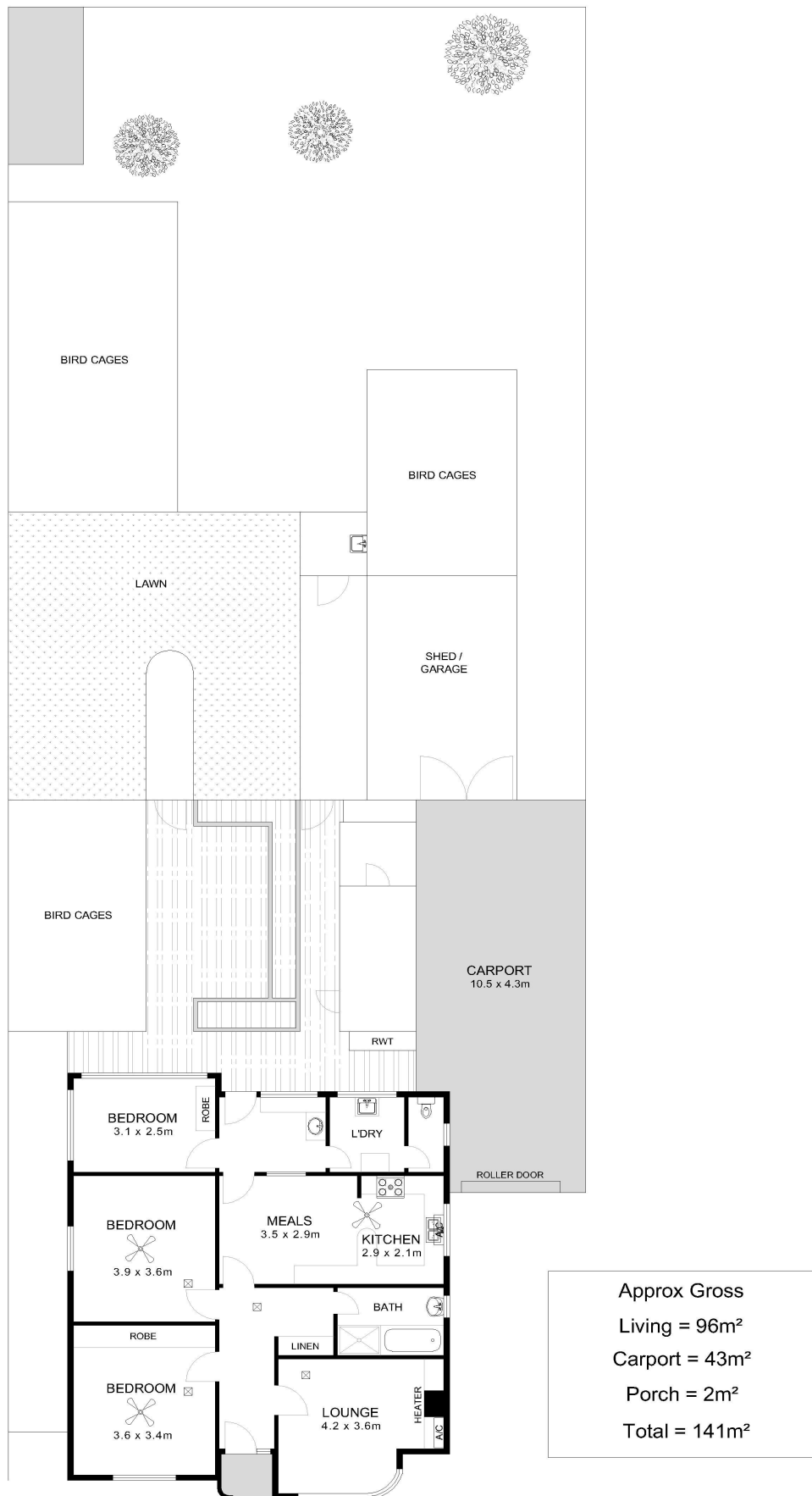

12 Pym Street Croydon Park

For illustrative purposes only. All measurements are approximate.
Andrew Waters Photography