



## Cranbourne North, 15 Ironwood Avenue

### 2 Year Old Family Home!

Bordering the magnificent Cranbourne golf course this 2-year-old 4 bedroom residence sets the standard for contemporary modern living.

Ironwood is a safe and secure place to settle down-perfect for families, couples and down-sizers seeking a sense of community in a beautiful and private location. With a rolling green stunning golf course outside your window!

From the moment you walk in you will feel at home, welcoming you to the formal lounge and Make your way through to the hostess kitchen with waterfall stone bench top, tiled splash back ,900mm oven, walk in pantry, dishwasher, and island bench overlooking the huge family and meals area as well as the separate enclosed alfresco room with a slider, that's 2 living areas!

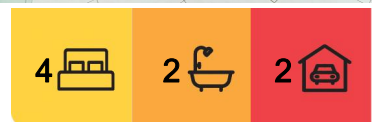

#### For Sale

\$730,000 - \$770,000

#### View

[ljhooker.com.au/47VEYFHE](http://ljhooker.com.au/47VEYFHE)

#### Contact

##### Sushant Gupta

0402 422 824

[sushant.gupta@ljhcasey.com.au](mailto:sushant.gupta@ljhcasey.com.au)

##### John Deo

0411 873 123

[john.deo@ljhcasey.com.au](mailto:john.deo@ljhcasey.com.au)



**Disclaimer:** All information contained therein is gathered from relevant third parties sources. We cannot guarantee or give any warranty about the information provided. Interested parties must rely solely on their own enquiries.

**LJ Hooker Hampton Park**  
**(03) 9702 8388**

Comprising of four bedrooms room's, the master bedroom with full-ensuite , an oversized shower and walk-in robe. Other bedrooms with built-in robes and central to the main bathroom, toilet and laundry.

Other features include 2.7 meter high ceiling, solar panel's Ducted Heating, Roller blinds, ceiling fan, Security Door's, split system Downlights throughout, NBN ready, 24.16sq Home & 375sq land size approx.

Location is everything and getting where you want is easy from Ironwood Estate:

- South Gippsland Hwy is directly accessible from Huon Park Road with easy access to Monash Fwy
- Bus Stop at entry to Ironwood
- Cranbourne Golf Club on your doorstep
- Merinda Park Train Station, Casey Recreation & Aquatic Centre and Casey Fields are just down the road
- Schools are only minutes away as are a variety of shopping centres
- 2 minute drive to Lyndhurst Secondary College and 3 minutes to Courteney Gardens Primary School

Only two year old with fantastic street appeal make this an opportunity not to be missed!

## More About this Property

**Property ID** 47VEYFHE

**Property Type** House

**Land Area** 375 m<sup>2</sup>

### Sushant Gupta

Senior Sales Agent | [sushant.gupta@ljhcasey.com.au](mailto:sushant.gupta@ljhcasey.com.au)

### John Deo

Director - Officer In Effective Control | [john.deo@ljhcasey.com.au](mailto:john.deo@ljhcasey.com.au)

### LJ Hooker Hampton Park (03) 9702 8388

Shop 20, Hampton Park Shopping Centre, 166 Somerville Road, HAMPTON PARK VIC 3976

[hamptonpark.ljhooker.com.au](http://hamptonpark.ljhooker.com.au) | [john.deo@ljhcasey.com.au](mailto:john.deo@ljhcasey.com.au)



**Disclaimer:** All information contained therein is gathered from relevant third parties sources. We cannot guarantee or give any warranty about the information provided. Interested parties must rely solely on their own enquiries.

**LJ Hooker Hampton Park  
(03) 9702 8388**



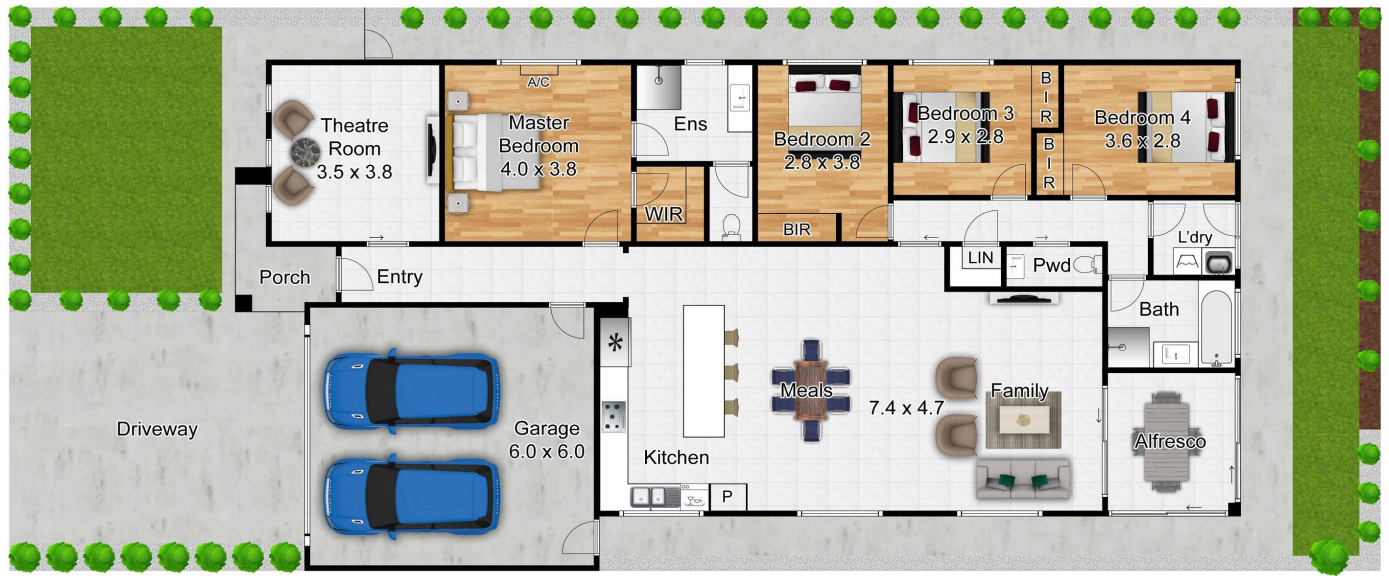

This drawing is for illustrative purposes only and while every effort has been made to maintain accuracy, prospective purchasers should check all information

