

5 Birdsall Avenue, Condell Park

4 4 7

Luxury Living in a Premier Condell Park Address

A showcase of modern design and superior craftsmanship, this full-brick, concrete-slab residence delivers uncompromised luxury and functionality in one of Condell Park's most desirable streets. Thoughtfully designed for families who love to entertain, the home combines generous proportions, high-end finishes, and effortless indoor-outdoor living.

From the soaring ceilings and herringbone timber floors to the bespoke kitchen and resort-style alfresco area, every detail has been considered to create a home of distinction and comfort.

Property Features:

- Full brick construction with concrete slab
- Expansive open-plan layout with soaring ceilings and sleek modern interiors
- Four generous upper-level bedrooms, each with built-in robes
- Four designer Parisi bathrooms, including a main with standalone tub, walk-in shower, and double vanity
- Luxurious master suite featuring custom built-in robe, study/makeup station, private balcony, and glass-encased ensuite with Italian Carrara Marble, double shower, and freestanding bath

FOR SALE

For Sale

AGENTS

Chedi Chidiac
0431 154 586
Chedi.BL@ljhooker.com.au

Sam Nader
0450 400 001
Sam.bm@ljhooker.com.au

AGENCY

LJ Hooker Bankstown
(02) 9708 2244

All information contained therein is gathered from relevant third parties sources. We cannot guarantee or give any warranty about the information provided. Interested parties must rely solely on their own enquiries.



- Gourmet kitchen with Super White stone benchtops, wood grain cabinetry, brushed brass accents, Miele cooktop, Smeg oven, and full butler's kitchen with additional Smeg appliances
- Multiple living zones including a family space with gas ceramic log fireplace
- Alfresco entertaining area with outdoor kitchenette, Beef Master 4-burner gas BBQ, Silver Travertine tiling, swimming pool, and full outdoor bathroom
- Secure 7-car basement garage with potential for home cinema or multi-purpose use
- Full laundry and guest bathroom on the lower level
- Statement Western Red Cedar entry door with Kaadas smart lock and fingerprint access
- Premium inclusions: Herringbone timber flooring, Ness alarm system, smart intercom, ducted zoned air conditioning, automated blackout blinds, and LED lighting throughout

A home of timeless quality, contemporary elegance, and family appeal - perfectly positioned in one of Condell Park's most sought-after locations.

DISCLAIMER: While LJ Hooker Bankstown Liverpool have taken all care in preparing this information and used their best endeavours to ensure that the information contained is true and accurate, we accept no responsibility and disclaim all liability in respect of any errors, inaccuracies, or misstatements contained herein. LJ Hooker Bankstown Liverpool urges prospective purchasers to make their own inquiries to verify the information contained herein.

MORE DETAILS

Property ID	10XYF8E
Property Type	DuplexSemi-detached
Land Area	348.7 m2
Including	Air Conditioning Ducted Cooling Ducted Heating Alarm Intercom Pool Dishwasher Outdoor Entertaining Built-in-Robes Secure Parking Fully Fenced Remote Garage

Chedi Chidiac 0431 154 586

Licensed Real Estate Agent | Chedi.BL@ljhooker.com.au

Sam Nader 0450 400 001

Director | Sam.bm@ljhooker.com.au

LJ Hooker Bankstown (02) 9708 2244

11 Marion Street, BANKSTOWN NSW 2200

bankstown.ljhooker.com.au | bankstown@ljhooker.com.au



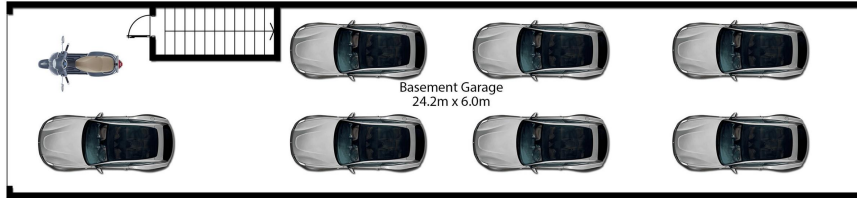
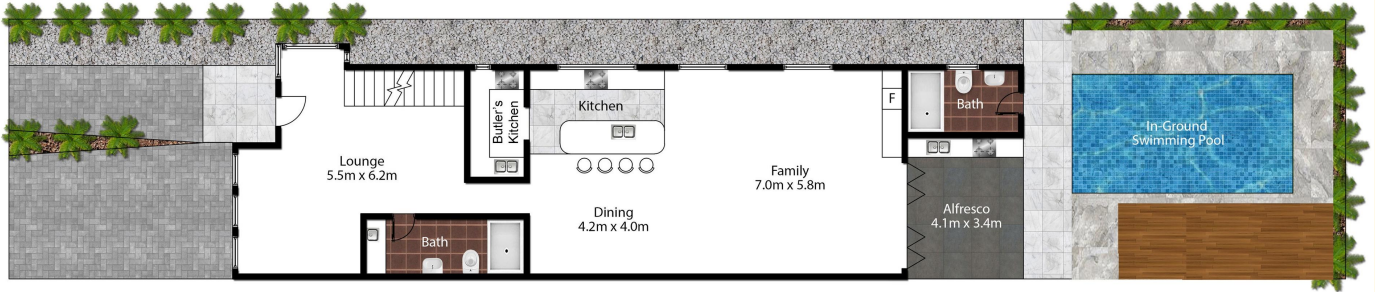
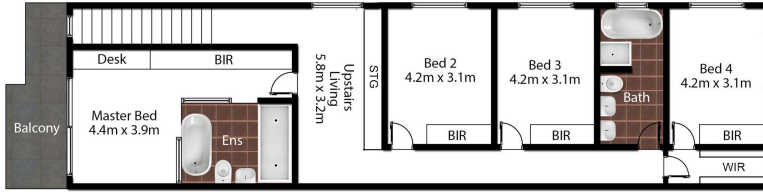

5 Birdsall Avenue, Condell Park

All reasonable care was taken in the preparation of this document, however no warranty is given to the accuracy of the information. Dimensions shown are approximate only.