



## Coasters Retreat, 38 Coasters Retreat

Beguiling Architecture - One of Pittwater's Most Beautiful Homes

Like a warm, reassuring hug you will feel like you are wrapped in the expansive and enticing views of The Basin and surrounding Ku-ring-gai Chase National Park... A magnificent waterway of stunning beaches and secluded bays.

Inspiring design and interiors by Ian Traill Architects following a comprehensive reimagining of the house both inside and out - the house has been fully upgraded with nothing extra to do apart from simply enjoy. The interconnecting pavilions with sensuous curved roofs that showcase the interesting zones and levels of the residence built to follow the natural landscape and connect to the grand outdoor entertainment decks. Each of the three pavilions are dedicated to different relaxed living functions.

One - Dining and entertaining

Two - Relaxation and parent's master suite



**Disclaimer:** All information contained therein is gathered from relevant third parties sources. We cannot guarantee or give any warranty about the information provided. Interested parties must rely solely on their own enquiries.

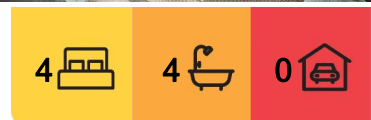

**For Sale**

One of Pittwater's Most Beautiful Homes

**View**

By Appointment

**Contact**

**Lachlan Elder**

0418 224 180

lelder@ljhmv.com.au

**Juliet Wills**

0438 418 833

jwills@ljhmv.com.au

**LJ Hooker Mona Vale**  
**(02) 9979 8000**

Three - Children's quarters

"The Studio" to cater for guests and has been designed to mirror the roof aesthetic of the home

The views are stunning. The aspect being northwest is perfect. The setting is world class.

The location accessed by boat is incredible. To tell you more will spoil the magic of first entering the doors of this very special and select offering, we invite you to experience and treat your senses and soul.

The Basin on Pittwater is one of the most beautiful anchorages in Australia, and bordering on the southern shore of The Basin, is Coasters Retreat. Coasters is accessible by Ferry from Palm Beach or boat from anywhere on Pittwater, it's a private and tranquil getaway with a perfect NW aspect and stunning water views over The Basin and its unique lagoon.

Disclaimer:

All information contained herewith, including but not limited to the general property description, price and the address, is provided to LJ Hooker Mona Vale by third parties. We have obtained this information from sources we believe to be reliable; however, we cannot guarantee its accuracy. The information contained herewith should not be relied upon and you should make your own enquiries and seek advice in respect of this property or any property on this website.

## More About this Property

|                      |                     |
|----------------------|---------------------|
| <b>Property ID</b>   | 2USTF6K             |
| <b>Property Type</b> | House               |
| <b>Land Area</b>     | 1252 m <sup>2</sup> |

**Lachlan Elder 0418 224 180**

Principal, Licensed Real Estate Agent | [lelder@ljhmv.com.au](mailto:lelder@ljhmv.com.au)

**Juliet Wills 0438 418 833**

Licensed Real Estate Agent | [jwills@ljhmv.com.au](mailto:jwills@ljhmv.com.au)

**LJ Hooker Mona Vale (02) 9979 8000**

3/18 Bungan Street, MONA VALE NSW 2103

[monavale.ljhooker.com.au](http://monavale.ljhooker.com.au) | [monavale@ljhmv.com.au](mailto:monavale@ljhmv.com.au)



**LJ Hooker Mona Vale**  
**(02) 9979 8000**

**Disclaimer:** All information contained therein is gathered from relevant third parties sources. We cannot guarantee or give any warranty about the information provided. Interested parties must rely solely on their own enquiries.

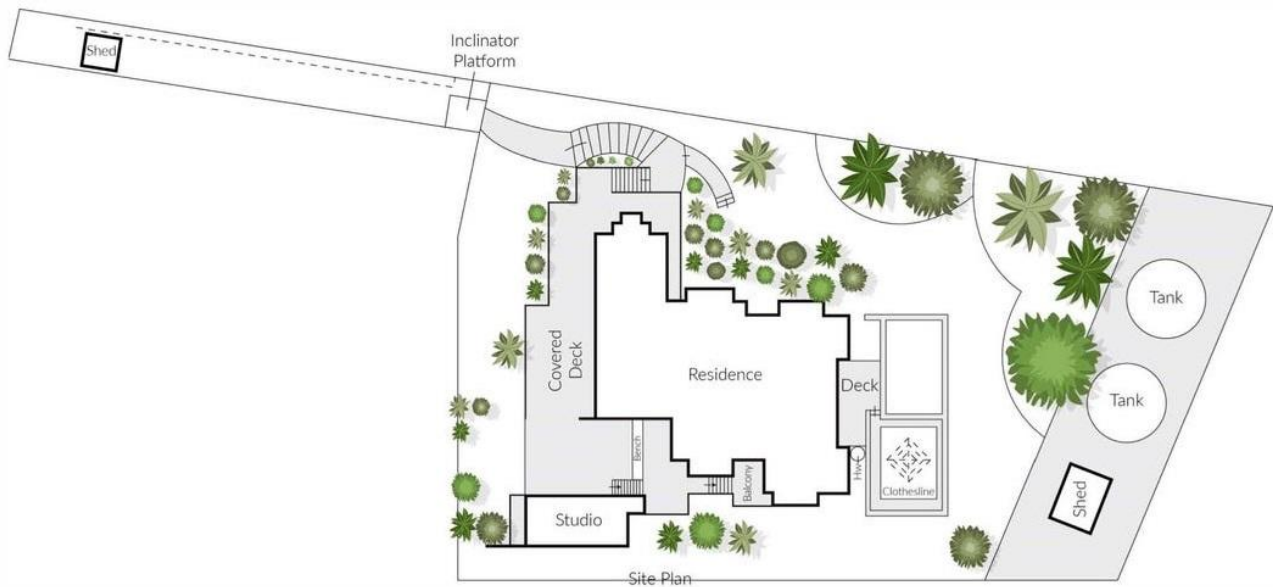

**Disclaimer:** Every precaution to verify the accuracy of the above details has been taken. However, prospective purchasers are advised to make their own enquiries.