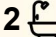
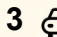

110a Skye Point Road, Coal Point

## PREMIER LOCATION - PRIME TO MAKE IT YOURS

Welcome to 110A Skye Point Road, Coal Point. This three bedroom home boasts space and functionality in abundance, with soaring ceilings adding to the appeal. Once you enter the beautiful lake views stand as a centrepiece to the premium location. The master bedroom includes en suite and access to the deck with views. The remaining bedrooms also have private access to the family bathroom and there is a second living room off the kitchen. A large double garage also contains an office space, additional storage and plumbing connections for a possible bathroom or dual living setup. Features Include:

- Three bedrooms with master including en suite
- Blue ribbon location boasting gorgeous NE lake views
- Oversized double garage with office and storage space
- Large deck making the most of the lake views
- 

3  2  3 

**FOR SALE**  
\$1,150,000

### AGENTS

Callan O'Reilly  
0412 168 303  
callan.oreilly@ljhooker.com.au

### AGENCY

LJ Hooker Lake Macquarie  
(02) 4915 3800

All information contained therein is gathered from relevant third parties sources. We cannot guarantee or give any warranty about the information provided. Interested parties must rely solely on their own enquiries.

 **LJ Hooker**

## MORE DETAILS

Property ID ZGJF7Q  
Property Type House  
Land Area 999 m2  
Including Ensuite  
Air Conditioning  
Toilets (3)  
Dishwasher  
Built-in-Robes  
Close to Schools  
Close to Shops  
Close to Transport  
High Clearance  
Rumpus/Family room  
Storage

**Callan O'Reilly 0412 168 303**  
Sales Executive | [callan.oreilly@ljhooker.com.au](mailto:callan.oreilly@ljhooker.com.au)

**LJ Hooker Lake Macquarie (02) 4915 3800**  
Shop 12, 240-260 Hillsborough Road, WARNERS BAY NSW 2282  
[lakemacquarie.ljhooker.com.au](mailto:lakemacquarie.ljhooker.com.au) | [warnersbay@ljhooker.com.au](mailto:warnersbay@ljhooker.com.au)



All information contained therein is gathered from relevant third parties sources.  
We cannot guarantee or give any warranty about the information provided.  
Interested parties must rely solely on their own enquiries.

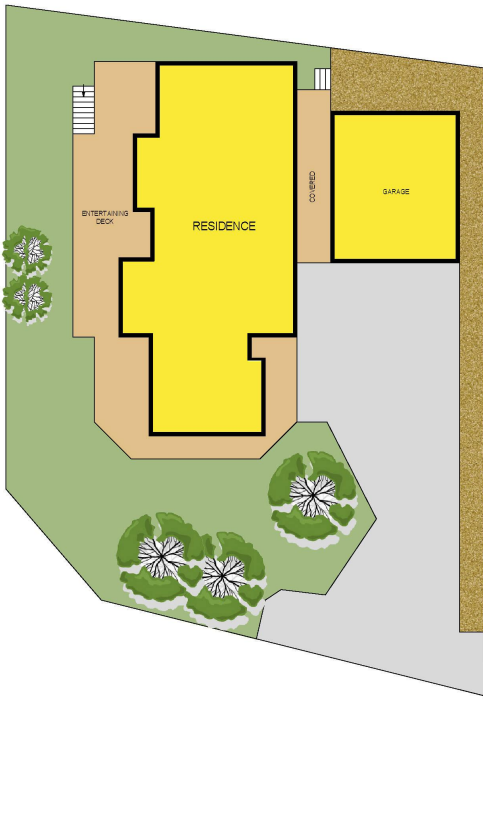

110A Skye Point Road  
Coal Point

Total Internal Floor Area: 164 sqm

Scale in metres. Indicative only. Dimensions are approximate. All information contained herein is gathered from sources we believe to be reliable. However we cannot guarantee its accuracy and interested persons should rely on their own enquiries



All information contained therein is gathered from relevant third parties sources.  
We cannot guarantee or give any warranty about the information provided.  
Interested parties must rely solely on their own enquiries.

