

Clyde, 16 Sincere Way

Spectacular Double-Storey Haven in the Coveted Lilium Estate

Discover unparalleled luxury in this exquisite residence nestled within the prestigious Lilium Estate of Clyde. Boasting a sprawling 386 sqm corner block, this opulent abode showcases a magnificent 286 sqm of meticulously crafted interiors, setting a new standard for contemporary living.

Step into an oasis of opulence where every detail exudes sophistication. The expansive open-plan design seamlessly integrates the family and dining areas with a state-of-the-art kitchen. From deluxe benchtops to premium appliances and abundant storage, every aspect of the kitchen is thoughtfully designed for both functionality and style. Additionally, a versatile guest bedroom and a generously sized study or home office provide flexible living options to suit your lifestyle needs.

Ascend the staircase to the upper level, where a sanctuary of comfort awaits. Four

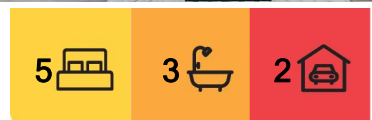

For Sale

MUST SELL!! Offer Negotiable! Come to See!

View

ljhooker.com.au/2CXHWN

Contact

Kobe Li

0434 566 941
kli.rowville@ljhooker.com.au

Jerome Yie-ong

0468 777 716
jyang.rowville@ljhooker.com.au



Disclaimer: All information contained therein is gathered from relevant third parties sources. We cannot guarantee or give any warranty about the information provided. Interested parties must rely solely on their own enquiries.

LJ Hooker Rowville
(03) 9132 5118

additional bedrooms, including a lavish master suite, offer ample space for relaxation and rejuvenation. For leisure and entertainment, additional living spaces, including a rumpus room, provide plenty of room for family enjoyment and relaxation.

Surrounding the residence is a meticulously landscaped corner block garden, offering a serene outdoor retreat. Access to the backyard is secured by a robust security gate, ensuring privacy and peace of mind.

Step outside to the enticing alfresco area, where alfresco dining and outdoor gatherings are elevated to new heights. Whether hosting friends or enjoying quiet moments with family, this outdoor sanctuary is the perfect setting for creating lasting memories.

Beyond the confines of this luxurious abode, Clyde's Lilium Estate offers more than just refined living. With great education options nearby and convenient access to shopping centers, healthcare facilities, and major transport routes, every aspect of modern living is within easy reach.

Zone to Ramleigh Park Primary School and Clyde Secondary College

Don't miss this opportunity to make this extraordinary residence your own and experience the pinnacle of contemporary elegance in Clyde's most sought-after locale.

Call or Text Kobe Li today on 0434566941 for more information!

More About this Property

Property ID	2CXHWN
Property Type	House
House Size	286 m ²
Land Area	387 m ²
Including	Ensuite Air Conditioning Built-in-Robes Area Views Bush Retreat Carpeted Close to Schools Close to Shops Close to Transport Creative

Kobe Li 0434 566 941
Managing Director, OIEC | kli.rowville@ljhooker.com.au
Jerome Yie-ong 0468 777 716
Sales Manager | jyang.rowville@ljhooker.com.au

LJ Hooker Rowville (03) 9132 5118
Unit 11-12/ 7 Fulham Road, ROWVILLE VIC 3178
rowville.ljhooker.com.au | rowville@ljhooker.com.au



Disclaimer: All information contained therein is gathered from relevant third parties sources. We cannot guarantee or give any warranty about the information provided. Interested parties must rely solely on their own enquiries.



LJ Hooker Rowville
(03) 9132 5118

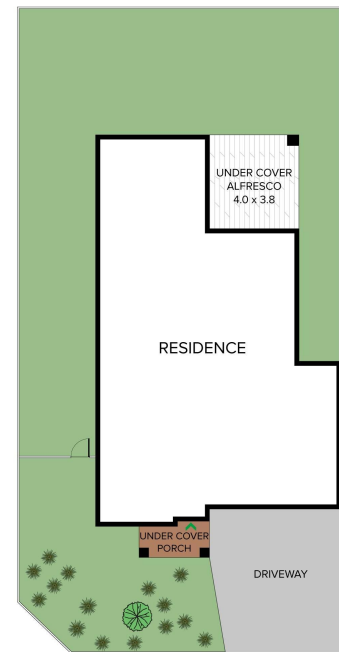

THIS PLAN IS NOT TO SCALE. MEASUREMENTS ARE INDICATIVE AND IN METRES. SITE PLAN REFLECTS APPROXIMATE POSITION OF BUILDINGS ON PROPERTY ONLY AND IS NOT AN ACCURATE REPRESENTATION OF VEGETATION AND OTHER EXTERNAL LANDSCAPE FEATURES. THIS PLAN SHOULD NOT BE RELIED UPON AND INTERESTED PARTIES SHOULD MAKE THEIR OWN ENQUIRIES.

floorpik by scandipik