



2/1 Lowe Street, Clovelly

Boutique coastal living with sweeping ocean views

This beautifully reinvented boutique retreat offers a dreamy slice of beachside paradise, tucked away in a peaceful pocket of Clovelly just footsteps from the natural beauty of Gordons Bay and only 200 metres to the beach and ocean pool.

Set on the north-east corner of a fully upgraded block of eight, this mid-floor apartment is bathed in sunlight and captures sweeping ocean views to Wedding Cake Island from its glass-framed entertainers balcony.

Reimagined from the ground up, the two-bedroom residence exudes a relaxed Santorini-inspired aesthetic with high ornate ceilings, limewashed floorboards, organic textures, and quality finishes throughout.

It's a short stroll to Clovelly's buzzing village cafés, artisan bakeries, yoga studios, and The Cloey's beer garden. You're also just 100 metres to express city buses and within easy reach of Bronte and Tamarama's scenic coastal paths and surf breaks.

Features include:

All information contained therein is gathered from relevant third parties sources. We cannot guarantee or give any warranty about the information provided. Interested parties must rely solely on their own enquiries.

2 🏠 1 🚿 0 🚗

FOR SALE
SOLD | Contact Agent

AGENTS

Darran Wyatt
0407 440 947
darran@ljhdoublebay.com

James Fragias
0432 503 176
james.fragias@ljhdoublebay.com

AGENCY

LJ Hooker Double Bay
(02) 9185 2816

 **LJ Hooker**

- King-sized main bedroom features a wall of built-in robes
- Spacious second bedroom with access to large balcony and ocean views
- Sun-filled living and dining area with period features and designer updates
- Custom kitchen with stone benchtops, gas cooktop, and farmhouse sink
- Bright and fresh bathroom includes a full-size bath, and vanity storage
- Positioned in a quiet cul-de-sac with no through-traffic and ample street parking

MORE DETAILS

Property ID 27WHYY
 Property Type Apartment

Darran Wyatt 0407 440 947

Associate Director - Wyatt Property Group Pty Ltd |
 darran@ljhdoublebay.com

James Fragias 0432 503 176

Sales Associate Team Wyatt | james.fragias@ljhdoublebay.com

LJ Hooker Double Bay (02) 9185 2816

38 Ocean Street, WOOLLAHRA NSW 2025
 doublebay.ljhooker.com.au | admin@ljhdoublebay.com



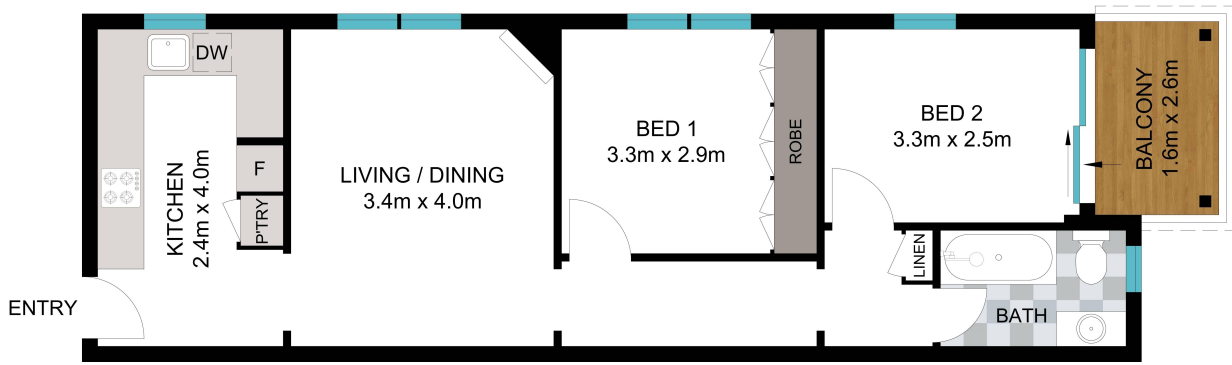

LEVEL ONE

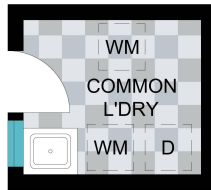

GROUND LEVEL



Scale in metres. Indicative only. Dimensions are approximate. All information contained herein is gathered from sources we believe to be reliable. However we cannot guarantee its accuracy and interested persons should rely on their own enquiries.

2/1 Lowe Street, Clovelly