

Clarkson, 33 Fleming Parkway

Spacious Family Oasis



Welcome to this stunning and spacious family home, thoughtfully designed for comfort and style, with an abundance of features to suit every lifestyle.

As you step inside, you're greeted by a cozy front living area complete with a study nook, offering a perfect space for work or relaxation. Flowing seamlessly from here, the home opens into a bright and expansive open-plan kitchen and dining area. The kitchen boasts ample bench space, generous storage, and a sizable pantry. A breakfast bar on the peninsula makes entertaining in the kitchen a breeze. The convenience of a shopper's entry from the double garage is an added bonus.

Across from the kitchen, grand double doors lead to a generously sized theatre room. This space captures natural light beautifully, providing an ideal setting for movie nights or simply enjoying views of the backyard, pool, and lush garden. The living area extends to the huge alfresco space, which can be enclosed with café blinds, making it perfect for

For Sale
\$800k+

View
ljhooker.com.au/J40HRD

Contact
Ian Knight
0413 447 016
ian.knight@ljhooker.com.au
Marco Viljoen
0468747725
marco.viljoen@ljhooker.com.au



LJ Hooker Joondalup
(08) 9300 2100

Disclaimer: All information contained therein is gathered from relevant third parties sources. We cannot guarantee or give any warranty about the information provided. Interested parties must rely solely on their own enquiries.

year-round gatherings. From here, you can dive into the sparkling pool or relax in the serene garden surroundings.

The main suite is a true retreat-spacious and private, with an additional nook that can be used as a personal sanctuary, a walk-in wardrobe, and a well-appointed ensuite bathroom. Towards the rear of the home, secondary bedrooms are privately tucked away, with a sliding door adding an extra layer of privacy. The family bathroom is a convenient semi-ensuite to one of the bedrooms, making it an ideal guest suite. All bedrooms are equipped with built-in wardrobes and large windows, ensuring an abundance of natural light.

Additional features include plantation shutters indoors, roller shutters outside, ducted reverse-cycle air conditioning throughout, a large solar system, attic storage, and ample parking with a double carport, a wide driveway, and convenient pull-through access to the rear of the property. The gardens are established, offering low-maintenance beauty year-round.

Situated in an excellent location, this home is just moments away from Fleming Park, a short walk to Clarkson Train Station, and only 600 meters from Ocean Keys Shopping Centre. This is a perfect blend of lifestyle, comfort, and convenience-ready for you to make your own!

More About this Property

Property ID	J40HRD
Property Type	House
Land Area	610 m ²
Including	Toilets (2)

Ian Knight 0413 447 016

Residential Sales Specialist | ian.knight@ljhooker.com.au

Marco Viljoen 0468747725

Sales Consultant | marco.viljoen@ljhooker.com.au

LJ Hooker Joondalup (08) 9300 2100

4/25 Delage Street, JOONDALUP WA 6027

joondalup.ljhooker.com.au | admin.joondalup@ljhooker.com.au



Disclaimer: All information contained therein is gathered from relevant third parties sources.

We cannot guarantee or give any warranty about the information provided. Interested parties must rely solely on their own enquiries.

LJ Hooker Joondalup
(08) 9300 2100

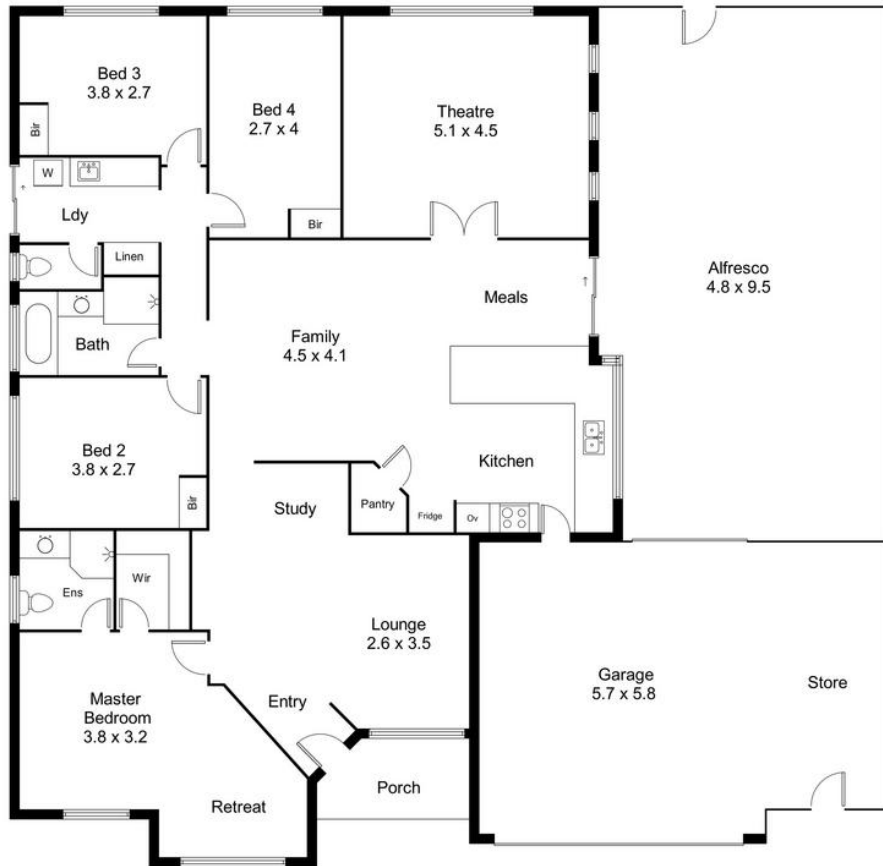

LJ Hooker 33 Fleming Parkway, Clarkson

For information and guidance purpose only / measurements shown are approximate



LJ Hooker Joondalup
(08) 9300 2100

Disclaimer: All information contained therein is gathered from relevant third parties sources. We cannot guarantee or give any warranty about the information provided. Interested parties must rely solely on their own enquiries.