



Church Point, 2149 Pittwater Road

Pittwater Front Row - Seize This Rare Opportunity

Enjoy a deck-side view of magical Pittwater

Relax into your front row seat. There's an unmissable show from this prime vantage point enjoying sparkling broad views of Pittwater and the Peninsula. Nestled on a stunning stretch of waterfront shoreline, this rejuvenated beach house offers a relaxed low maintenance coastal lifestyle or an opportunity to build your dream home.

- * Best value waterside home - never-to-be-built-out views across Pittwater
- * 3 King-sized bedrooms with views, balcony access and built-ins
- * Opportunity to move in now while making updates over time or start again and build your dream home
- * Tandem carport with internal access plus parking bay
- * Sunny backyard and patio with plenty of space for a pool (S.T.C.A)
- * Dedicated office room as well as builders workshop

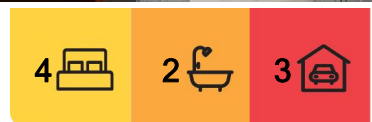

For Sale
Auction - Guide \$3.3M

View
ljhooker.com.au/2VQUF6K

Contact
Ryan Petrie
0403 988 123
rpetrie@ljhm.com.au
Simone Novak
0418 601 599
snovak@ljhm.com.au



Disclaimer: All information contained therein is gathered from relevant third parties sources. We cannot guarantee or give any warranty about the information provided. Interested parties must rely solely on their own enquiries.

LJ Hooker Mona Vale
(02) 9979 8000

- * Renovated kitchen, dining and living room form one open plan space
- * Designed around outdoor living and entertaining with expansive sun decks cascading towards the waters edge, enjoy a spa or sit around the fire pit watching the boats on Pittwater
- * Exclusive position dotted with high end, contemporary homes
- * Phenomenal Pittwater views from virtually every room

Just seconds away from Bayview's famous foreshore, enjoy morning walks to your favourite cafe and dinner and drinks just around the corner at the Pasadena.

Disclaimer:

All information contained herewith, including but not limited to the general property description, price and the address, is provided to LJ Hooker Mona Vale by third parties. We have obtained this information from sources we believe to be reliable; however, we cannot guarantee its accuracy. The information contained herewith should not be relied upon and you should make your own enquiries and seek advice in respect of this property or any property on this website.

More About this Property

Property ID	2VQUF6K
Property Type	House
Land Area	650 m²

Ryan Petrie 0403 988 123
 Licensed Real Estate Agent | rpetrie@ljhmv.com.au
Simone Novak 0418 601 599
 Licensed Real Estate Agent | snovak@ljhmv.com.au

LJ Hooker Mona Vale (02) 9979 8000
 3/18 Bungan Street, MONA VALE NSW 2103
 monavale.ljhooker.com.au | monavale@ljhmv.com.au



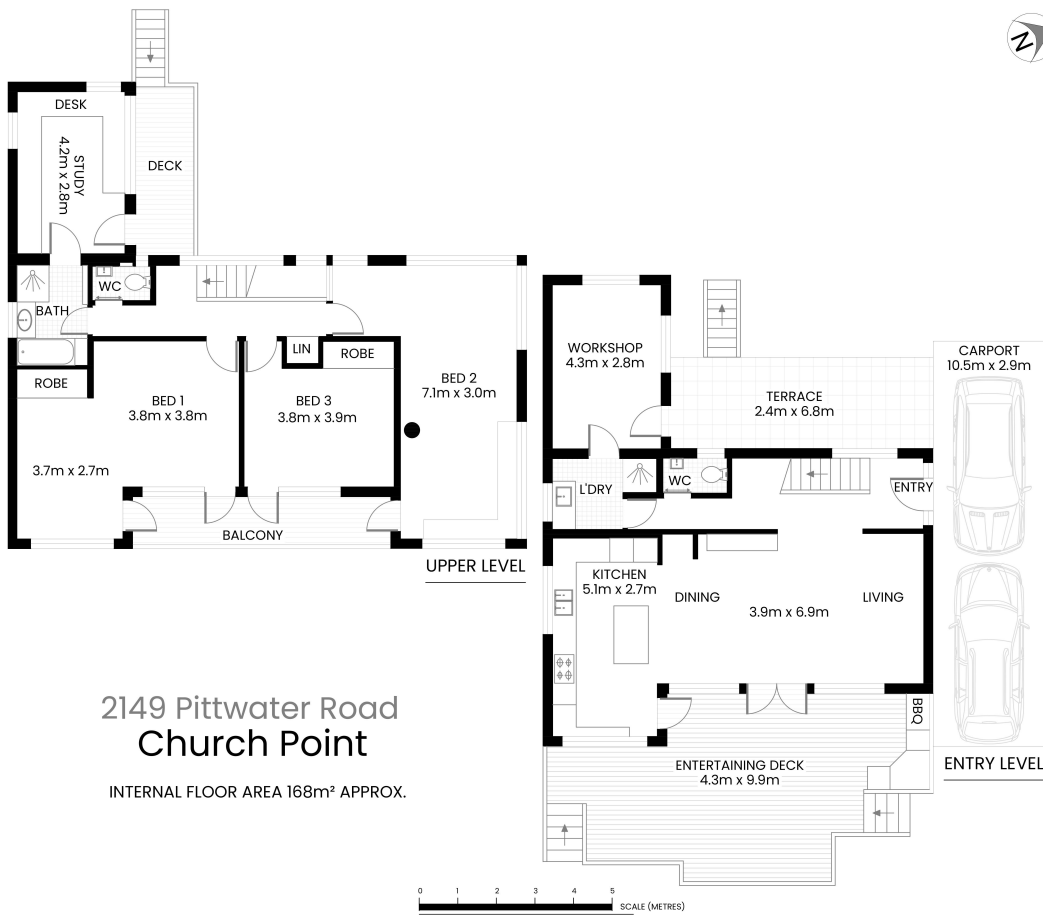

LJ Hooker

The site plan and floor plan are not to scale; measurements are indicative and in meters. Bushes and trees are placed for illustration purposes. Plans should not be relied on. Interested parties should make and rely on their own enquire. All other information provided has been collected from reliable sources but cannot be guaranteed for accuracy.

LJ Hooker

LJ Hooker Mona Vale
(02) 9979 8000

Disclaimer: All information contained therein is gathered from relevant third parties sources. We cannot guarantee or give any warranty about the information provided. Interested parties must rely solely on their own enquiries.