

65 Ashwood Circuit, Chambers Flat

A HOME DESIGNED FOR FAMILY LIFE



CONTACT AGENT TO INSPECT THE PROPERTY

Step into a home that perfectly balances space, comfort, and modern convenience. Designed with families in mind, this well-appointed residence offers a thoughtful layout with multiple living zones and quality finishes throughout.

Boasting four generously sized bedrooms, the master suite provides a private retreat complete with a walk-in robe, ceiling fan, and a stylish ensuite featuring a double vanity. The remaining bedrooms all include built-in robes and are serviced by a central bathroom with a freestanding bathtub, plus a separate toilet for added functionality.

The heart of the home is the modern kitchen, equipped with an electric cooktop and complemented by a spacious butlers pantry, offering plenty of storage and preparation space. Flowing seamlessly from the kitchen are two separate living areas along with a dedicated media room, providing flexibility for both relaxation and entertaining.

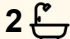
High ceilings enhance the sense of space, while ceiling fans throughout ensure year-round comfort. A practical laundry with side

4  2  2 

FOR SALE
CONTACT AGENT FOR INSPECTION

VIEW
By Appointment

AGENTS
Mayank Patel
0430 402 866
mayankpatel@ljhpp.com.au

Anita
0403 833 017
anita@ljhpp.com.au

AGENCY
LJ Hooker Property Partners
07 3344 0288

All information contained therein is gathered from relevant third parties sources.
We cannot guarantee or give any warranty about the information provided.
Interested parties must rely solely on their own enquiries.

 **LJ Hooker**

access adds everyday convenience.

Outside, the low-maintenance backyard offers the perfect setting for easy living without the upkeep.

This is an ideal opportunity for families seeking a stylish, functional home with room to grow.

Property Features: 4 bedrooms, 2 bathrooms, media room, multiple living areas, high ceilings, ceiling fans, master with ensuite & walk-in robe, built-in robes, kitchen with butler's pantry, laundry with side access, low-maintenance backyard

- 4 spacious bedrooms, all with built-in robes
- Master bedroom with walk-in robe, ceiling fan, and private ensuite featuring double vanity
- 2 well-appointed bathrooms, including a main bathroom with freestanding bathtub
- Separate toilet for added convenience
- Multiple living areas providing space for family living and entertaining
- Dedicated media room perfect for movie nights or a home theatre setup
- Modern kitchen with electric cooktop and ample storage
- Butler's pantry offering extra preparation space and storage
- High ceilings enhancing natural light and sense of space
- Ceiling fans throughout for year-round comfort
- Functional laundry with convenient side access
- Low-maintenance backyard ideal for easy outdoor living

Buying | Selling | Renting Contact your Pallara & Heathwood #1 Resident Agent & Suburb Specialist, Mayank Patel today for all your property needs on 0430402866

Disclaimer: This property is being sold without a price; the website may have filtered the property into a price bracket for website functionality purposes. Contact Mayank Patel on 0430402866 today for your exclusive tour.

Disclaimer: The information presented in this advertisement has been diligently prepared to ensure its accuracy and truthfulness. However, we bear no responsibility and hereby disclaim all liability for errors, inaccuracies, misstatements that may be found within. We strongly advise potential purchasers to conduct their own thorough assessments and financial investigations to independently verify the information provided herein. We have also used virtual grass on the photos.

MORE DETAILS

Property ID B4PFF4R
Property Type House
Land Area 459 m2
Including Outdoor Entertaining
Built-in-Robes
Secure Parking
Fully Fenced
Remote Garage

Mayank Patel 0430 402 866

Principal and Licensee LJ Hooker Property Partners â€“ Forest Lake
| mayankpatel@ljhpp.com.au

Anita 0403 833 017

Agent with Mayank Patel | anita@ljhpp.com.au

LJ Hooker Property Partners 07 3344 0288

25 Pinelands Road, SUNNYBANK HILLS QLD 4109
propertypartners.ljhooker.com.au | sunnybankhills@ljhpp.com.au



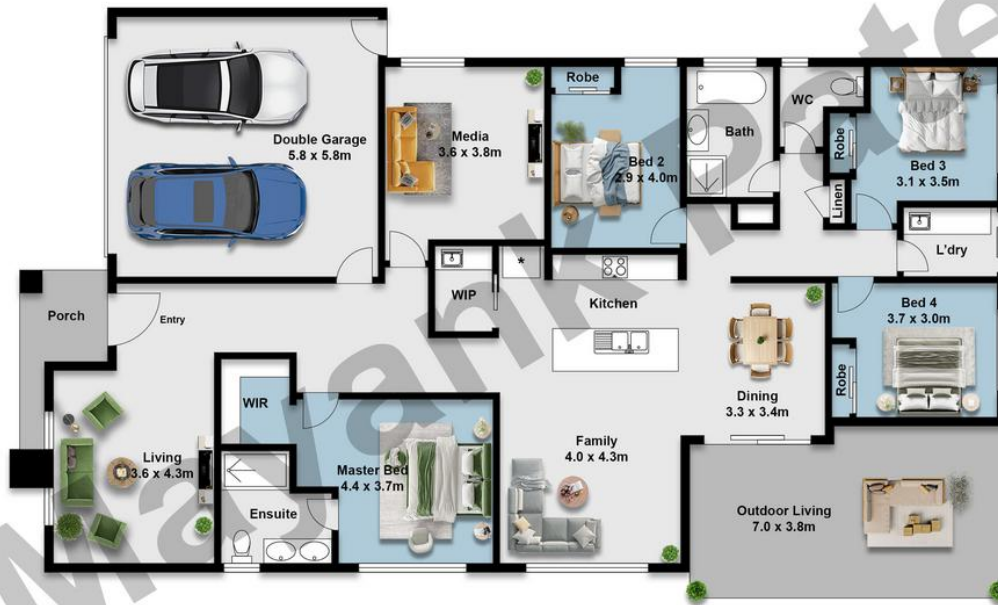

This floor plan is not to scale. Areas and dimensions are approximate and therefore floor plan should only be used for illustrative purposes. Plants and furnitures are decorative only.

Approximate Total Building Size : 255 sqm

65 Ashwood Circuit, Chambers Flat

 4
  2
  2

Mayank Patel 0430 402 866

All information contained therein is gathered from relevant third parties sources. We cannot guarantee or give any warranty about the information provided. Interested parties must rely solely on their own enquiries.