



640 Tantawangalo Lane, Candelo

## CHARMING HOME WITH OVER 300M CREEK FRONTAGE

Welcome to 640 Tantawangalo Lane, an exceptional lifestyle opportunity with a character-filled family home positioned on approximately 124 acres of productive and beautifully presented land. With over 300 metres of stunning Tantawangalo Creek frontage, this property is a must-see.

The welcoming four-bedroom home is full of warmth and timeless appeal, featuring hardwood floors, high ceilings and a versatile floorplan with both formal and informal living areas. A wood fire creates a cosy atmosphere through the cooler months, while reverse cycle air-conditioning ensures year-round comfort. The home enjoys a peaceful outlook across the surrounding farmland, creating a true sense of country living.

Designed to cater for both lifestyle and farming pursuits, the property is well equipped with a large five-bay shed, cattle yards, good fencing and quality grazing pasture. Several dams provide excellent water security, complemented by a valuable 10 megalitre irrigation licence, spring fed dams providing water to both dwellings and three-phase power connected to the property.

5  2  4 

**FOR SALE**  
Contact Agent

**VIEW**  
By Appointment

**AGENTS**  
Tim Shinnick  
0466 475 131  
tshinnick@ljhbega.com.au

**AGENCY**  
LJ Hooker Bega  
(02) 6492 4300

All information contained therein is gathered from relevant third parties sources.  
We cannot guarantee or give any warranty about the information provided.  
Interested parties must rely solely on their own enquiries.

 **LJ Hooker**

Adding further appeal is the original dairy, which has been tastefully renovated into a fully self-contained guest house, ideal for extended family, guest accommodation or additional income potential.

Offering privacy, productivity and an idyllic rural setting, this outstanding property presents a rare opportunity to secure a substantial holding in one of the Bega Valley's most sought-after locations.

### **MORE DETAILS**

|               |                   |
|---------------|-------------------|
| Property ID   | P5YFGN            |
| Property Type | AcreageSemi-rural |
| Land Area     | 124 acre          |

**Tim Shinnick 0466 475 131**  
Licenced Real Estate Agent | [tshinnick@ljhbega.com.au](mailto:tshinnick@ljhbega.com.au)

**LJ Hooker Bega (02) 6492 4300**  
225 Carp Street, BEGA NSW 2550  
[bega.ljhooker.com.au](http://bega.ljhooker.com.au) | [office@ljhbega.com.au](mailto:office@ljhbega.com.au)



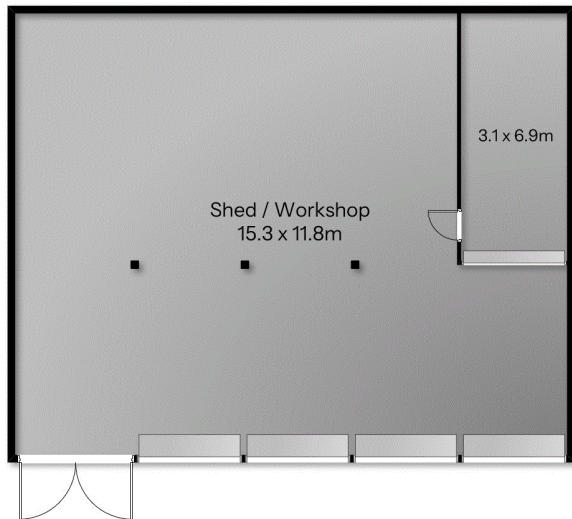
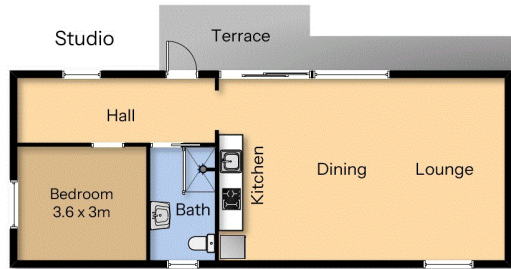

5 2 4

640 Tantawangalo Ln  
Tantawangalo

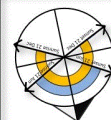

Scale is indicative, measurements are approximate and should be used as a guide only. This plan is for marketing purposes only and should not be relied upon for valuation, construction, or renovation.

All information contained therein is gathered from relevant third parties sources. We cannot guarantee or give any warranty about the information provided. Interested parties must rely solely on their own enquiries.

