



6/31 Wyatt Avenue, Burwood

## A Private Sanctuary of Space, Style and Modern Comfort

A refined expression of timeless elegance and contemporary comfort, this near new four-bedroom townhouse represents a truly rare offering in one of Burwood's most desirable pockets. Designed to embrace seamless indoor-outdoor living, the home delivers an exceptional sense of space, privacy and low-maintenance sophistication.

Spanning a thoughtfully designed dual-level layout, the interiors unfold into expansive open plan living and dining areas enhanced by abundant natural light and effortless flow. Floor to ceiling glass doors extend the living domain to a covered patio and a private courtyard, creating a serene sanctuary ideal for alfresco dining, weekend gatherings or quiet relaxation.

The stylish modern kitchen forms the heart of the home, complete with quality stainless steel appliances, stone benchtops and generous preparation space, perfectly suited to both everyday living and entertaining. Accommodation comprises four generous sized bedrooms, each appointed with built-in wardrobes, while the master enjoys the comfort and exclusivity of its own ensuite. Three well-appointed bathrooms, a spacious study area, extensive storage solutions, quality timber flooring, ducted air-conditioning and a

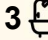
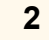
4  3  2 

**FOR SALE**  
Auction

**VIEW**

Sat 16th May @ 12:00PM - 12:30PM

**AGENTS**

Rong You  
0424 433 888  
rong@ljhburwood.com.au

**AGENCY**

LJ Hooker Burwood  
(02) 9745 3999

All information contained therein is gathered from relevant third parties sources. We cannot guarantee or give any warranty about the information provided. Interested parties must rely solely on their own enquiries.

 **LJ Hooker**

functional internal laundry further elevate the home's liveability.

Adding to its appeal is a secure double lock-up garage providing convenient parking for two vehicles within this tightly held boutique complex. Positioned within easy walking distance to Burwood Train Station, Burwood Plaza, Westfield Shopping Centre, vibrant cafe and dining precincts, and prestigious local schools, this exceptional residence promises a lifestyle of effortless convenience, connectivity and enduring appeal.

## MORE DETAILS

Property ID	12CWF8R
Property Type	Townhouse
Land Area	218 m2

**Rong You 0424 433 888**

Sales | Licensed Real Estate Agent | [rong@ljhburwood.com.au](mailto:rong@ljhburwood.com.au)

**LJ Hooker Burwood (02) 9745 3999**

Shop 2/27-29 Burwood Road, BURWOOD NSW 2134  
[burwood.ljhooker.com.au](http://burwood.ljhooker.com.au) | [burwood@ljhburwood.com.au](mailto:burwood@ljhburwood.com.au)

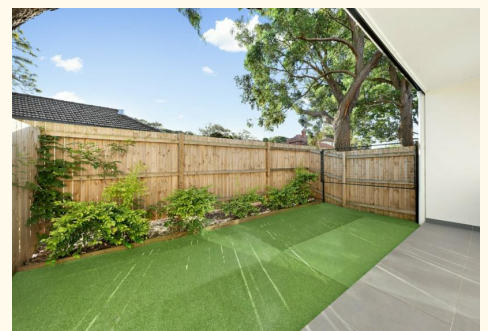

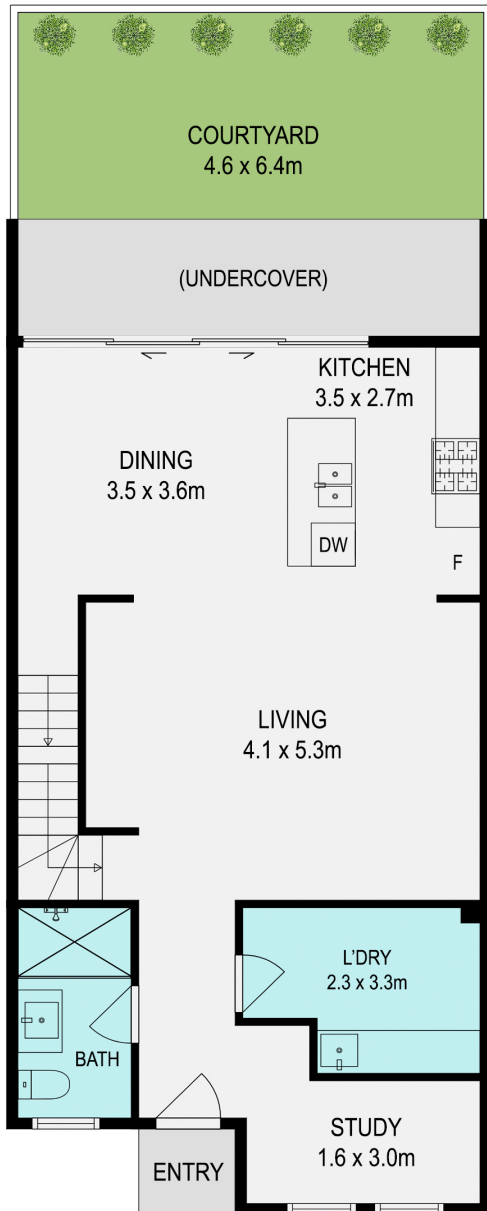

GROUND FLOOR

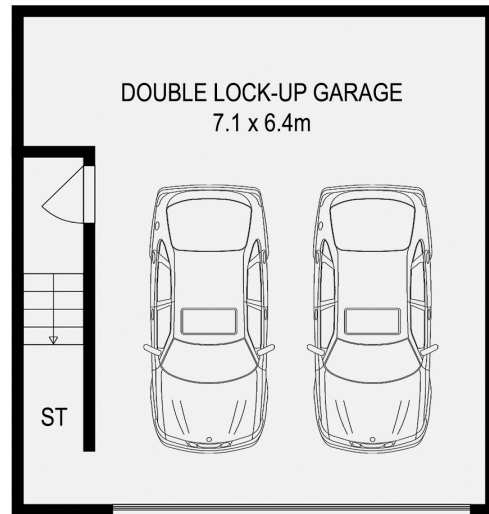

LOWER GROUND FLOOR

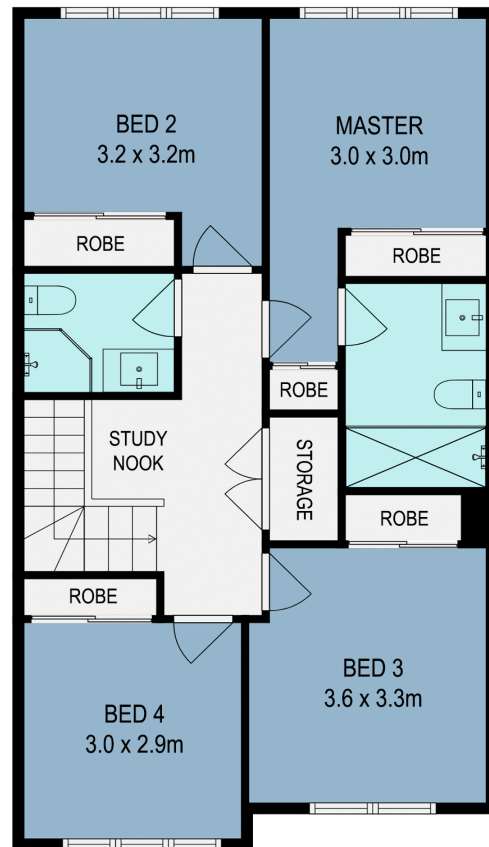

FIRST FLOOR

6/31 Wyatt Avenue, Burwood



DISCLAIMER: THIS FLOOR PLAN IS INTENDED AS A GUIDE ONLY. IT DOES NOT CONSTITUTE PART OF ANY LEGAL DOCUMENTS. ALL DIMENSIONS ARE APPROXIMATE, ACTUAL MAY VARY. NO LIABILITY ACCEPTED. YOU MUST SEEK ADVICE FROM YOUR SOLICITOR. FLOOR PLAN BY WWW.MCPIXELSAU.COM