



60 Morgan Street, Broken Hill



## Large shed, verandahs and carport

Positioned in a neighbourhood near the local sporting oval, this freshly painted home offers great external development. Perfect for first home buyers and those who love their shed!

Property details:

- 3 bedrooms
- Large lounge room with good natural light
- The property has been freshly painted throughout inside
- Archway to kitchen/dine with electric cooking
- Evaporative cooling and wood heating
- Bathroom with vanity and shower
- Separate toilet
- Expansive back verandah, an ideal space for outdoor entertaining and gatherings
- Off street parking with carport and shed
- Solar panels
- 20x50ft steel frame shed with concrete flooring, power, shelves and is split into two section with a wall and sliding door.

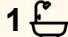
Land rates: approx \$1,627  
Water rates: approx \$1,000

3  1  3 

**FOR SALE**  
Please Call

### AGENTS

Tara Nadge  
0408 787 422  
sales.brokenhill@ljhooker.com.au

### AGENCY

LJ Hooker Broken Hill  
(08) 8087 3666

All information contained therein is gathered from relevant third parties sources.  
We cannot guarantee or give any warranty about the information provided.  
Interested parties must rely solely on their own enquiries.

 **LJ Hooker**

Disclaimer: All information contained therein is gathered from relevant third party sources. We cannot guarantee or give any warranty about the information provided. Interested parties must rely solely on their own enquiries. All distances and measurements are approximates only.

## MORE DETAILS

|               |  |
|---------------|--|
| Property ID   | X6TGKV   |
| Property Type | House  |
| Land Area     | 921.1 m2   |
| Including     | Evaporative Cooling<br>Toilets (1)<br>Secure Parking<br>Fully Fenced |

**Tara Nadge 0408 787 422**

Principal | [sales.brokenhill@ljhooker.com.au](mailto:sales.brokenhill@ljhooker.com.au)

**LJ Hooker Broken Hill (08) 8087 3666**

326 Blende Street, BROKEN HILL NSW 2880  
[brokenhill.ljhooker.com.au](mailto:brokenhill.ljhooker.com.au) | [brokenhill@ljhooker.com.au](mailto:brokenhill@ljhooker.com.au)



# 60 Morgan Street, Broken Hill

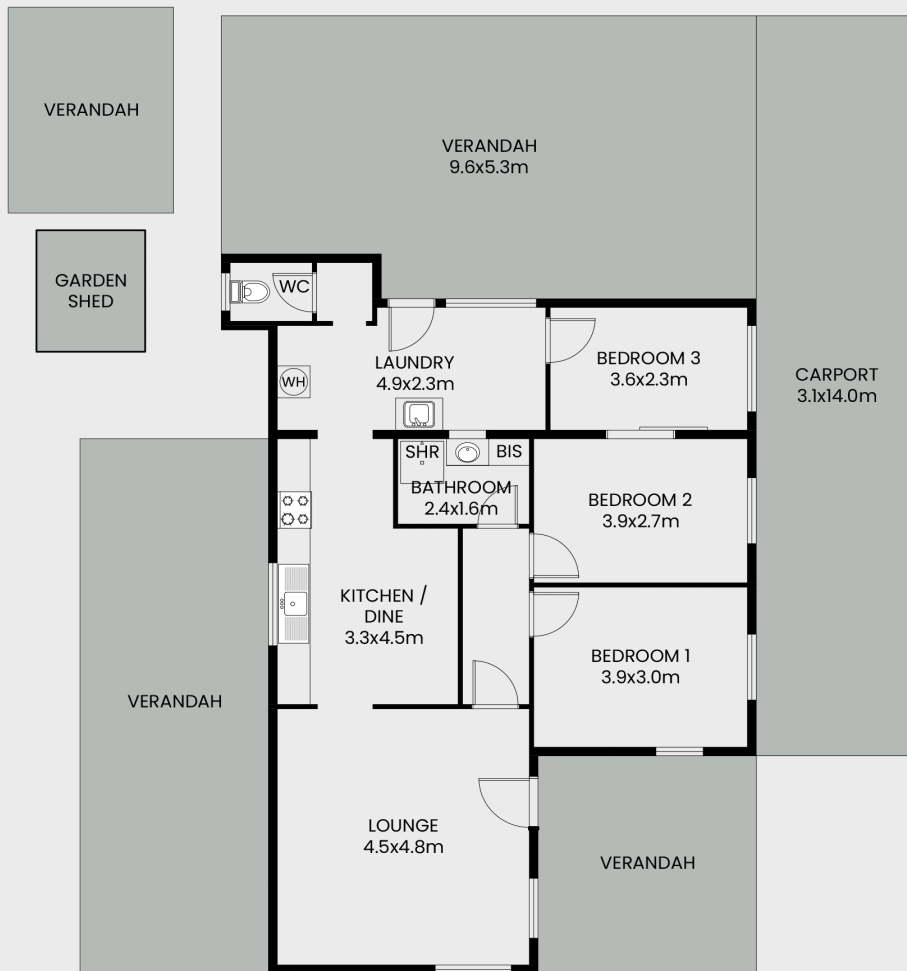
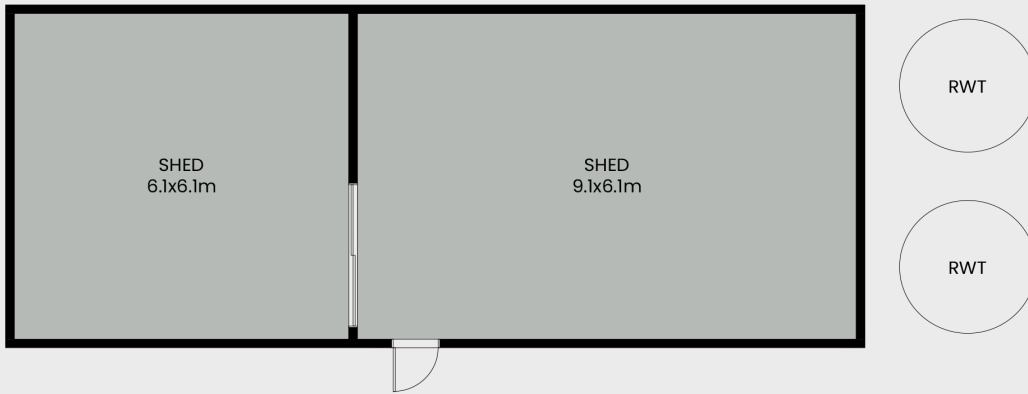

This floor plan including furniture, fixture measurements and dimensions are approximate and for illustrative purposes only. BoxBrownie.com gives no guarantee, warranty or representation as to the accuracy and layout. All enquiries must be directed to the agent, vendor or party representing this floor plan.

All information contained therein is gathered from relevant third parties sources. We cannot guarantee or give any warranty about the information provided. Interested parties must rely solely on their own enquiries.

