



Botanic Ridge, 15 Seedling Street

Modern Elegance In a Gorgeous Location

Experience modern elegance in the heart of the beautifully designed Botanic Ridge with this impressive Porter-Davis residence. Just three years young, this stylish double-storey home features four good-sized bedrooms and is adorned with high-quality fixtures and contemporary finishes throughout.

Upon entering, you are welcomed by the warmth of laminate timber floors that lead to a meticulously designed kitchen. Equipped with Caesarstone benchtops, chic tile splashbacks, a 900mm stainless steel oven and hotplates, and a dishwasher, the kitchen is a culinary delight. It also includes a generous butler's pantry with ample storage space. Overlooking the kitchen is a spacious light filled family area, which is perfect for relaxing or entertaining, also featuring split system air conditioning for added comfort.

Adjacent to the kitchen is a large dining room that opens to an eco-decked alfresco and patio area, ideal for entertaining or enjoying quiet moments and overlooks the fire pit and



Disclaimer: All information contained therein is gathered from relevant third parties sources. We cannot guarantee or give any warranty about the information provided. Interested parties must rely solely on their own enquiries.

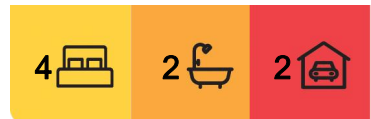

For Sale
\$680,000 - \$745,000

View
ljhooker.com.au/1XADFB5

Contact
Darren Saxon
0418 341 722
darren.saxon@ljhcasey.com.au
Mahdi Tawakoli
0480 116 248
mahdi.tawakoli@ljhcasey.com.au

LJ Hooker Cranbourne
(03) 5996 4777

rear yard that compliments this outdoor space. The ground floor also includes a convenient powder room and a laundry with internal access to a double remote garage, which is fitted with a built-in electric car charger.

The home ensures year-round comfort with gas ducted heating and ducted evaporative cooling. Additional features include high ceilings downstairs, the windows are double glazed throughout and there is an alarm for security. The second-floor houses four well-sized bedrooms, including a master suite with a walk-in robe and a full ensuite. The additional three bedrooms each feature double sliding robes and are served by a bright and modern bathroom.

Located near beautifully landscaped parks, playgrounds, and wetlands, this property offers convenience with proximity to the newly opened Botanic Ridge Primary School, sporting grounds, and a local shopping village. This village includes a Coles supermarket, doctors, and a variety of convenience stores and dining options, including McDonald's.

This thoughtfully designed home combines modern amenities with a prime location, making it an ideal choice for discerning buyers. Call for your inspection today to discover all that this exceptional property has to offer.

More About this Property

Property ID	1XADFBS
Property Type	House
Land Area	252 m ²
Including	Ensuite Air Conditioning Ducted Heating Evaporative Cooling Toilets (3) Alarm Dishwasher Floorboards Built-in-Robes Solar Hot Water Close to Schools Close to Shops Close to Transport Split system

Darren Saxon 0418 341 722

Sales Agent / Licensed Estate Agent | darren.saxon@ljhcasey.com.au

Mahdi Tawakoli 0480 116 248

Sales Associate | mahdi.tawakoli@ljhcasey.com.au

LJ Hooker Cranbourne (03) 5996 4777

119 High Street, CRANBOURNE VIC 3977

cranbourne.ljhooker.com.au | john.deo@ljhcasey.com.au



LJ Hooker Cranbourne
(03) 5996 4777

Disclaimer: All information contained therein is gathered from relevant third parties sources. We cannot guarantee or give any warranty about the information provided. Interested parties must rely solely on their own enquiries.

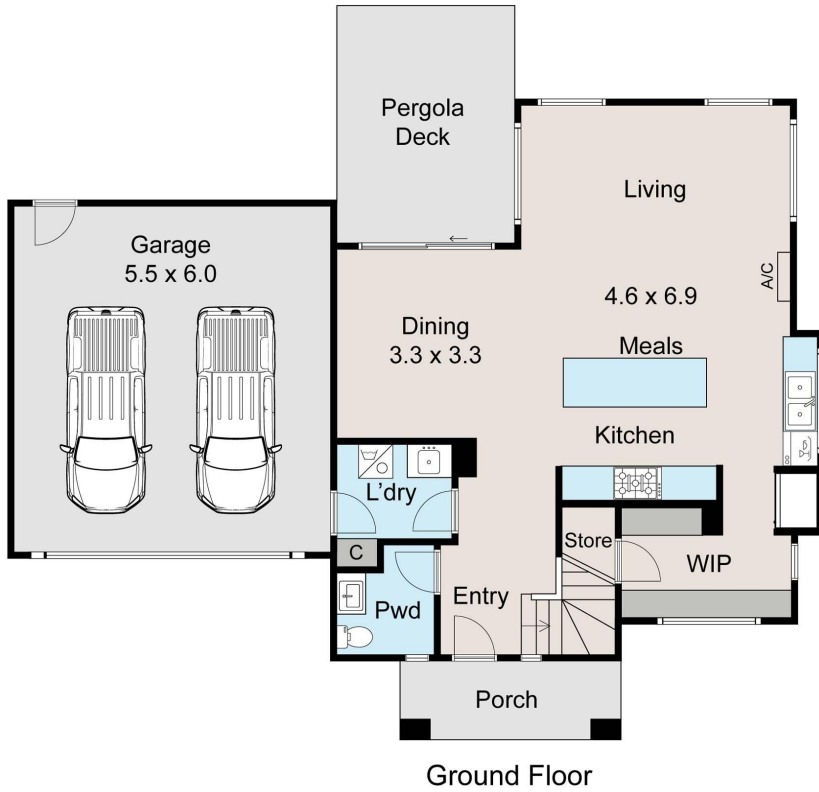

Ground Floor

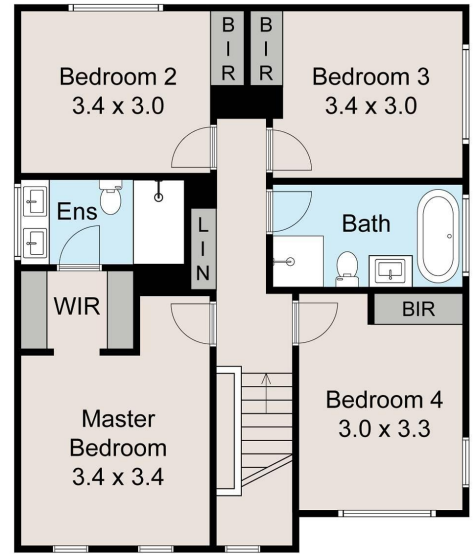

First Floor

LJ Hooker

This drawing is for illustrative purposes only and while every effort has been made to maintain accuracy, prospective purchasers should check all information