

12/318 Bondi Road, Bondi

2 1 0

Coastal Lifestyle Meets Classic Charm in Prime Bondi Location

Perfectly positioned just a short stroll to Bondi Beach, this character-filled 2-bedroom apartment offers the ultimate in laid-back beachside living. Set within a boutique 1930s art deco block, the home enjoys natural light, privacy, and unbeatable access to cafés, public transport, and one of Sydney's most iconic stretches of coastline. Whether you're a first home buyer or investor, this is a golden opportunity to secure a slice of Bondi in a tightly held block.

Features include:

- Spacious main bedroom with robe, second with balcony and AC
- Updated bathroom with clean, modern finishes
- Top floor position in a charming, low-rise 1930s building
- Only moments to Bondi Beach, shops, and eateries
- Easy access to buses and Bondi Junction train station
- Light-filled living and dining area, high ceilings, storage space
- Set in a sought-after beachside suburb with high growth

FOR SALE

SOLD | Price Undisclosed

AGENTS

Darran Wyatt
0407 440 947
darran@ljhdoublbay.com

James Fragias
0432 503 176
james.fragias@ljhdoublbay.com

AGENCY

LJ Hooker Double Bay
(02) 9185 2816

All information contained therein is gathered from relevant third parties sources. We cannot guarantee or give any warranty about the information provided. Interested parties must rely solely on their own enquiries.

LJ Hooker

MORE DETAILS

Property ID 2C0HYY
Property Type Apartment

Darran Wyatt 0407 440 947

Associate Director - Wyatt Property Group Pty Ltd |
darran@ljhdoublebay.com

James Fragias 0432 503 176

Sales Associate Team Wyatt | james.fragias@ljhdoublebay.com

LJ Hooker Double Bay (02) 9185 2816

38 Ocean Street, WOOLLAHRA NSW 2025
doublebay.ljhooker.com.au | admin@ljhdoublebay.com



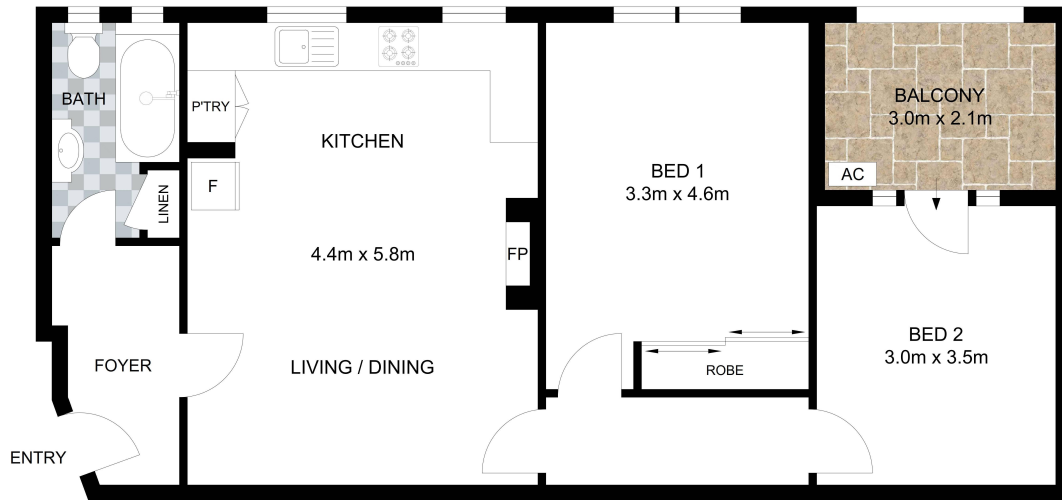

TOP LEVEL



Scale in metres. Indicative only. Dimensions are approximate. All information contained herein is gathered from sources we believe to be reliable. However we cannot guarantee its accuracy and interested persons should rely on their own enquiries.

APPROX. INT: 66m²
 APPROX. EXT: 6m²



12/318 Bondi Road, Bondi