

9 Tartarian Crescent, Bomaderry

Expansive 4,800sqm Parcel of Land

Brick + tile home needing renovation
Parent retreat consists of a bedroom, living, walkin robe and ensuite
Spacious living room
2 Separate bathrooms
Study or 3rd bedroom
Open plan kitchen
Ducted R/C A/C / security shutters
Covered entertainment area
2 car detached powered garage/ carport
Covered front verandah
Located a short drive to Aldi, Woolworths, Schools and Bomaderry Railway Station.
Packed with potential, this home is waiting for the right buyer to invest some time and care to restore it to its former glory.

Auction 14th July 2026 6:00pm at the Quest Apartments Nowra

Please call Peter on 0402 267 411 to organise an inspection

2 🏠 3 🚿 3 🚗

AUCTION

Tue 14th Jul @ 6:00PM

VIEW

Sat 20th Jun @ 11:00AM - 11:30AM

AGENTS

Peter Rapley
0402 267 411
prapley.nowra@ljhooker.com.au

AGENCY

LJ Hooker Nowra
(02) 4421 2957

All information contained therein is gathered from relevant third parties sources.
We cannot guarantee or give any warranty about the information provided.
Interested parties must rely solely on their own enquiries.



MORE DETAILS

Property ID 6PEHSD
Property Type House
Land Area 4800 m2

Peter Rapley 0402 267 411

Licenced Real Estate Agent | prapley.nowra@ljhooker.com.au

LJ Hooker Nowra (02) 4421 2957

5/38-44 Berry Street, NOWRA NSW 2541
nowra.ljhooker.com.au | nowra@ljhooker.com.au



All information contained therein is gathered from relevant third parties sources.
We cannot guarantee or give any warranty about the information provided.
Interested parties must rely solely on their own enquiries.

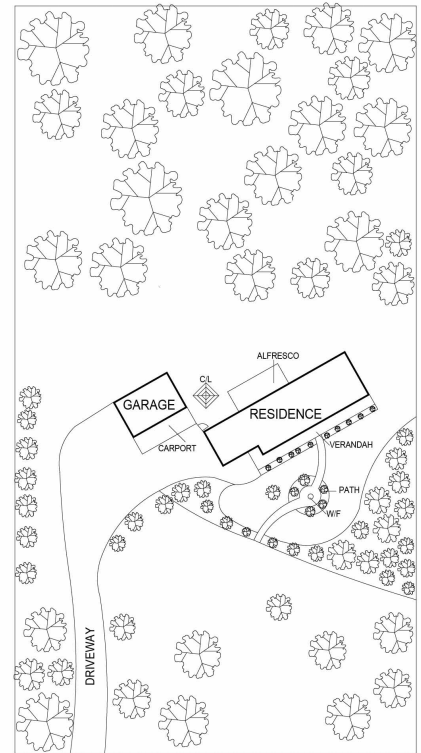
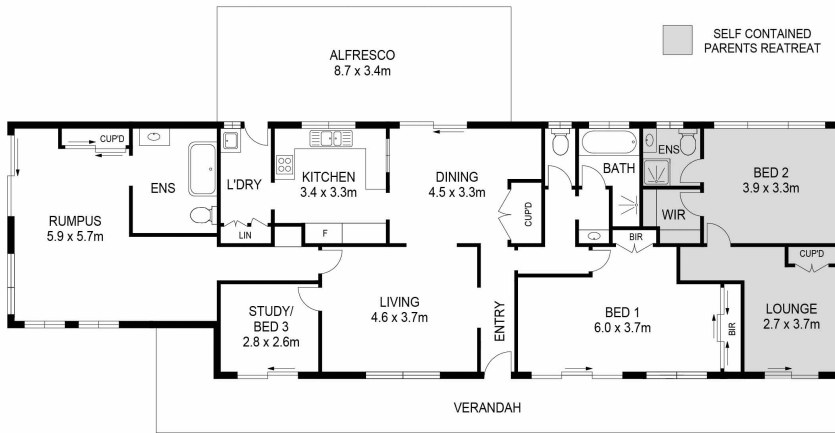
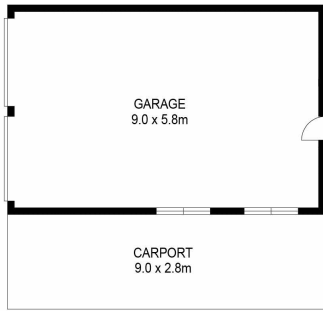

SITE PLAN



GROSS INTERNAL AREA
 GROSS INTERNAL AREA: 166m², EXCLUDED AREAS:
 CARPORT: 25m², VERANDAH: 35m², ALFRESCO: 30m², GARAGE: 52m²
 TOTAL: 308m²

MEASUREMENTS ARE DEEMED HIGHLY RELIABLE BUT NOT GUARANTEED.



All information contained therein is gathered from relevant third parties sources.
 We cannot guarantee or give any warranty about the information provided.
 Interested parties must rely solely on their own enquiries.

