

Bilgola Beach, 63 The Serpentine

All Encompassing Coastal Panorama - Striking Architecture

Aptly named 'Headlands' enjoys spectacular north easterly views over the golden sands of Avalon Beach and sweeping vistas back across the majestic ocean to Bilgola Beach and along the coastline all the way to Manly.

Enjoying a commanding sunlit position on highly sought after The Serpentine. Strong yet simple architectural lines featuring Bauhaus design influences ensure that this "jewel in the crown" position has been honoured.

The aesthetic is effortlessly minimalist and simple whereby clean lines and shapes allow the ever-changing panorama to always take centre stage. The high level of craftsmanship is immediately apparent upon entering. Respected, architect Geoffrey Taylor worked in close collaboration with the builder to create a timeless home constructed with incredible attention to detail.



Disclaimer: All information contained therein is gathered from relevant third parties sources. We cannot guarantee or give any warranty about the information provided. Interested parties must rely solely on their own enquiries.

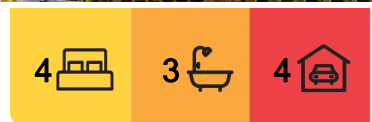

For Sale

All Encompassing Coastal Panorama

View

ljhooker.com.au/2VQ9F6K

Contact

Lachlan Elder

0418 224 180

elder@ljhmv.com.au

Rebecca James

0414 686 333

rjames@ljhmv.com.au

LJ Hooker Mona Vale
(02) 9979 8000

Ample proportions for entertaining both inside and out are complemented by spacious bedrooms and bathrooms. The lower level of the residence offers the versatility of autonomous living for in-laws, teens, guests, an au-pair for children or a home office. The spacious four-car garage also has room for a workshop and could provide undercover parking for a boat if required.

You will certainly appreciate the ease of access with ample guest parking and a sundrenched enclosed level backyard - rare for the location. Established gardens have been designed to enhance the coastal setting while requiring little maintenance.

From this prime position you can easily stroll to either Avalon or Bilgola Beaches as well as the fabulous cafe lifestyle of Avalon Village with its array of specialty stores and services.

Tightly held for more than three decades; your chance has finally arrived to secure one of the best positions on the northern beaches. We look forward to welcoming you to enjoy irreplaceable 'Headlands'.

Disclaimer:

All information contained herewith, including but not limited to the general property description, price and the address, is provided to LJ Hooker Mona Vale by third parties. We have obtained this information from sources we believe to be reliable; however, we cannot guarantee its accuracy. The information contained herewith should not be relied upon and you should make your own enquiries and seek advice in respect of this property or any property on this website.

More About this Property

| | |
|----------------------|--------------------|
| Property ID | 2VQ9F6K |
| Property Type | House |
| Land Area | 957 m ² |

Lachlan Elder 0418 224 180

Principal, Licensed Real Estate Agent | lelder@ljhmv.com.au

Rebecca James 0414 686 333

Licensed Real Estate Agent | rjames@ljhmv.com.au

LJ Hooker Mona Vale (02) 9979 8000

3/18 Bungan Street, MONA VALE NSW 2103

monavale.ljhooker.com.au | monavale@ljhmv.com.au



Disclaimer: All information contained therein is gathered from relevant third parties sources. We cannot guarantee or give any warranty about the information provided. Interested parties must rely solely on their own enquiries.

LJ Hooker Mona Vale
(02) 9979 8000

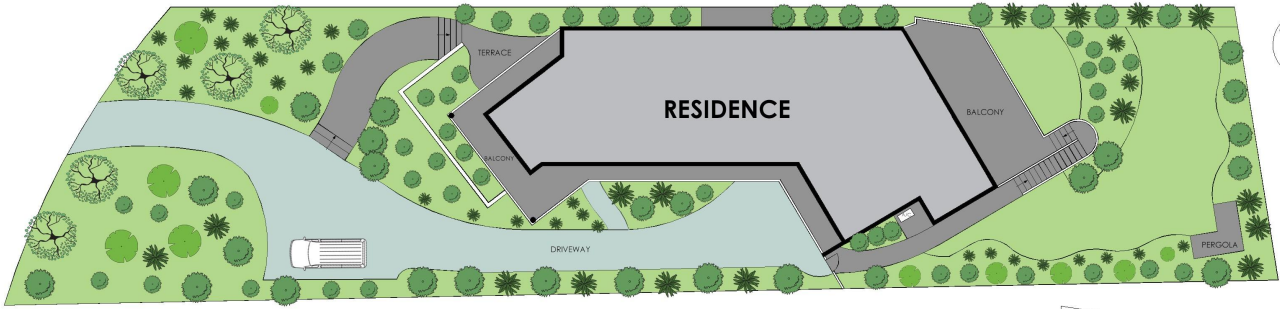

SITE PLAN
not to scale



All information contained herewith, including but not limited to the general property description is provided to LJ Hooker Mona Vale by third parties. We have obtained this information from sources we believe to be reliable; however, we cannot guarantee its accuracy. The information contained herewith should not be relied upon and you should make your own enquiries and seek advice in respect of this property.

LJ Hooker

63 THE SERPENTINE, BILGOLA BEACH

Scale 1:185