



52 Wentworth Street, Bellerive

## Prime location, perfect family sanctuary

Welcome Home to Your Versatile Family Oasis in Bellerive!

Are you searching for the perfect family home that combines stunning views, space, comfort, convenience and access to nature? Look no further! This contemporary home in the heart of Bellerive is ready to welcome your family with open arms.

### Key Features:

- Five Spacious Bedrooms: Plenty of room for everyone to have their own space!
- Two Well Positioned Bathrooms: No more morning rush hour! Enjoy the convenience of two well-appointed bathrooms.
- Expansive Deck: Perfect for family gatherings, BBQs, or simply soaking up the sun while enjoying breathtaking views of the river and mountain.
- Corner Allotment Land Area: 632 sqm of land means enough space for kids to play, pets to roam, or even a garden to cultivate. The corner position enables easy access both front and rear.
- Family-Friendly Layout: Multi-storey living, thoughtfully designed for comfortable living, with open-plan living areas that encourage togetherness, yet enough versatility to allow for separate spaces to

5 🏠 2 🚿 3 🚗

### FOR SALE

Please Call

### AGENTS

Simon Parsons

0438 296 830

[sparsons@ljhookerpinnacle.com](mailto:sparsons@ljhookerpinnacle.com)

Taya Parsons

0424 143 648

[tparsons@ljhookerpinnacle.com](mailto:tparsons@ljhookerpinnacle.com)

### AGENCY

LJ Hooker Pinnacle Property

(03) 6272 8177

All information contained therein is gathered from relevant third parties sources.

We cannot guarantee or give any warranty about the information provided.

Interested parties must rely solely on their own enquiries.



capture quiet time.

- Rumpus or Teenage Retreat: There is plenty of space under the house to let the teenagers spread out, or this area could be reconverted to a garage.

#### Why You'll Love It:

- Natural Light: Large windows throughout the home fill the space with warmth and brightness, creating a welcoming atmosphere.
- Outdoor Entertainment and Living: The deck is an entertainer's dream, providing a seamless transition from indoor to outdoor living.
- Community Vibe: Located in a friendly neighbourhood, you'll find parks, schools, and local shops just a stone's throw away.

#### Additional Perks:

- Low Maintenance Yard: Spend less time on upkeep and more time making memories with your loved ones.
- Versatile Spaces: Whether you need a home office, playroom, or guest room, this home can adapt to your family's needs.

This appealing Bellerive home is more than just a property; it's a place where family memories are made. Don't miss out on this incredible opportunity to create your dream family life!

Contact us today to schedule a viewing! Your new family adventure awaits!

The information contained herein has been supplied to us and we have no reason to doubt its accuracy, however, cannot guarantee it. Accordingly, all interested parties should make their own enquiries to verify this information.

## MORE DETAILS

Property ID	6XJ1F
Property Type	House
House Size	163 m2
Land Area	632 m2
Including	Toilets (2) Fire Place Courtyard Balcony Deck Dishwasher Outdoor Entertaining Floorboards Workshop Built-in-Robes

### Simon Parsons 0438 296 830

Owner | Managing Director | [sparsons@ljhookerpinnacle.com](mailto:sparsons@ljhookerpinnacle.com)

### Taya Parsons 0424 143 648

Owner | Business Coordinator | [tparsons@ljhookerpinnacle.com](mailto:tparsons@ljhookerpinnacle.com)

### LJ Hooker Pinnacle Property (03) 6272 8177

402 Main Road, GLENORCHY TAS 7010

[pinnacleproperty.ljhooker.com.au](http://pinnacleproperty.ljhooker.com.au) | [hello@ljhpinnacle.com.au](mailto:hello@ljhpinnacle.com.au)



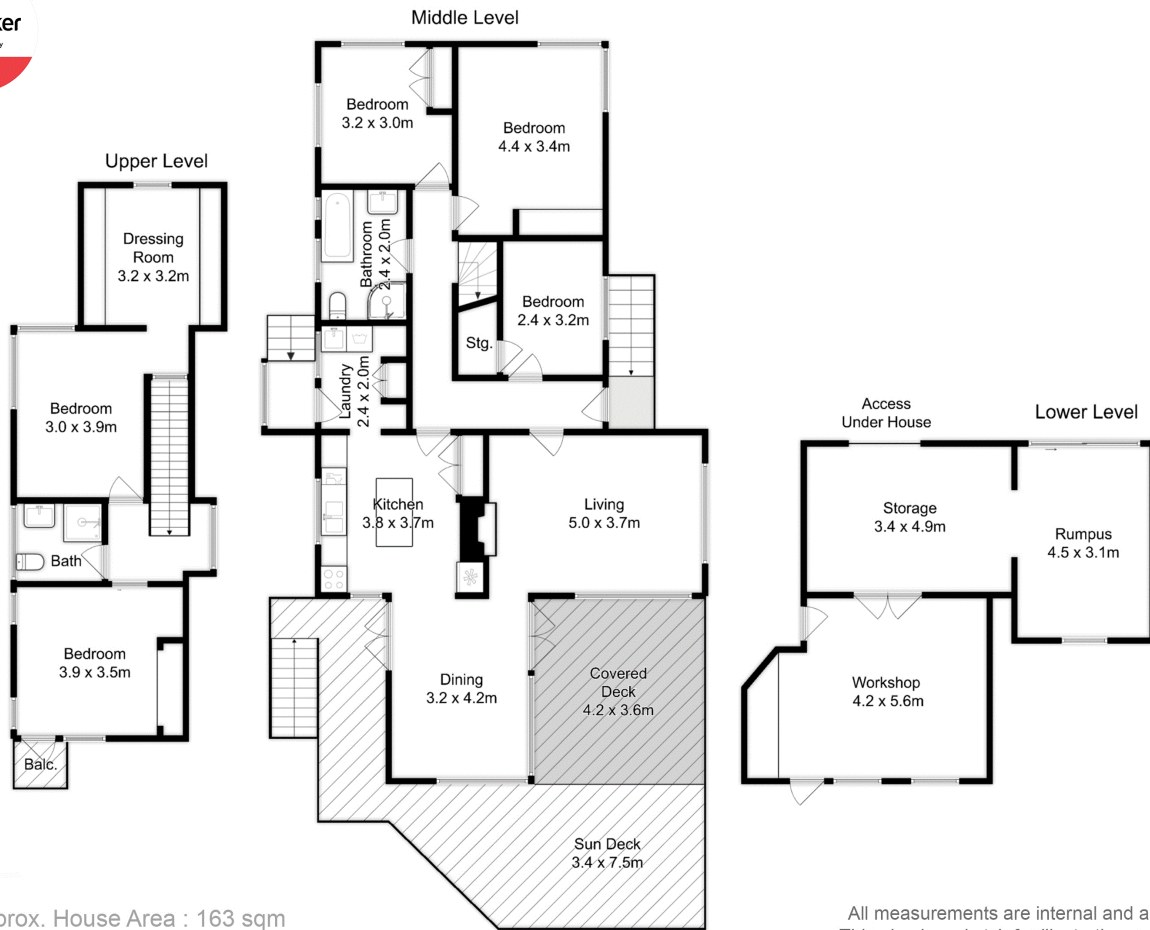

Total Approx. House Area : 163 sqm  
Total Approx. Lower Level Area : 54 sqm

All measurements are internal and approximate.  
This plan is a sketch for illustration, not valuation.  
Produced by Open2view.com