



## Bega, 13 Tathra Road

### LARGE HOME - ELEVATED POSITION

Presenting 13 Tathra Road, Bega, a charming property that offers just under a quarter of an acre of prime real estate. This large brick home features three spacious bedrooms, two bathrooms, and two comfortable living areas. Equipped with four reverse cycle air-conditioners, this home ensures year-round comfort. The property boasts a huge garage downstairs, perfect for storage or additional vehicles; there is also an undercover entertaining area which is perfect for those weekend BBQs. Situated in an elevated position, the home offers stunning views of the surrounding area. Its convenient location allows for a short walk to the town center and the hospital, making it an ideal choice for those seeking both convenience and tranquility.

3 

2 

2 

**For Sale**  
\$750,000

**View**  
[ljhooker.com.au/NEUFGN](http://ljhooker.com.au/NEUFGN)

**Contact**  
**Tim Shinnick**  
0466 475 131  
[tshinnick@ljhbega.com.au](mailto:tshinnick@ljhbega.com.au)



**LJ Hooker Bega**  
**(02) 6492 4300**

**Disclaimer:** All information contained therein is gathered from relevant third parties sources. We cannot guarantee or give any warranty about the information provided. Interested parties must rely solely on their own enquiries.



# More About this Property

Property ID	NEUFGN
Property Type	House
Land Area	980 m2

**Tim Shinnick 0466 475 131**  
Licenced Real Estate Agent | [tshinnick@ljhbega.com.au](mailto:tshinnick@ljhbega.com.au)

**LJ Hooker Bega (02) 6492 4300**  
225 Carp Street, BEGA NSW 2550  
[bega.ljhooker.com.au](http://bega.ljhooker.com.au) | [office@ljhbega.com.au](mailto:office@ljhbega.com.au)



**Disclaimer:** All information contained therein is gathered from relevant third parties sources.  
We cannot guarantee or give any warranty about the information provided. Interested parties must rely solely on their own enquiries.

**LJ Hooker Bega**  
**(02) 6492 4300**

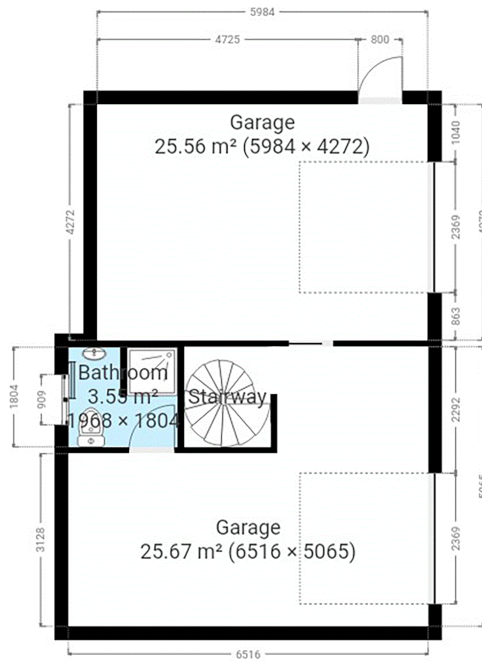

This plan is intended for marketing purposes only. All dimensions are approximate.

13 Tathra Road Bega