



Beerwah, 8 Peterlyn Court

Spectacular Family Home in the Heart of The Hinterland

Welcome to 8 Peterlyn Court, Beerwah, a spacious and well-designed family home nestled in a quiet and friendly estate. Set on a beautiful corner block, this property offers everything a growing family could desire, from large living spaces to impressive outdoor amenities.

Tucked away in a peaceful and hidden location, this home offers the best of both worlds. You'll enjoy the serenity of a quiet estate while still being conveniently close to everything. With easy access to Steve Irwin Way, you're just minutes from local shops, schools, and transport. Whether you're hosting unforgettable Christmas gatherings or entertaining year-round, this home has all the features to make every occasion special, including a large pool, spa, and plenty of room for family and friends.

Features include:

- Master Bedroom with massive walk-in robe and ensuite



Disclaimer: All information contained therein is gathered from relevant third parties sources. We cannot guarantee or give any warranty about the information provided. Interested parties must rely solely on their own enquiries.

4

2

5

For Sale
SOLD

View
ljhooker.com.au/CZJ0D

Contact
Jack Cornford
0484 241 803
jack.cornford@ljhooker.com.au

Ethan Ross
0406 963 705
ethan.ross@ljhooker.com.au

LJ Hooker Beerwah
(07) 5318 7277

- 3 additional bedrooms with fans and built ins
- Spacious entertaining space with open plan living
- Media room or formal dining area
- Gorgeous 2219m2 corner block
- Airconditioning split systems throughout
- Modern Kitchen with ample storage space
- 6m x 6m shed
- 9m x 5m Caravan shed
- Large pool with solar heating
- Large Solar Array
- External 4-person Spa
- 2 Outdoor entertainment areas
- Quiet Cul de sac
- Internal laundry with direct external access
- Built in Vacuum systems

Don't miss this rare opportunity to secure the perfect family home in a sought-after location. 8 Peterlyn Court offers space, privacy, and all the amenities needed for a comfortable lifestyle, making it an ideal choice for families who love to entertain and relax. With its quiet yet convenient position, this home is sure to impress.

Book your inspection today and experience everything this stunning property has to offer.

More About this Property

Property ID	CZJ0D
Property Type	House
Land Area	2219 m²
Including	Toilets (2)

Jack Cornford 0484 241 803
Principal | jack.cornford@ljhooker.com.au
Ethan Ross 0406 963 705
Sales Consultant | ethan.ross@ljhooker.com.au

LJ Hooker Beerwah (07) 5318 7277
4/22 Peachester Road, BEERWAH QLD 4519
Beerwah.ljhooker.com.au | beerwah@ljhooker.com.au



Disclaimer: All information contained therein is gathered from relevant third parties sources. We cannot guarantee or give any warranty about the information provided. Interested parties must rely solely on their own enquiries.

LJ Hooker Beerwah
(07) 5318 7277

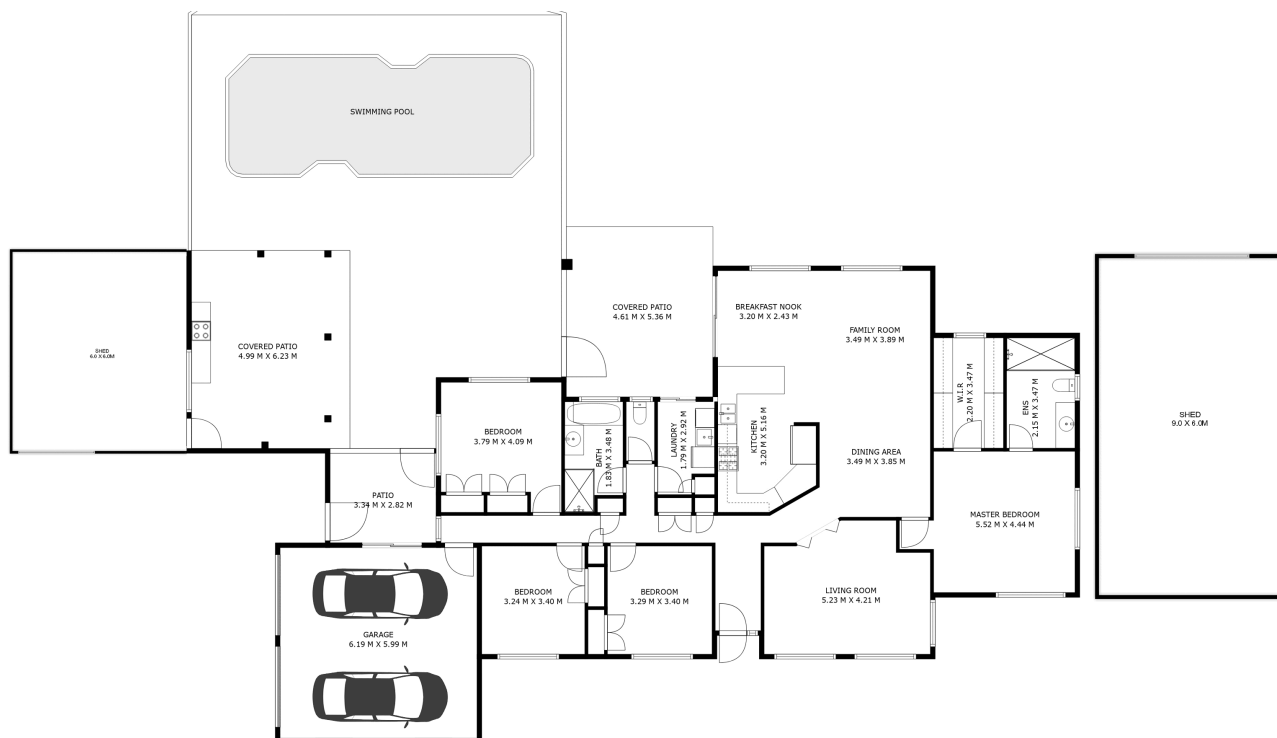

8 Peterlyn Court, Beerwah

Artist Impression ONLY. Every attempt to has been made too ensure the accuracy of this floor plan. All measurements are approximate and we take no responsibility for any error or mis-statement. This plan should only be used for real estate purposes for a prospective buyer. FLOOR PLAN BY ELITE MEDIA GROUP | elitemediasunshinecoast.com.au

Internal: 220 m2
External: 244 m2
Total: 264 m2