

Unit 4/35 Beatrice Street, Atherton

2  1  1 

Location | Low Maintenance | Great Starter

Units in prime location are hard to come by in Atherton. Enjoy the benefits of being within easy walking distance to the Main Street, with supermarkets, cafés, shops, parks, and schools all close by. In a complex that fosters a genuine sense of community, this is relaxed living with everything you need right at your doorstep.

Key Features:

- Two well-sized bedrooms with natural light
- Functional layout designed for easy living
- " maintenance property —ideal for busy lifestyles
- Affordable body corporate fees
- Quiet, community-focused complex
- Prime location within walking distance to Main Street
- Close to supermarkets, shops, parks, and schools
- Excellent option for investors, downsizers, or couples

Opportunities like this in such a central and convenient location are always in demand. With its combination of affordability, practicality, and position, this property is ready to deliver immediate lifestyle appeal or solid investment potential.

FOR SALE

Offers Over \$300,000

AGENTS

Alex Payne
0409 328 153
alex@ljhookerpropertyplus.com

AGENCY

LJ Hooker Atherton
(07) 4091 3144

All information contained therein is gathered from relevant third parties sources. We cannot guarantee or give any warranty about the information provided. Interested parties must rely solely on their own enquiries.



Contact exclusive agent Alex Payne today on 0409 328 153 for more information.

MORE DETAILS

Property ID	SPKF1S
Property Type	Unit
Land Area	78 m2
Including	Built-in-Robes Liveability

Alex Payne 0409 328 153

Property Sales Consultant | alex@ljhookerpropertyplus.com

LJ Hooker Atherton (07) 4091 3144

10 Main Street, ATHERTON QLD 4883

atherton.ljhooker.com.au | atherton@ljhatherton.com



All information contained therein is gathered from relevant third parties sources.
We cannot guarantee or give any warranty about the information provided.
Interested parties must rely solely on their own enquiries.



1st floor

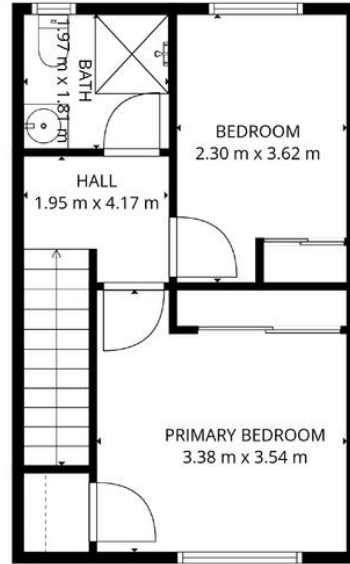

2nd floor

TOTAL: 64 m²
 1st floor: 32 m², 2nd floor: 32 m²
 EXCLUDED AREAS: PORCH: 4 m², COVERED PATIO: 8 m², WALLS: 7 m²

FLOOR PLAN CREATED BY CUBICASA APP. MEASUREMENTS DEEMED HIGHLY RELIABLE BUT NOT GUARANTEED.

