

Atherton, 1/6 Mabel Street

Lovely 2-Bedroom Townhouse in Prime Location - Ideal for Investors or First Homebuyers!

This centrally located townhouse offers incredible potential in a highly sought-after area of Atherton. Suitable for both investors and homeowners alike, featuring 2 spacious bedrooms with built ins, 1 bathroom, and a separate laundry, this property offers comfort and convenience. The open-plan living area is perfect for relaxing or entertaining.

Situated next to Big W and just around the corner from Main Street, everything you need is at your doorstep! Whether you're looking for a solid investment or a cozy place to call home, this townhouse is sure to impress.

Don't miss out on this fantastic opportunity!

For more details or to arrange an inspection, contact exclusive agent Nikki Cunningham today!



Disclaimer: All information contained therein is gathered from relevant third parties sources. We cannot guarantee or give any warranty about the information provided. Interested parties must rely solely on their own enquiries.



For Sale
Mid to High \$200,000's

View
ljhooker.com.au/RVXF1S

Contact
Nikki Cunningham
0403 467 816
nikki@ljhatherton.com

LJ Hooker Atherton
(07) 4091 3144

More About this Property

Property ID	RVXF1S
Property Type	Townhouse
House Size	78 m2
Land Area	43 m2
Including	Built-in-Robes

Nikki Cunningham 0403 467 816
Property Sales Consultant | nikki@ljhatherton.com

LJ Hooker Atherton (07) 4091 3144
10 Main Street, ATHERTON QLD 4883
atherton.ljhooker.com.au | atherton@ljhatherton.com



Disclaimer: All information contained therein is gathered from relevant third parties sources.
We cannot guarantee or give any warranty about the information provided. Interested parties must rely solely on their own enquiries.

LJ Hooker Atherton
(07) 4091 3144

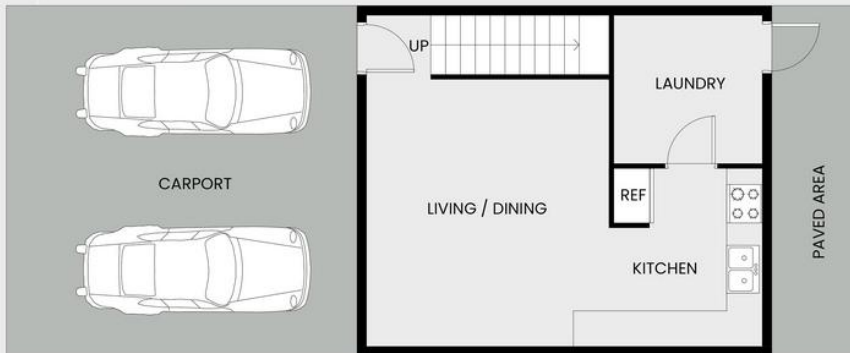

LJ Hooker Atherton
(07) 4091 3144

Disclaimer: All information contained therein is gathered from relevant third parties sources.
 We cannot guarantee or give any warranty about the information provided. Interested parties must rely solely on their own enquiries.