



Ashfield, 7 Somerville Avenue

Tucked Away Treasure with Land, Light & Lifestyle Perks

Peacefully positioned at the end of a quiet cul-de-sac, this solid full brick home offers an ideal blend of timeless charm, fresh upgrades, and everyday convenience. Set on a generous 459.4sqm block, it's a fantastic opportunity for first-home buyers, young couples or small families to enter the Inner West market with room to grow and space to enjoy.

With tasteful modern updates and original Deco character details, the interiors feel warm, practical, and instantly liveable. Whether you're working from the sunroom, relaxing by the fireplace or entertaining in the generous backyard, this is a home that delivers functionality and comfort with ease. Plus, with Ashfield Station, local schools, shops, and parks all nearby, it's a location that supports every stage of life.

-Solid full brick construction with classic Deco-style features including high ceilings and timber floors

-Newly renovated kitchen with sleek cabinetry, gas cooking and stainless steel appliances

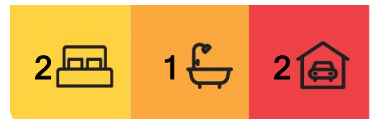

For Sale

For Sale | \$1,750,000 to \$1,850,000

View

Sat 13th Sep @ 1:00PM - 1:30PM

Contact

Adrian Abrook

0412 569 800

adrian@ljha.com.au



LJ Hooker Ashfield
(02) 9797 6044

Disclaimer: All information contained therein is gathered from relevant third parties sources. We cannot guarantee or give any warranty about the information provided. Interested parties must rely solely on their own enquiries.

- Generous living room with feature fireplace, air conditioning and loads of natural light
- Separate dining area ideal for family meals or casual entertaining
- Spacious backyard with level lawn, garden shed and plenty of room for kids or future landscaping
- Two well-sized bedrooms plus a sunroom - perfect as a home office or flexible third space
- Contemporary bathroom with floor-to-ceiling tiles and modern finishes
- Updated internal laundry with convenient rear access
- Quiet cul-de-sac setting with 2 car spaces
- Central Ashfield location just 800m to Ashfield Station and close to schools, shops and eateries

This is a move-in-ready home with the kind of yard and location that's increasingly hard to find in Ashfield. A smart first step, a comfortable family nest, or a ready-to-go investment - the choice is yours.

DISCLAIMER: This advertisement contains information provided by third parties. While all care is taken to ensure otherwise, LJ Hooker Ashfield does not make any representation as to the accuracy of the information contained in the advertisement, does not accept and responsibility or liability and recommends that any client make their own investigations and enquiries. All images are indicative of the property only.

More About this Property

Property ID	1A8BF8B
Property Type	House
Land Area	459.4 m2

Adrian Abrook 0412 569 800
Sales Manager | adrian@ljha.com.au

LJ Hooker Ashfield (02) 9797 6044
216 Liverpool Road, ASHFIELD NSW 2131
ashfield.ljhooker.com.au | ashfield@ljha.com.au



Disclaimer: All information contained therein is gathered from relevant third parties sources. We cannot guarantee or give any warranty about the information provided. Interested parties must rely solely on their own enquiries.

LJ Hooker Ashfield
(02) 9797 6044

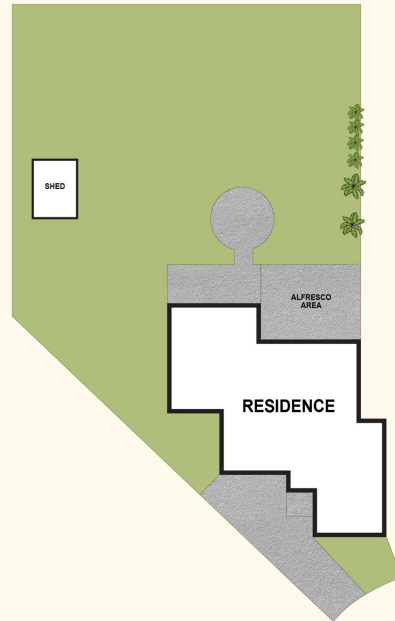

7 SOMERVILLE AVENUE, ASHFIELD

DISCLAIMER

PLANS SHOWN ARE FOR MARKETING PURPOSES ONLY, ALL DIMENSIONS ARE APPROXIMATE AND NOT TO SCALE. THEY ARE SUBJECT TO ERRORS AND INACCURACIES AND NO LIABILITY WILL BE ACCEPTED. INTERESTED PARTIES SHOULD MAKE THEIR OWN ENQUIRIES.