



## Ashfield, 6/18 Orpington Street

Hidden Gem in a Prime Location - Spacious, Stylish & Convenient!

Tucked away at the rear of a boutique complex of just 10, this elevated ground-floor one-bedroom apartment offers the perfect blend of space, privacy, and convenience.

Whether you're first-home buyer looking for a cozy haven or an investor seeking a prime opportunity, this charming unit ticks all the boxes!

- Elevated ground-floor position - easy access with added privacy
- Oversized bedroom & living area - bright, airy, and spacious
- Updated bathroom - thoughtfully updated
- Internal laundry - no shared facilities
- Quietly set at the back of the complex - peaceful and private
- Boutique block of only 10 units - exclusive and community-friendly
- Street Parking



**Disclaimer:** All information contained therein is gathered from relevant third parties sources. We cannot guarantee or give any warranty about the information provided. Interested parties must rely solely on their own enquiries.

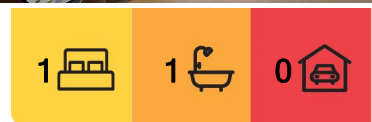

**For Sale**

For Sale - Contact Agent

**View**

[ljhooker.com.au/1A34F8B](http://ljhooker.com.au/1A34F8B)

**Contact**

**Domenic Bucciarelli**

0411 199 466

[domenic@ljha.com.au](mailto:domenic@ljha.com.au)

**Mo Yassih**

0473 172 464

[mo@ljha.com.au](mailto:mo@ljha.com.au)

**LJ Hooker Ashfield**  
(02) 9797 6044

- Walk to Ashfield Train Station, shops, cafés & restaurants - everything at your doorstep
- Moments to Ashfield Park - perfect for a morning walk or weekend relaxation

A fantastic choice for those seeking space, convenience, and a smart investment.

**DISCLAIMER:** This advertisement contains information provided by third parties. While all care is taken to ensure otherwise, LJ Hooker Ashfield does not make any representation as to the accuracy of the information contained in the advertisement, does not accept and responsibility or liability and recommends that any client make their own investigations and enquiries. All images are indicative of the property only.

## More About this Property

<b>Property ID</b>	1A34F8B
<b>Property Type</b>	Apartment

**Domenic Bucciarelli 0411 199 466**

Principal-Licensee in Charge | [domenic@ljha.com.au](mailto:domenic@ljha.com.au)

**Mo Yassih 0473 172 464**

Sales Associate | [mo@ljha.com.au](mailto:mo@ljha.com.au)

**LJ Hooker Ashfield (02) 9797 6044**

216 Liverpool Road, ASHFIELD NSW 2131

[ashfield.ljhooker.com.au](http://ashfield.ljhooker.com.au) | [ashfield@ljha.com.au](mailto:ashfield@ljha.com.au)



**Disclaimer:** All information contained therein is gathered from relevant third parties sources. We cannot guarantee or give any warranty about the information provided. Interested parties must rely solely on their own enquiries.

**LJ Hooker Ashfield  
(02) 9797 6044**

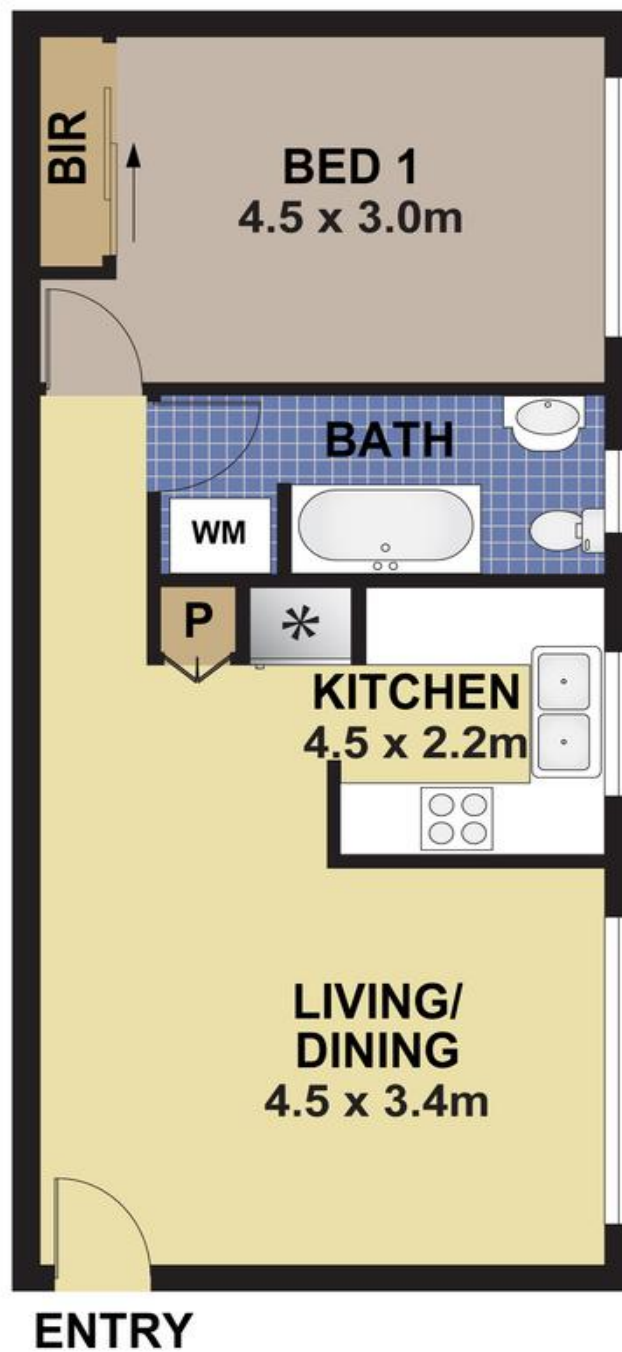

## 6/18 ORPINGTON STREET, ASHFIELD

### DISCLAIMER

PLANS SHOWN ARE FOR MARKETING PURPOSES ONLY. ALL DIMENSIONS ARE APPROXIMATE AND NOT TO SCALE. THEY ARE SUBJECT TO ERRORS AND INACCURACIES AND NO LIABILITY WILL BE ACCEPTED. INTERESTED PARTIES SHOULD MAKE THEIR OWN ENQUIRIES.



**LJ Hooker Ashfield**  
(02) 9797 6044

**Disclaimer:** All information contained therein is gathered from relevant third parties sources. We cannot guarantee or give any warranty about the information provided. Interested parties must rely solely on their own enquiries.